

60 Watts DAS60

Total Power: 60 Watts
Input Voltage: 90-264 VAC
of Outputs: Single



Special Features

- CE Mark EMC & LVD
- Universal AC input
- Fully regulated output
- Overload and short circuit protection
- Thermal protection
- Blue Angel compliance
- Constant voltage
- High efficiency
- High MTBF
- IEC320 AC receptacle, 3 pin (type C14)
- Built in EMI filter (CISPR 22 Class B)
- LED power good indicator

Environmental

Operating temperature: -5°C to +50°C ambient

Storage temperature: -40°C to +70°C

Electromagnetic susceptibility; design to meet EN61000-4,-2,-4,-5,-6,-11, level 3

Humidity: Operating; non-condensing; 10% to 90% RH

Vibration: Three orthogonal axes, sweep at 1 oct/min. 5 min. dwell at four major resonances 2G peak 8 Hz to 500 Hz, operational

MTBF demonstrated: >550,000 hours at full load and 25°C ambient conditions

Electrical Specs

Input

Input range 90 - 264 VAC (wide range)
Frequency 47 - 63 Hz
Inrush current 50A @ 230 VAC, cold start @ 25C
Input current 1.5A rms @ 90 VAC; 0.5A @ 264VAC
Efficiency >80% @ full load typical, @115VAC
EMI/RFI FCC Part 15, Subpart B Class B & EN55022 (CISPR 22) Class B

Safety ground leakage current 300µA max. @ 50/60 Hz, 230 VAC input

Output

Voltage (Vo) 48V
Voltage regulation ± 2% @ constant voltage mode
Maximum Power (Po) 60W
Hold-up time 20 ms. typical at full load @ 115VAC
Overvoltage protection 25% above nominal output maximum. Latching type, recycle AC to reset.
Overload protection Output short circuit protection auto recover. Overload protected @ 150% above maximum rating.
Overtemperature protection Auto recovery
Cable/connector DC cable with 2.5 mm center plug barrel type
DC plug center +v
DC plug outer -v

Safety

UL 60950
CUL 60950
NEMKO 60950
TUV 60950
CB Certificate and report
CE EMC & LVD

AMERICAS

5810 Van Allen Way
 Carlsbad, CA 92008
 Telephone: 760-930-4600
 Facsimile: 760-930-0698

EUROPE

Astec House, Waterfront Business Park
 Merry Hill, Dudley
 West Midlands, DY5 1LX, UK
 Telephone: 44 (1384) 842-211
 Facsimile: 44 (1384) 843-355

ASIA

Units 2111-2116, Level 21
 Tower1, Metroplaza
 223, Hing Fong Road
 Fwai Fong, New Territories
 Hong Kong
 Telephone: 852-2437-9662
 Facsimile: 852-2402-4426



Ordering Information

Model	Power Max	Vo	Regulation	Io max	Ripple
DAS60-480	60W	48V	±2%	1.25 A	480 mV

1. Peak-to-peak with 20 MHz bandwidth and 10 µF in parallel with a 0.1 µF capacitor.

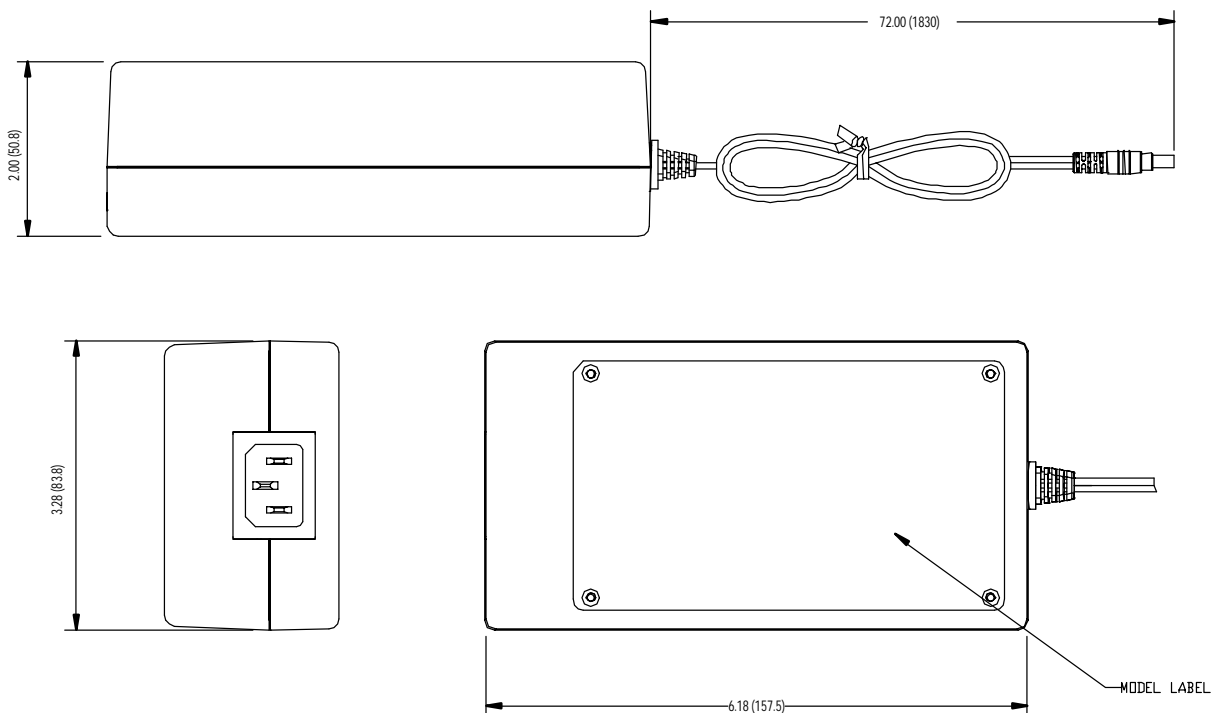

NOTES:

1. Specifications subject to change without notice.
2. All dimensions in inches (mm), tolerance is ± .02"
3. Warranty: 1 year
4. Weight: 1.06 lb./ .48 kg
5. AC input power cord sold separately.