

**VICOR CONFIDENTIAL**

THIS DOCUMENT AND THE DATA DISCLOSED HEREIN OR HERewith IS NOT TO BE REPRODUCED, USED, OR DISCLOSED IN WHOLE OR IN PART TO ANYONE WITHOUT PERMISSION OF VICOR CORP.

REV	DESCRIPTION	DATE	APPROVED
01	RELEASED- E020061	3/6/02	GCK

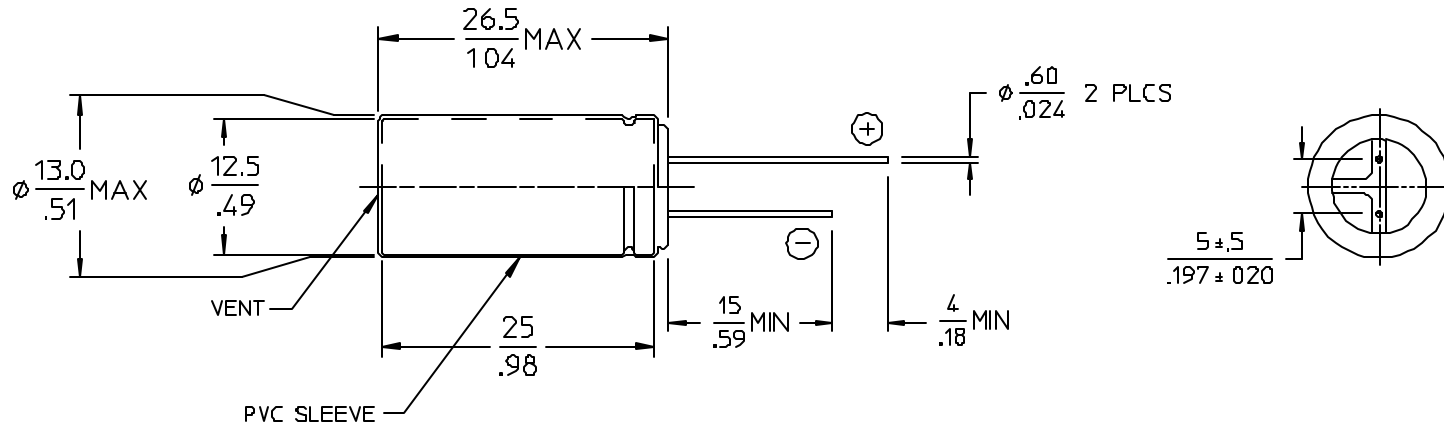

*ELECTRICAL CHARACTERISTICS @ T<sub>a</sub> = 20°C, 120Hz (UNLESS OTHERWISE SPECIFIED)*

PARAMETER	SYMBOL	MIN	MAX	UNITS	TEST CONDITIONS
CAPACITANCE	C	8.0	12.0	μF	0.5Vrms
WORKING VOLTAGE	V <sub>DCW</sub>	450		V <sub>DC</sub>	
SURGE VOLTAGE	V <sub>SURGE</sub>	500		V <sub>DC</sub>	
LEAKAGE CURRENT	I <sub>DCL</sub>		490	μA	1 MINUTE
DISSIPATION FACTOR	tan δ		.24		
IMPEDANCE	Z		2.6	Ω	100KHZ, +20 °C
RIPPLE CURRENT	I <sub>RIPPLE</sub>		250	mA	T <sub>a</sub> = 105°C, 100KHZ
OPERATING TEMPERATURE RANGE	T <sub>OP</sub>	-25	+105	°C	

- NOTES  
 1. MATERIAL: ALUMINUM ELECTROLYTIC.  
 2. DIMENSIONS ARE METRIC.  
INCH

*MAXIMUM PERMISSIBLE RIPPLE CURRENT*

*FREQUENCY MULTIPLIER*

FREQUENCY IN Hz			
120	1K	10K	100K
0.35	0.66	0.89	1.00

*TEMPERATURE MULTIPLIER*

TEMPERATURE	85°C	105°C
MULTIPLIER	1.73	1.00

DRAWN BY <i>D.P. KELLY</i>	DATE 01/02
-------------------------------	---------------

UNLESS OTHERWISE SPECIFIED  
 DIMENSIONS ARE IN INCHES  
 TOLERANCES ARE  
 FRACTIONS DECIMALS ANGLES  
 +1/64 .XX- +.01 .1°  
 .XXX- .005

THIRD ANGLE PROJECTION 	DD NOT SCALE DRAWING
----------------------------	----------------------



**CAPACITOR, ALAL, RADIAL,  
 10μF, ±20%, 450V**

SIZE B	FSCM NO. 67131	DWG NO 13469	REV 01
SCALE 2X	SHEET 1 OF 1		