

THIS DOCUMENT AND THE DATA DISCLOSED
HEREIN OR HEREWITH IS NOT TO BE REPRODUCED,
USED, OR DISCLOSED IN WHOLE OR IN PART
TO ANYONE WITHOUT PERMISSION OF VICOR CORP.

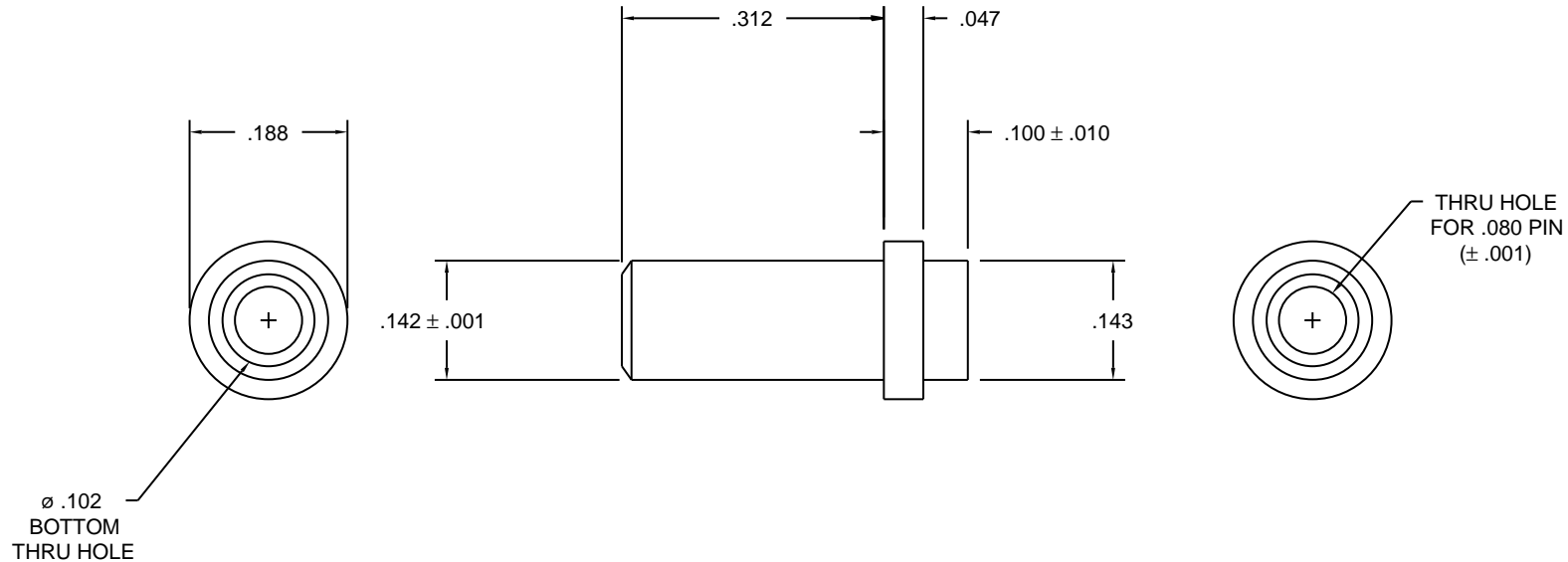

NOTES:

1. MATERIAL: BRASS QQ-B-626 ALLOY 360 1/2 HARD.
ELECTRO-TIN PER MIL-T-10727, TYPE I
BERYLLIUM COPPER SPRING INSERT
CAPTIVATED.
2. CONCORD P/N 09-9044-1-004 OR APPROVED
EQUIVALENT.



DRAWN:		$\phi .080$ P.C. PIN SOCKET	
CHECKED:			
APPD:			
ALL DIMENSIONS ARE IN INCHES (MILLIMETERS) DO NOT SCALE DRAWING	TOLERANCES (EXCEPT AS NOTED)	DRAWING NO.	REV.
	.XX $\pm .01$.XXX $\pm .005$ FRACT $\pm 1/64$ ANGLES $\pm 1'0$	01828	2
NEXT ASSY:	SCALE: 4X	SHEET _____ OF _____	