



39x30x17.5

JMX-94F



CH0054070—2000

Features

- Magnet latching relay.
- Small size, light weight.
- High sensitivity & reliability.
- Well anti-shock and anti-vibration.
- Heavy contact load.

Ordering Information

JMX-94F **A** **Z** **60** **DC12V**

1 2 3 4 5

1 Part number: JMX-94F

2 Contact arrangement: A:1A; B:1B

3 Enclosure: S: Sealed type; Z: Dust cover

4 Contact Current: 40:40A; 60:60A; 80:80A

5 Coil rated Voltage(V): DC: 9,12, 24

Contact Data

Contact Arrangement	1A (SPSTNO), 1B (SPSTNC)		
Contact Material	Ag-Cd O		
Contact Rating(resistive)	80A/250VAC	60A/250VAC	40A/250VAC
Max. Switching Power	20000VA	15000VA	10000VA
Max. Switching Voltage	300VAC		
Contact Resistance & Voltage drop	≤50mΩ (at 1A/24VDC)	Max. Switching Current:80A	
	<100mV (at rated load)	Item 3.12 of IEC255-7	
Operation life	Electrical	10 ⁴	Item 3.30 of IEC255-7
	(Rated load)		
	Mechanical	10 ⁶	Item 3.31 of IEC255-7
	(No load)		

Coil Parameter

DASH NUMBERS	COIL RATED VOLTAGE VDC	COIL RESISTANCE Ω±10%	SWITCHING VOLTAGE VDC (50%-70% of rated voltage)	PULSE MAGNITUDE ms	COIL POWER consumption W	Operate Time ms	Reset Time ms
009-1000	9	81	4.5~6.3				
012-1000	12	144	6.0~8.4	≥60	1	≤20	≤20
024-1000	24	576	12.0~16.8				

CAUTION: 1.When latching relays are installed in equipment, the latch and reset coil should not be pulsed simultaneously. coil should not be pulsed with less than the nominal coil voltage and pulse width should be a minimum of three times the specified operate time of the relay. If these conditions are not followed, it is possible for the relay to be in the magnetically neutral position .

2.Switching voltage is for test purpose only and are no to be used as design criteria.

Operation condition

Insulation Resistance	1000M Ω min (at 500VDC)	Item 7 of IEC255-5
Dielectric Strength		
Between contacts	50Hz 1500V	Item 6 of IEC255-5
Between contact and coil	50Hz 4000V	Item 6 of IEC255-5
Creepage distance	8.4mm	Addenda B of IEC255-5
Shock resistance	Functional 100m/s ² ; Survival: 1000 m/s ² 11ms	IEC68-2-27 Test Ea
Vibration resistance	10~55Hz Double amplitude 1.5mm	IEC68-2-6 Test Fc
Terminals strength	5N	IEC68-2-21 Test Ua1
Solderability	235 $^{\circ}$ C \pm 2 $^{\circ}$ C 3 \pm 0.5s	IEC68-2-20 Test Ta method 1
Ambient Temperature	-25~70 $^{\circ}$ C	
Relative Humidity	85% (at 40 $^{\circ}$ C)	IEC68-2-3Test Ca
Mass	33g	

Qualification inspection:

Perform the qualification test as specified in the table IV of IEC255-19-1 and minimum sample size 24.

Safety approvals

Safety approval	CCEE
Load	80A/220VAC

Dimensions (Unit: mm)

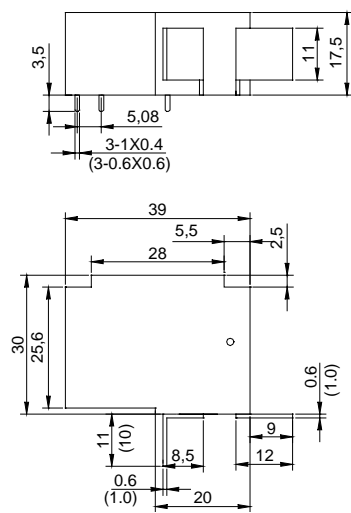

Dimensions

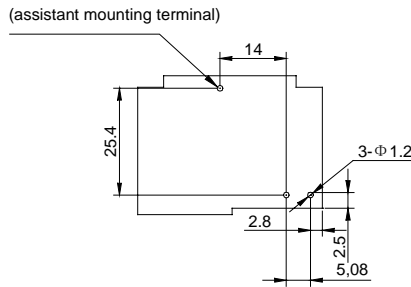

Mounting (Bottom views)

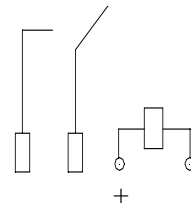

Wiring diagram

mm	inch
0.4	0.016
0.6	0.024
1.0	0.039
1.2	0.047
2.5	0.098
2.8	0.110
3.5	0.138
5.08	0.200
5.5	0.217
8.5	0.335
9	0.354
10	0.394
11	0.433
12	0.472
14	0.551
17.5	0.689
20	0.787
25.4	1.000
25.6	1.008
28	1.102
30	1.181
39	1.535

- NOTES 1).Dimensions are in millimeter.
2).Inch equivalents are given for general information only.
3).Relays shall have plus(+) signs placed on the circuit diagram as shown.

Reference Data

