

## 59210 Lever Arm Sensor Features and Benefits



59210 Sensor

### Features

- Clip mounting frame
- Shrouded terminal accepts Molex SL terminal or equivalent
- Low operating force
- Variety of arm configurations available (contact Hamlin)

### Benefits

- No standby power requirement
- Hermetically sealed, magnetically operated contacts continue to operate long after optical and other technologies fail due to contamination

### Applications

- Paper path sensing
- Security system switching

## DIMENSIONS (in) mm

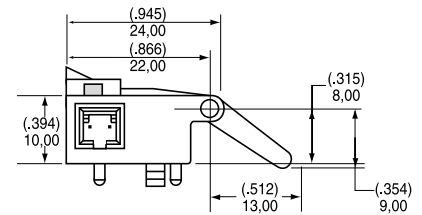
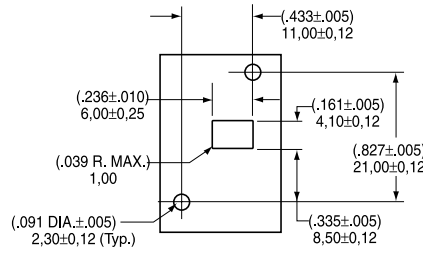
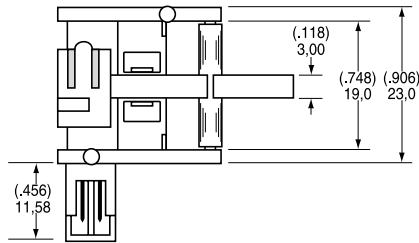

BOARD MOUNTING DIMENSIONS  
MATERIAL (.063±.008 THICK)  
1,6±0,21

## CUSTOMER OPTIONS - Switching Specifications

| TABLE 1      |                  |             | Normally Closed  |
|--------------|------------------|-------------|------------------|
| Contact Type |                  |             |                  |
| Switch Type  |                  |             | 4                |
| Voltage      | Power            | Watt - max. | 10               |
|              | Switching        | Vdc - max.  | 200              |
| Current      | Breakdown        | Vdc - min.  | 250              |
|              | Switching        | A - max.    | 0.5              |
| Resistance   | Carry            | A - max.    | 1.2              |
|              | Contact, Initial | Ω - max.    | 0.2              |
| Capacitance  | Insulation       | Ω - min.    | 10 <sup>10</sup> |
|              | Contact          | pF - typ.   | 0.3              |
| Temperature  | Operating        | °C          | -40 to +105      |
|              | Storage          | °C          | -65 to +105      |
| Time         | Operate          | ms - max.   | 1.0              |
|              | Release          | ms - max.   | 1.0              |
| Shock        | 11ms 1/2 sine    | G - max.    | 100              |
| Vibration    | 50-2000 Hz       | G - max.    | 30               |

### ACTIVATION

| Must Actuate | Must Release |
|--------------|--------------|
| <15°         | >2°          |

## ORDERING INFORMATION

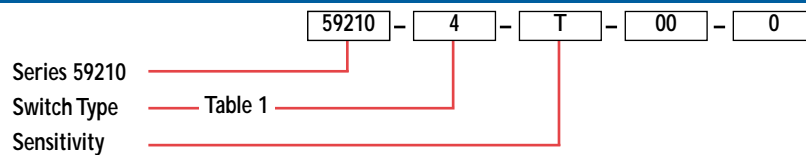

Notes 1) 59210 is normally closed when the spring loaded arm is at rest. Actuate and release points refer to arm rotation from the rest position.

2) Connectors match Molex® SL connector or equivalent. Purchase housing and pins from connector supplier. Assembly required.

Hamlin USA Tel: +1 920 648 3000 • Fax: +1 920 648 3001 • Email: sales.us@hamlin.com  
 Hamlin UK Tel: +44 (0)1379 649700 • Fax: +44 (0)1379 649702 • Email: sales.uk@hamlin.com  
 Hamlin Germany Tel: +49 (0) 6181 953660 • Fax: +49 (0) 6181 953666 • Email: sales.de@hamlin.com  
 Hamletrol France Tel: +33 (0) 1 4687 0202 • Fax: +33 (0) 1 4686 6786 • Email: sales.fr@hamlin.com

ISSUE No: 4 DATE: 1/5/3

DETAILS PROVIDED ON THIS DATA SHEET ARE PROVIDED FOR INFORMATION PURPOSES ONLY AND SHOULD NOT BE RELIED UPON AS BEING ACCURATE FOR ANY PARTICULAR PURPOSE. Product performance may be affected by the application to which the product is put. Upon request, HAMLIN will assist purchasers by providing information specific to any particular application. HAMLIN disclaims any and all liability whatsoever for any purchaser's reliance upon the information contained on this data sheet without further consultation with authorised representatives of HAMLIN.