

E14

D - SUB CRIMP HOUSING



POSITION	A	B	C	D
9F	16.30	25.00	30.8	19.2
15F	24.60	33.30	39.2	27.7
25F	38.30	47.10	53.1	41.1
37F	54.80	63.50	69.4	57.3

POSITION	A	B	C	D
9M	16.92	25.00	30.8	19.2
15M	25.25	33.30	39.2	27.7
25M	38.96	47.10	53.1	41.1
37M	55.42	63.50	69.4	57.3

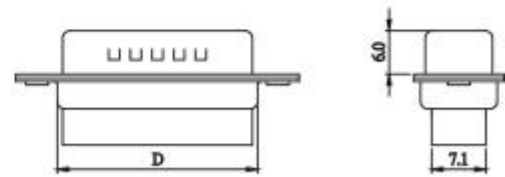
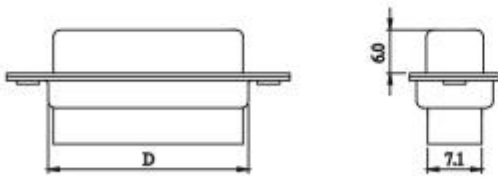
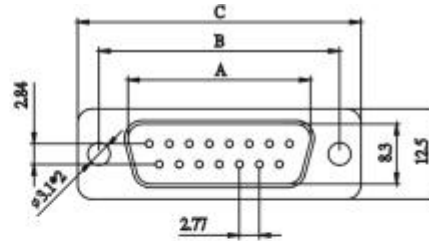
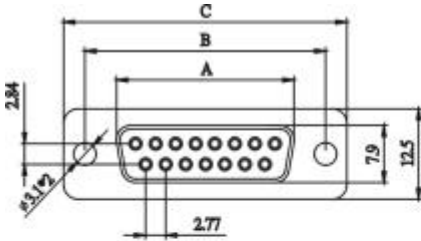

FEMALE

MALE

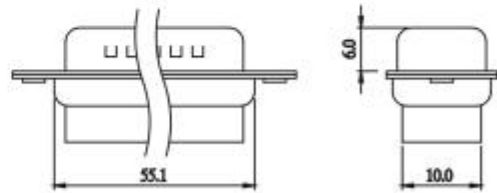
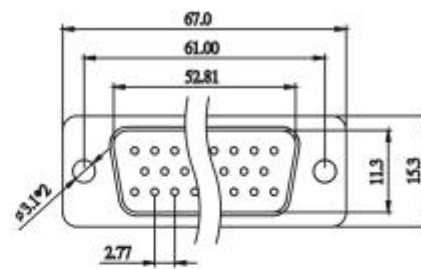
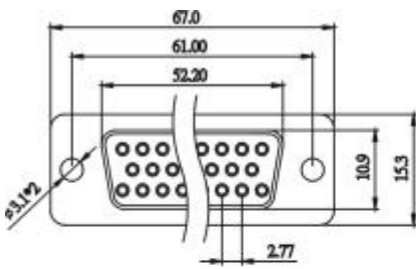

50 POSITION FEMALE

50 POSITION MALE

PROCESS OPTION

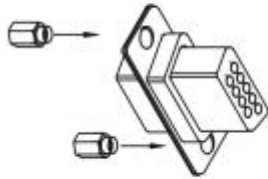

FRONT RIVET

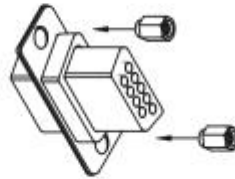

REAR RIVET

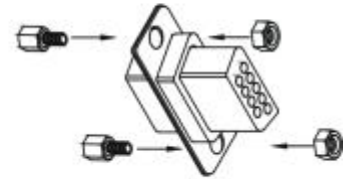

HEX SCREW + HEX NUT

HOW TO ORDER:

E14 - 1 - 2 - 3 - 4 - 5 - 6

1.NO. OF CONTACT	2.CONTACT TYPE	3.SHELL PLATING	
09 15 25 37 50	M: MALE F: FEMALE	T: TIN N: NICKEL P: TIN + DIMPLE Q: NICKEL + DIMPLE Z: ZINC (CHROMATIC)	
4.MOUNTING METHOD		5.ACCESSORIES	6. INSULATOR COLOR
A: THROUGH HOLE B: HEX SCREW + HEX NUT C: 3.8mm OPEN HEX RIVET D: 5.8mm OPEN HEX RIVET E: 4.8mm CLOSE HEX RIVET F: 5.8mm CLOSE HEX RIVET G: 5.8mm CLOSE ROUND RIVET H: 7.1mm ROUND THREAD RIVET		I: 5.8mm BOARDLOCK RIVET J: 10mm BOARDLOCK RIVET K: 2.5mm OPEN HEX RIVET	A: NON ACCESSORIES B: FRONT RIVET C: FRONT RIVET ADD SCREW D: FRONT RIVET FIX SCREW E: REAR RIVET F: REAR RIVET ADD SCREW G: REAR RIVET FIX SCREW
			1. BLACK