

HP - 2FR4

The HP - 2FR4 is a high - speed silicon photodiode mounted in a sidelooking plastic package with daylight filter (IR - 88). The lensed package permits high - output.

FEATURES

- High - output power for IRED
- High - speed response
- Lensed package
- Black plastic package for daylight filter
- Long leads (32mm)

APPLICATIONS

- Remote control sensors
- Optical switches

DIMENSIONS

(Unit : mm)

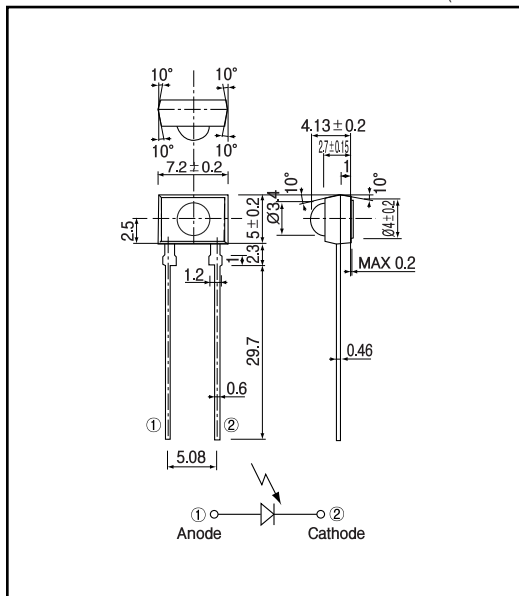

MAXIMUM RATINGS

(Ta=25)

Item	Symbol	Rating	Unit
Reverse voltage	V _R	35	V
Power dissipation	P _d	150	mW
Operating temp.	T _{opr.}	- 30 ~ + 70	
Storage temp.	T _{stg.}	- 40 ~ + 80	
Soldering temp. *1	T _{sol.}	260	

*1. For MAX.5 seconds at the position of 2 mm from the package

ELECTRO-OPTICAL CHARACTERISTICS

(Ta=25)

Item	Symbol	Conditions	Min.	Typ.	Max.	Unit.
Open circuit voltage	V _{oc}	E _v = 1,000lx *2		0.38		V
Short circuit current	I _{sc}		20	34		μA
Dark current	I _d	V _R = 10V			10	nA
Curve factor	C.F.		0.55			-
Capacitance	C _t	V = 0V, f = 1MHz		73		pF
Temperature coefficient of V _{oc}	t			- 2.2		mV/
Temperature coefficient of I _{sc}	t			0.18		%/
Spectral sensitivity				880 ~ 1,050		nm
Peak wavelength	p			940		nm
Half angle				± 60		deg.

*2. Color temp. = 2856K standard Tungsten lamp

Photo diodes

HP - 2FR4

Light current Vs. Forward voltage

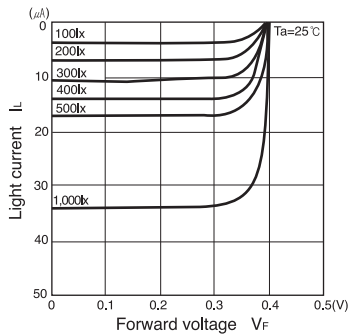

Short circuit current Vs. Illuminance

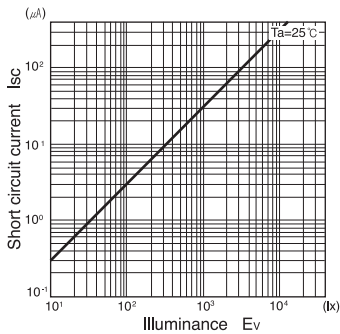

Dark current Vs. Ambient temperature

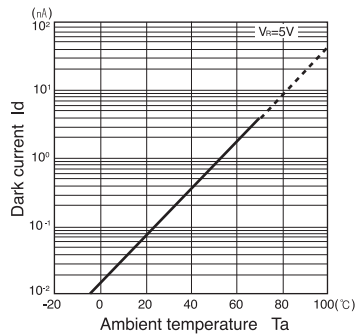

Relative sensitivity Vs. Wavelength

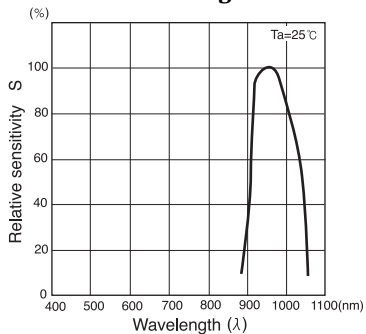

Dark current Vs. Reverse voltage

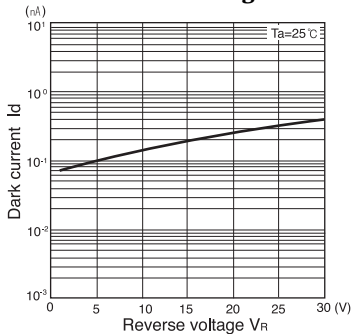

Radiant Pattern

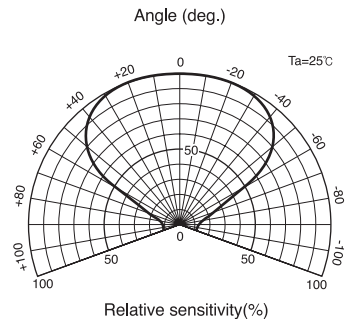

Capacitance between terminals Vs. Reverse voltage

