

**Surface Mount Power Inductors****L032 Series****FEATURES**

- Will Handle up to 2.20A
- Economical Design
- Suitable for Pick and Place Applications
- Withstands Solder Reflow

PACKAGING

- Reel Diameter: 7"
- Reel Width: 8mm
- Pieces Per Reel: 2000

APPLICATIONS

- Handheld and PDA Applications
- DC/DC Converters
- SMPS Applications
- Battery Powered or Low Voltage Applications

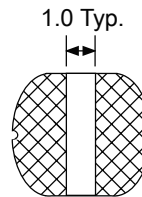
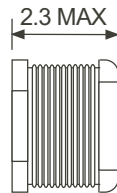
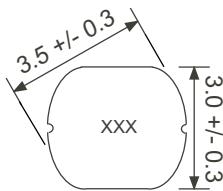
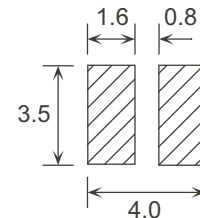
**Mechanical****Recommend PCB Layout**

unit:mm

Electrical Specifications

| Part Number | Inductance ¹ ($\mu\text{H} \pm 20\%$) | DCR max (Ω) | I_{dc} max ² (A) |
|-------------|---|-------------------------|----------------------------------|
| L032-1R0-RM | 1.0 | 0.045 | 2.20 |
| L032-1R2-RM | 1.2 | 0.050 | 2.10 |
| L032-1R5-RM | 1.5 | 0.055 | 1.70 |
| L032-1R8-RM | 1.8 | 0.070 | 1.65 |
| L032-2R2-RM | 2.2 | 0.085 | 1.60 |
| L032-2R7-RM | 2.7 | 0.100 | 1.40 |
| L032-3R3-RM | 3.3 | 0.120 | 1.05 |
| L032-3R9-RM | 3.9 | 0.125 | 1.00 |
| L032-4R7-RM | 4.7 | 0.135 | 1.00 |
| L032-5R6-RM | 5.6 | 0.145 | 0.95 |
| L032-6R8-RM | 6.8 | 0.200 | 0.95 |
| L032-8R2-RM | 8.2 | 0.250 | 0.92 |
| L032-100-RM | 10 | 0.320 | 0.90 |
| L032-120-RM | 12 | 0.350 | 0.85 |
| L032-150-RM | 15 | 0.460 | 0.75 |
| L032-180-RM | 18 | 0.520 | 0.70 |
| L032-220-RM | 22 | 0.650 | 0.60 |
| L032-270-RM | 27 | 0.750 | 0.55 |
| L032-330-RM | 33 | 0.920 | 0.50 |
| L032-390-RM | 39 | 1.00 | 0.48 |
| L032-470-RM | 47 | 1.15 | 0.45 |
| L032-560-RM | 56 | 1.50 | 0.30 |
| L032-680-RM | 68 | 2.00 | 0.26 |
| L032-820-RM | 82 | 2.15 | 0.23 |
| L032-101-RM | 100 | 2.50 | 0.20 |
| L032-121-RM | 120 | 3.40 | 0.18 |
| L032-151-RM | 150 | 4.20 | 0.16 |
| L032-181-RM | 180 | 4.50 | 0.15 |
| L032-221-RM | 220 | 5.10 | 0.14 |
| L032-271-RM | 270 | 8.50 | 0.10 |
| L032-331-RM | 330 | 9.50 | 0.09 |

1. Tested @ 100kHz, 0.1Vrms.
2. Inductance drops 10% at rated I_{dc} .
3. Electrical specifications at 25°C.
4. Operating temperature range: -40°C to +85°C.
5. Meets UL 94V-0.