

LP6-TPP1-01

Applications

Indoor and Outdoor Displays
 Backlighting
 Camera Flash
 RGB Full Color Displays

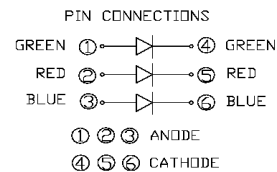
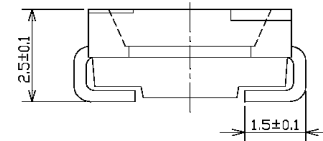
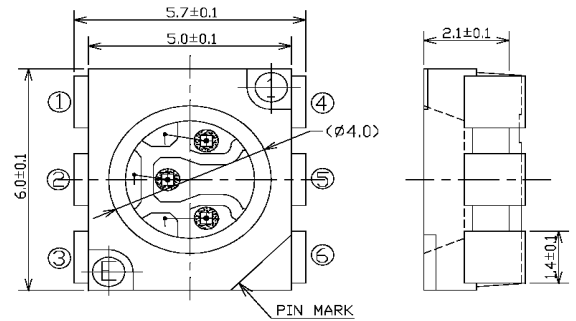

Unit: mm

Maximum Ratings (Ta=25°C)

Characteristic	Symbol	Max.			Unit
		RD	UBPG	BLU	
Forward Current	I _F	80	80	80	mA
Reverse Voltage	V _R	5	5	5	V
Power Dissipation	P _d	260.00	410.00	410.00	mW
Operating Temperature	T _{opr}	-40 ~ +100	-40 ~ +100	-40 ~ +100	°C
Storage Temperature	T _{stg}	-40 ~ +100	-40 ~ +100	-40 ~ +100	°C
Soldering Temperature	T _{sol}	260	260	260	°C
Soldering Time	-	for 3 sec. max	for 3 sec. max	for 3 sec. max	-

Opto-Electrical Characteristics (Ta=25°C)

Characteristic	Symbol	Test Condition	Min			Typ			Max			Unit
			RD	UBPG	BLU	RD	UBPG	BLU	RD	UBPG	BLU	
Forward Voltage	V _F	I _F =50mA	-	-	-	2.60	4.50	4.50	3.20	5.10	5.10	V
Reverse Current	I _R	V _R =5V	-	-	-	-	-	-	10	10	10	μA
Luminous Intensity	I _v	I _F =50mA	710.00	710.00	180.00	1000.00	900.00	280.00	-	-	-	mcd
Viewing Angle	2θ ^{1/2}	-	-	-	-	120°	120°	120°	-	-	-	deg.
Peak Wavelength	λ _p	I _F =50mA	-	-	-	615	520	468	-	-	-	nm
Dominant Wavelength	λ _d	I _F =50mA	-	-	-	610	525	470	-	-	-	nm
Spectral Line Half Width	Δλ	I _F =50mA	-	-	-	23	38	26	-	-	-	nm

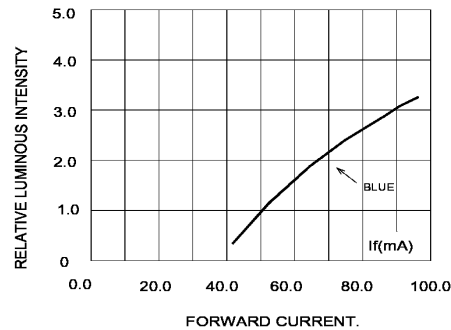
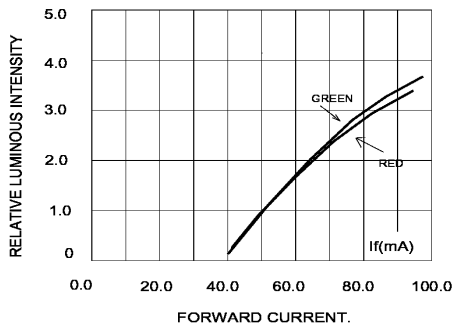
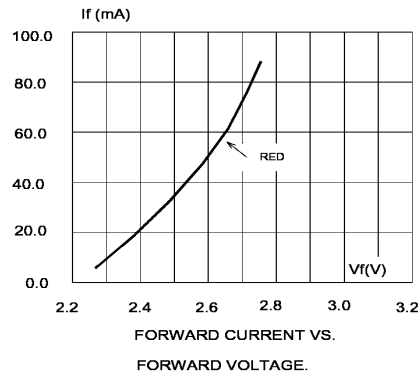
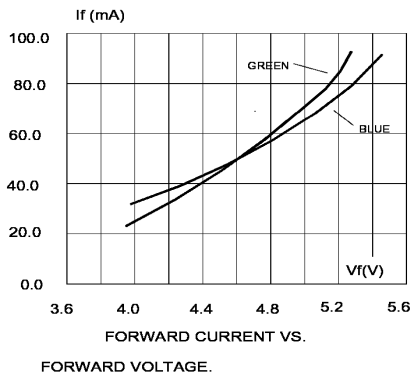
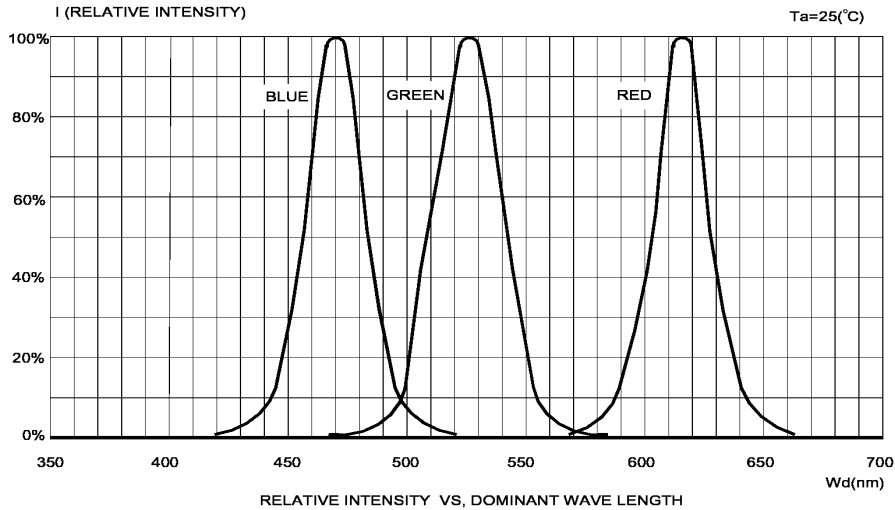

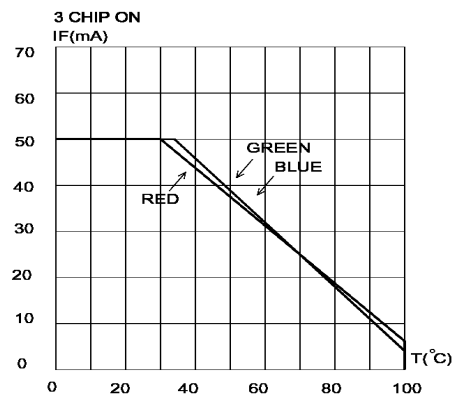
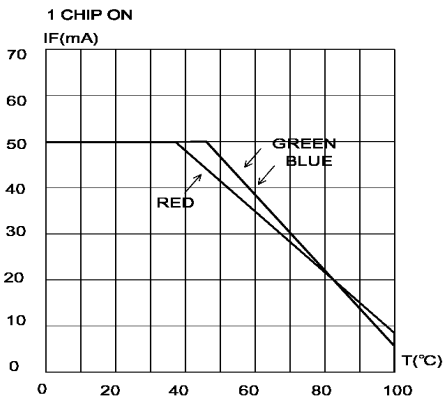
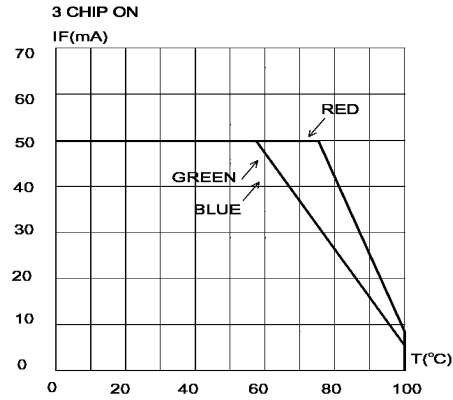
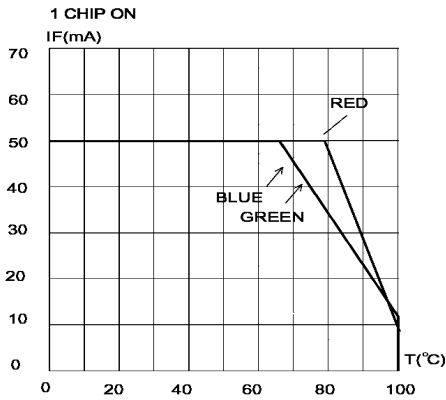
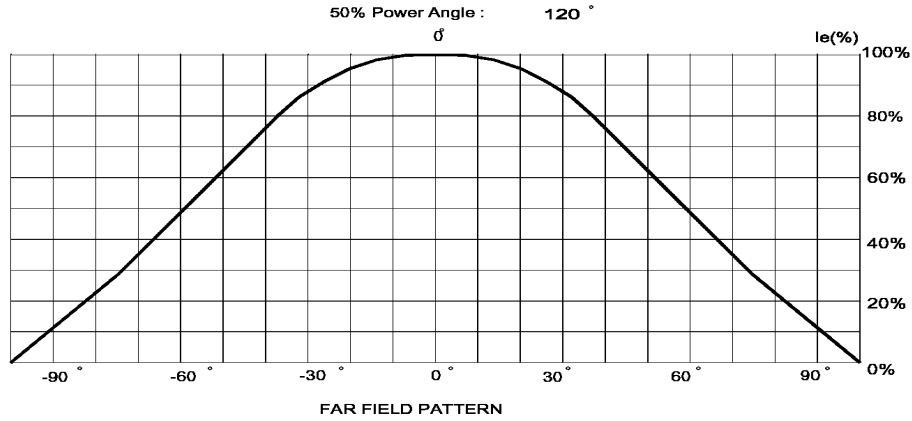

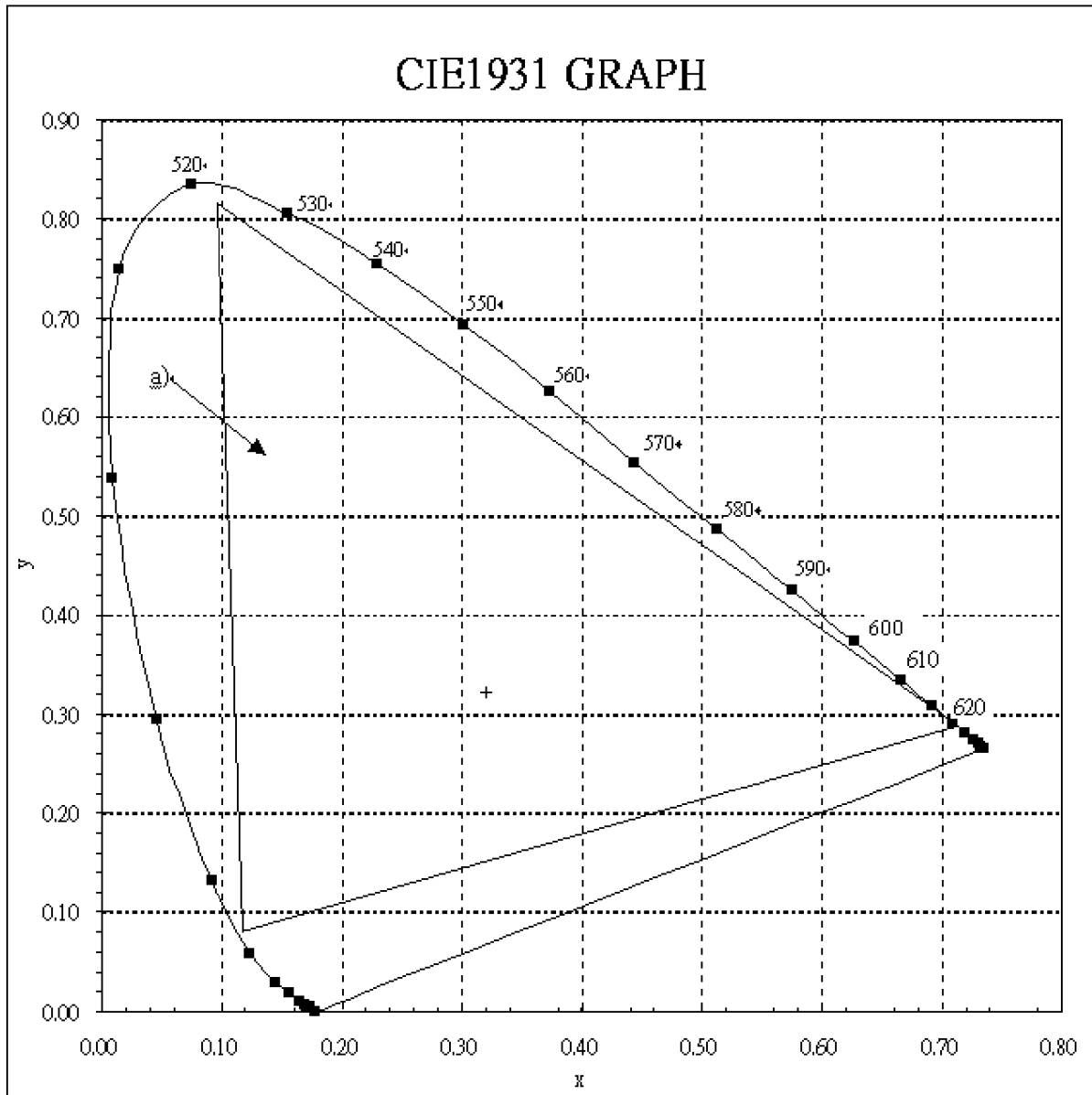

the color coordinates of the mixed light can be expected within the area of the color triangle marked a).

the achromatic point (x=0.33,y=0.33) is marked“+”