



- Power Rating from to 1000A
- High Stability
- Low Inductivity
- Low Temperature Coefficient

SPECIFICATIONS

ELECTRICAL	rated current	resistor value (at 50 mV nominal output)	P _{max}
FHR 2/4-120120	1000 A	50 μΩ	50 W
FHR 2/4-128120	750 A	67 μΩ	38 W
FHR 2/4-7580	600 A	83 μΩ	30 W
FHR 2/4-8080	500 A	100 μΩ	25 W
FHR 2/4-7050	300 A	167 μΩ	15 W
FHR 2/4-7750	250 A	200 μΩ	13 W
FHR 2/4-10050	150 A	333 μΩ	8 W
FHR 2/4-6520	100 A	500 μΩ	5 W
FHR 2/4-10020	50 A	1000 μΩ	3 W

(other rated currents and nominal outputs upon request possible)

Tolerances	:	1%, 2%, 5% (other Tolerances upon request)
Temperature Coefficient	:	±15 ppm/K (20°C ... 60°C, only 4-pin type)
Thermal EMF	:	< 1 μV/K

ENVIRONMENTAL

Operating Temperature Range : -40°C ... 130°C

MECHANICAL

Resistor Material	:	Metalplate CuNiMn (DIN 17471)
Connector Material	:	Cu, upon request nickelized 2-pin, 4-pin

TEMPERATURE COEFFICIENT

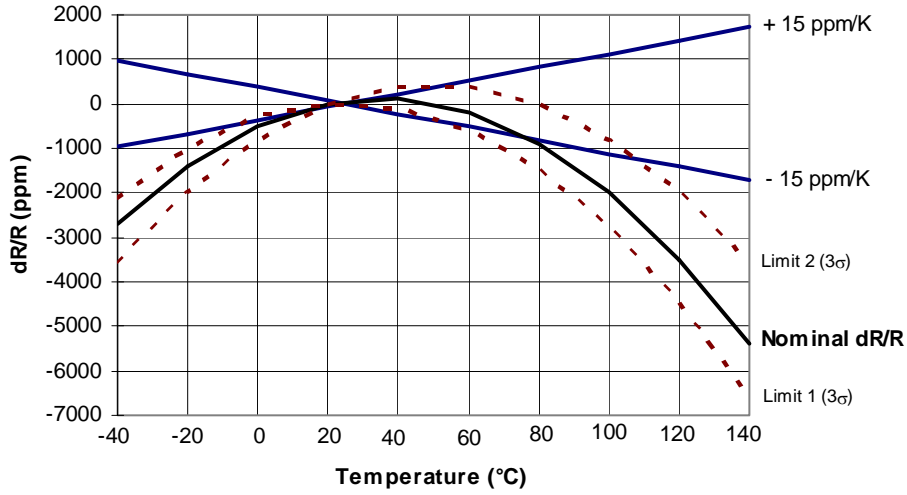

DERATING CURVE

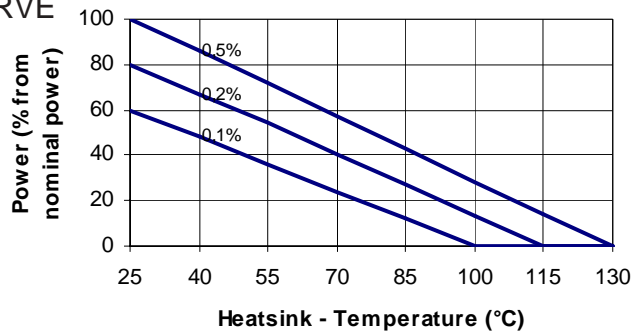

CONSTRUCTION

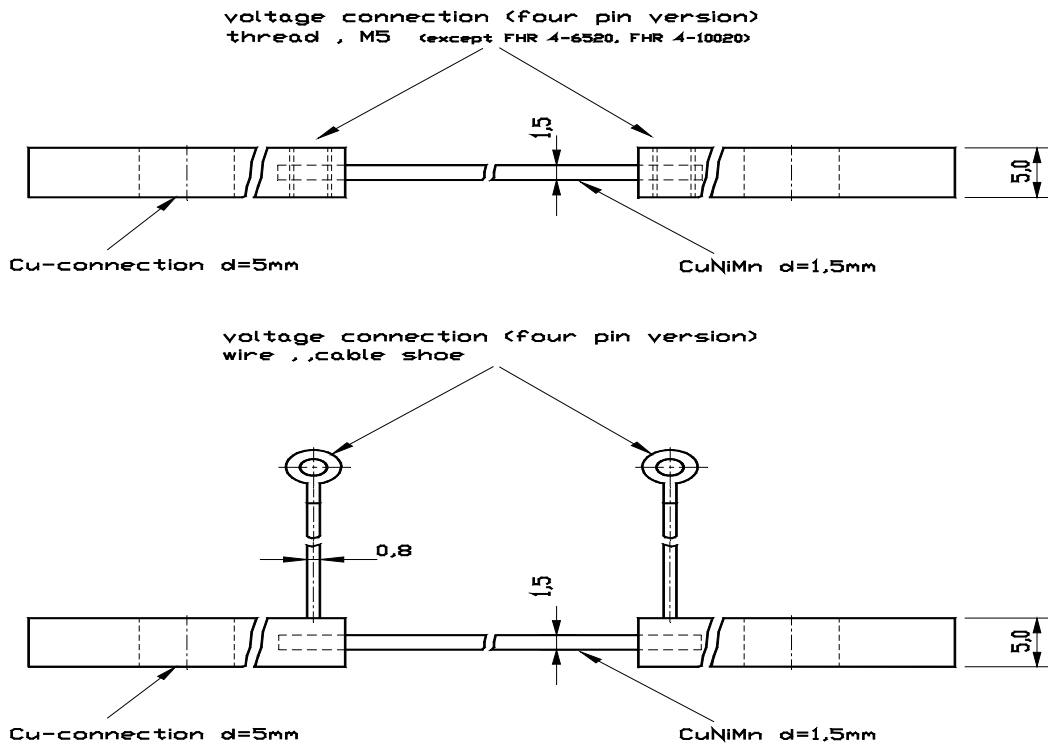

DIMENSIONS

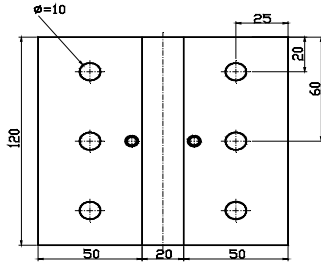

FHR2/4 - 120120

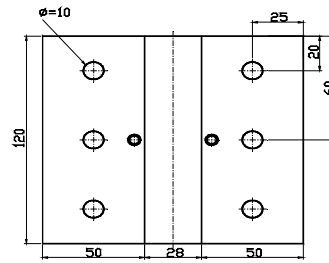

FHR2/4 - 128120

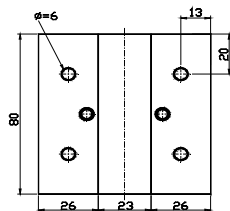

FHR2/4 - 7580

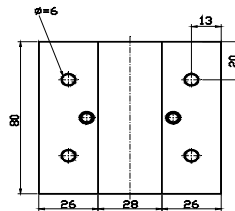

FHR2/4 - 8080

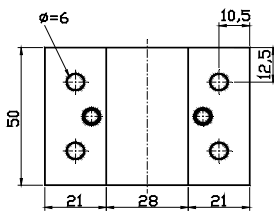

FHR2/4 - 7050

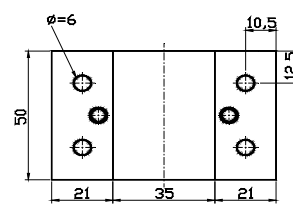

FHR2/4 - 7750

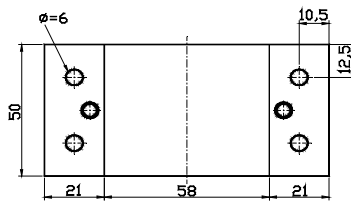

FHR2/4 - 10050

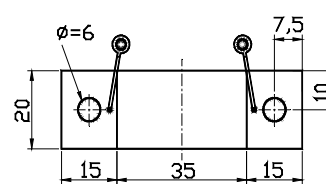

FHR2/4 - 6520

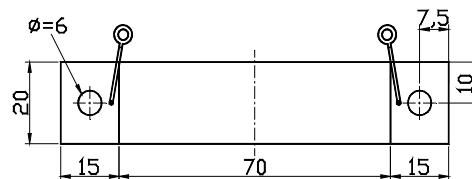

FHR2/4 - 10020

HOW TO ORDER

FHR 2-120120 0R00005 5%

FHR 4-8080 0R0001 2%

FHR 4-6520 0R0005 2%