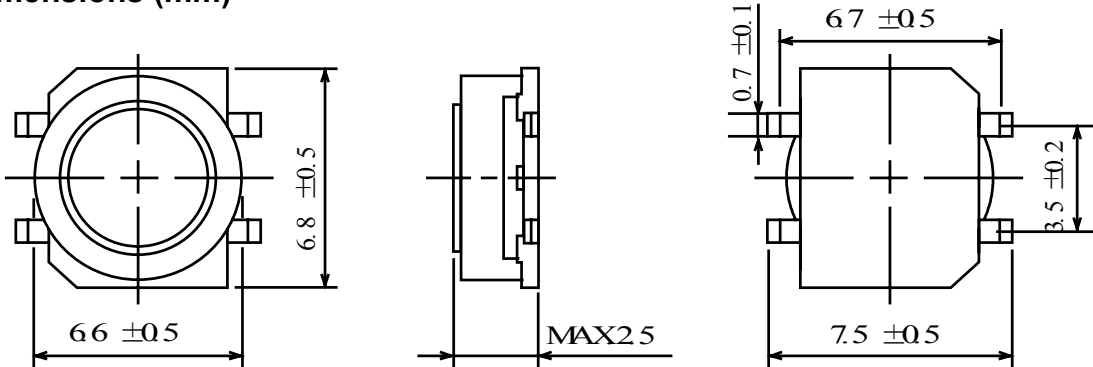
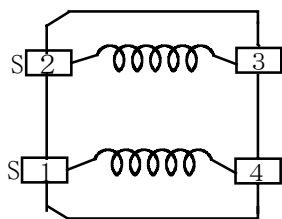

Type: CLS62
◆ Product Description

- 7.3×7.1mm Max.(L×W), 2.5mm Max. Height.
- Inductance Range: 10 μ H~39mH, Rated current range: 37mA~700mA
- In addition to the typical versions of parameters shown here, custom designs are available to meet your exact requirements.

◆ Feature

- Magnetically shielded construction.
- Ideally used in power supply of DSC, DVC, Note PC .
- RoHS Compliance

◆ Dimensions (mm)

◆ Schematics (Bottom)

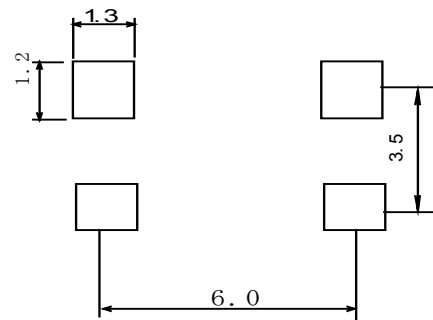
“ S ” indicates winding start.

◆ Land Pattern (mm)

◆ Specification

Sample No.	Inductance (1-4) (100kHz/1.0V)	D.C.R. (1-4)	Rated current (1-4)
6328-T101	10 μ H ± 30%	220m Ω Max.	0.68A

※ Rated current: The D.C. current at which the inductance decreases to 90% of it's initial value or when $\Delta t=40^{\circ}\text{C}$, whichever is lower ($T_a=20^{\circ}\text{C}$).