

Type:RC-875/35, RC-875/50, RC-875/75, RC-875X

Product Description

- 8.3 × 7.5mm Max. (L × W), 11.5mm Max. height (RC-875/35,RC-875/50,RC-875/75)
- 8.3 × 7.3mm Max. (L × W), 11.8mm Max. height (RC-875X)
- Inductance Range: 100 μ H ~ 47mH
- Rated Current Range :10 ~ 400mA

Feature

- Magnetically unshielded construction.
- Ideally Used in Printers, LCD TV, Copy Machine, Mainboard of the compounding machines ,Adapters, etc as Power Supplies's inductors or DC-DC Converter inductors.
- RoHS Compliance

Dimensions (mm)

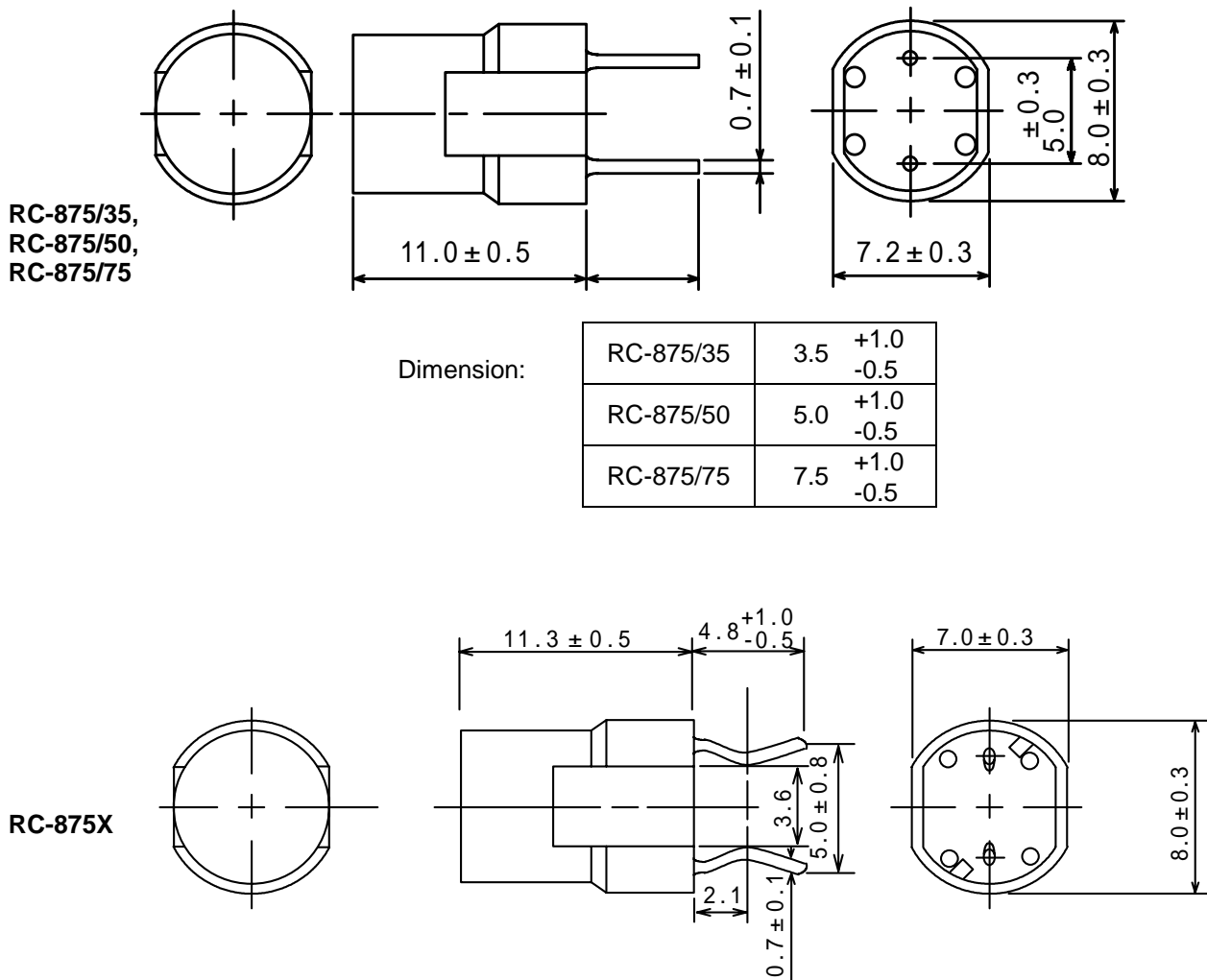

Type:RC-875/35, RC-875/50, RC-875/75, RC-875X
Specification(RC-875/35 -1)

Part Name	Stamp	Inductance [Within] 1	Qu [Min.] 1	D.C.R.() [Max.] (at 20)	Rated Current (m A) [Ref.] 2	S.R.F. [Min.]
RC875NP-101K-35	101K	100 μ H ± 10%	50	0.37	400	4.5MHz
RC875NP-121K-35	121K	120 μ H ± 10%	50	0.42	400	4.1MHz
RC875NP-151K-35	151K	150 μ H ± 10%	50	0.50	370	3.7MHz
RC875NP-181K-35	181K	180 μ H ± 10%	50	0.64	335	3.3MHz
RC875NP-221K-35	221K	220 μ H ± 10%	55	0.75	300	3.0MHz
RC875NP-271K-35	271K	270 μ H ± 10%	60	0.84	275	2.7MHz
RC875NP-331K-35	331K	330 μ H ± 10%	65	1.09	230	2.5MHz
RC875NP-391K-35	391K	390 μ H ± 10%	65	1.20	205	2.3MHz
RC875NP-471K-35	471K	470 μ H ± 10%	70	1.52	180	2.1MHz
RC875NP-561K-35	561K	560 μ H ± 10%	70	1.76	160	1.9MHz
RC875NP-681K-35	681K	680 μ H ± 10%	70	2.00	130	1.7MHz
RC875NP-821K-35	821K	820 μ H ± 10%	75	2.82	115	1.6MHz
RC875NP-102K-35	102K	1.0mH ± 10%	50	3.22	105	1.4MHz
RC875NP-122K-35	122K	1.2mH ± 10%	50	3.55	85	1.3MHz
RC875NP-152K-35	152K	1.5mH ± 10%	50	5.12	70	1.2MHz
RC875NP-182K-35	182K	1.8mH ± 10%	50	5.92	55	1.0MHz
RC875NP-222K-35	222K	2.2mH ± 10%	50	6.75	50	950kHz
RC875NP-272K-35	272K	2.7mH ± 10%	50	9.50	45	870kHz
RC875NP-332K-35	332K	3.3mH ± 10%	55	10.9	40	790kHz
RC875NP-392K-35	392K	3.9mH ± 10%	55	12.2	33	720kHz
RC875NP-472K-35	472K	4.7mH ± 10%	50	17.3	30	660kHz
RC875NP-562K-35	562K	5.6mH ± 10%	50	18.9	28	600kHz
RC875NP-682K-35	682K	6.8mH ± 10%	50	24.6	25	550kHz
RC875NP-822K-35	822K	8.2mH ± 10%	50	28.4	23	500kHz
RC875NP-103K-35	103K	10mH ± 10%	60	26.0	19.5	450kHz
RC875NP-123K-35	123K	12mH ± 10%	60	35.6	18.0	410kHz
RC875NP-153K-35	153K	15mH ± 10%	60	41.2	16.0	370kHz
RC875NP-183K-35	183K	18mH ± 10%	60	54.5	15.0	330kHz
RC875NP-223K-35	223K	22mH ± 10%	60	62.0	13.0	300kHz
RC875NP-273K-35	273K	27mH ± 10%	55	83.2	12.5	270kHz
RC875NP-333K-35	333K	33mH ± 10%	55	95.9	11.5	250kHz
RC875NP-393K-35	393K	39mH ± 10%	50	156	11.0	230kHz
RC875NP-473K-35	473K	47mH ± 10%	50	177	10.0	210kHz

Type:RC-875/35, RC-875/50, RC-875/75, RC-875X
Specification(RC-875/35 -2)

Part Name	Stamp	Inductance [Within] 1	Qu [Min.] 1	D.C.R.() [Max.] (at 20)	Rated Current (m A) [Ref.] 2	S.R.F. [Min.]
RC875NP-101J-35	101J	100 μ H \pm 5%	50	0.37	400	4.5MHz
RC875NP-121J-35	121J	120 μ H \pm 5%	50	0.42	400	4.1MHz
RC875NP-151J-35	151J	150 μ H \pm 5%	50	0.50	370	3.7MHz
RC875NP-181J-35	181J	180 μ H \pm 5%	50	0.64	335	3.3MHz
RC875NP-221J-35	221J	220 μ H \pm 5%	55	0.75	300	3.0MHz
RC875NP-271J-35	271J	270 μ H \pm 5%	60	0.84	275	2.7MHz
RC875NP-331J-35	331J	330 μ H \pm 5%	65	1.09	230	2.5MHz
RC875NP-391J-35	391J	390 μ H \pm 5%	65	1.20	205	2.3MHz
RC875NP-471J-35	471J	470 μ H \pm 5%	70	1.52	180	2.1MHz
RC875NP-561J-35	561J	560 μ H \pm 5%	70	1.76	160	1.9MHz
RC875NP-681J-35	681J	680 μ H \pm 5%	70	2.00	130	1.7MHz
RC875NP-821J-35	821J	820 μ H \pm 5%	75	2.82	115	1.6MHz
RC875NP-102J-35	102J	1.0mH \pm 5%	50	3.22	105	1.4MHz
RC875NP-122J-35	122J	1.2mH \pm 5%	50	3.55	85	1.3MHz
RC875NP-152J-35	152J	1.5mH \pm 5%	50	5.12	70	1.2MHz
RC875NP-182J-35	182J	1.8mH \pm 5%	50	5.92	55	1.0MHz
RC875NP-222J-35	222J	2.2mH \pm 5%	50	6.75	50	950kHz
RC875NP-272J-35	272J	2.7mH \pm 5%	50	9.50	45	870kHz
RC875NP-332J-35	332J	3.3mH \pm 5%	55	10.9	40	790kHz
RC875NP-392J-35	392J	3.9mH \pm 5%	55	12.2	33	720kHz
RC875NP-472J-35	472J	4.7mH \pm 5%	50	17.3	30	660kHz
RC875NP-562J-35	562J	5.6mH \pm 5%	50	18.9	28	600kHz
RC875NP-682J-35	682J	6.8mH \pm 5%	50	24.6	25	550kHz
RC875NP-822J-35	822J	8.2mH \pm 5%	50	28.4	23	500kHz
RC875NP-103J-35	103J	10mH \pm 5%	60	26.0	19.5	450kHz
RC875NP-123J-35	123J	12mH \pm 5%	60	35.6	18.0	410kHz
RC875NP-153J-35	153J	15mH \pm 5%	60	41.2	16.0	370kHz
RC875NP-183J-35	183J	18mH \pm 5%	60	54.5	15.0	330kHz
RC875NP-223J-35	223J	22mH \pm 5%	60	62.0	13.0	300kHz
RC875NP-273J-35	273J	27mH \pm 5%	55	83.2	12.5	270kHz
RC875NP-333J-35	333J	33mH \pm 5%	55	95.9	11.5	250kHz
RC875NP-393J-35	393J	39mH \pm 5%	50	156	11.0	230kHz
RC875NP-473J-35	473J	47mH \pm 5%	50	177	10.0	210kHz

Type:RC-875/35, RC-875/50, RC-875/75, RC-875X
Specification(RC-875/50)

Part Name	Stamp	Inductance [Within] 1	Qu [Min.] 1	D.C.R.() [Max.] (at 20)	Rated current (m A) [Ref.] 2	S.R.F. [Min.]
RC875NP-101J-5Ø	101J	100 µH ± 5%	50	0.37	400	4.5MHz
RC875NP-121J-5Ø	121J	120 µH ± 5%	50	0.42	400	4.1MHz
RC875NP-151J-5Ø	151J	150 µH ± 5%	50	0.50	370	3.7MHz
RC875NP-181J-5Ø	181J	180 µH ± 5%	50	0.64	335	3.3MHz
RC875NP-221J-5Ø	221J	220 µH ± 5%	55	0.75	300	3.0MHz
RC875NP-271J-5Ø	271J	270 µH ± 5%	60	0.84	275	2.7MHz
RC875NP-331J-5Ø	331J	330 µH ± 5%	65	1.09	230	2.5MHz
RC875NP-391J-5Ø	391J	390 µH ± 5%	65	1.20	205	2.3MHz
RC875NP-471J-5Ø	471J	470 µH ± 5%	70	1.52	180	2.1MHz
RC875NP-561J-5Ø	561J	560 µH ± 5%	70	1.76	160	1.9MHz
RC875NP-681J-5Ø	681J	680 µH ± 5%	70	2.00	130	1.7MHz
RC875NP-821J-5Ø	821J	820 µH ± 5%	75	2.82	115	1.6MHz
RC875NP-102J-5Ø	102J	1.0mH ± 5%	50	3.22	105	1.4MHz
RC875NP-122J-5Ø	122J	1.2mH ± 5%	50	3.55	85	1.3MHz
RC875NP-152J-5Ø	152J	1.5mH ± 5%	50	5.12	70	1.2MHz
RC875NP-182J-5Ø	182J	1.8mH ± 5%	50	5.92	55	1.0MHz
RC875NP-222J-5Ø	222J	2.2mH ± 5%	50	6.75	50	950kHz
RC875NP-272J-5Ø	272J	2.7mH ± 5%	50	9.50	45	870kHz
RC875NP-332J-5Ø	332J	3.3mH ± 5%	55	10.9	40	790kHz
RC875NP-392J-5Ø	392J	3.9mH ± 5%	55	12.2	33	720kHz
RC875NP-472J-5Ø	472J	4.7mH ± 5%	50	17.3	30	660kHz
RC875NP-562J-5Ø	562J	5.6mH ± 5%	50	18.9	28	600kHz
RC875NP-682J-5Ø	682J	6.8mH ± 5%	50	24.6	25	550kHz
RC875NP-822J-5Ø	822J	8.2mH ± 5%	50	28.4	23	500kHz
RC875NP-103J-5Ø	103J	10mH ± 5%	60	26.0	19.5	450kHz
RC875NP-123J-5Ø	123J	12mH ± 5%	60	35.6	18.0	410kHz
RC875NP-153J-5Ø	153J	15mH ± 5%	60	41.2	16.0	370kHz
RC875NP-183J-5Ø	183J	18mH ± 5%	60	54.5	15.0	330kHz
RC875NP-223J-5Ø	223J	22mH ± 5%	60	62.0	13.0	300kHz
RC875NP-273J-5Ø	273J	27mH ± 5%	55	83.2	12.5	270kHz
RC875NP-333J-5Ø	333J	33mH ± 5%	55	95.9	11.5	250kHz
RC875NP-393J-5Ø	393J	39mH ± 5%	50	156	11.0	230kHz
RC875NP-473J-5Ø	473J	47mH ± 5%	50	177	10.0	210kHz

Type:RC-875/35, RC-875/50, RC-875/75, RC-875X
Specification(RC-875/75 -1)

Part Name	Stamp	Inductance [Within] 1	Qu [Min.] 1	D.C.R.() [Max.] (at 20)	Rated Current (mA) [Ref.] 2	S.R.F. [Min.]
RC875NP-101K-75	101K	100 μ H \pm 10%	50	0.37	400	4.5MHz
RC875NP-121K-75	121K	120 μ H \pm 10%	50	0.42	400	4.1MHz
RC875NP-151K-75	151K	150 μ H \pm 10%	50	0.50	370	3.7MHz
RC875NP-181K-75	181K	180 μ H \pm 10%	50	0.64	335	3.3MHz
RC875NP-221K-75	221K	220 μ H \pm 10%	55	0.75	300	3.0MHz
RC875NP-271K-75	271K	270 μ H \pm 10%	60	0.84	275	2.7MHz
RC875-NP-331K-75	331K	330 μ H \pm 10%	65	1.09	230	2.5MHz
RC875NP-391K-75	391K	390 μ H \pm 10%	65	1.20	205	2.3MHz
RC875NP-471K-75	471K	470 μ H \pm 10%	70	1.52	180	2.1MHz
RC875NP-561K-75	561K	560 μ H \pm 10%	70	1.76	160	1.9MHz
RC875NP-681K-75	681K	680 μ H \pm 10%	70	2.00	130	1.7MHz
RC875NP-821K-75	821K	820 μ H \pm 10%	75	2.82	115	1.6MHz
RC875NP-102K-75	102K	1.0mH \pm 10%	50	3.22	105	1.4MHz
RC875NP-122K-75	122K	1.2mH \pm 10%	50	3.55	85	1.3MHz
RC875NP-152K-75	152K	1.5mH \pm 10%	50	5.12	70	1.2MHz
RC875NP-182K-75	182K	1.8mH \pm 10%	50	5.92	55	1.0MHz
RC875NP-222K-75	222K	2.2mH \pm 10%	50	6.75	50	950kHz
RC875NP-272K-75	272K	2.7mH \pm 10%	50	9.50	45	870kHz
RC875NP-332K-75	332K	3.3mH \pm 10%	55	10.9	40	790kHz
RC875NP-392K-75	392K	3.9mH \pm 10%	55	12.2	33	720kHz
RC875NP-472K-75	472K	4.7mH \pm 10%	50	17.3	30	660kHz
RC875NP-562K-75	562K	5.6mH \pm 10%	50	18.9	28	600kHz
RC875NP-682K-75	682K	6.8mH \pm 10%	50	24.6	25	550kHz
RC875NP-822K-75	822K	8.2mH \pm 10%	50	28.4	23	500kHz
RC875NP-103K-75	103K	10mH \pm 10%	60	26.0	19.5	450kHz
RC875NP-123K-75	123K	12mH \pm 10%	60	35.6	18.0	410kHz
RC875NP-153K-75	153K	15mH \pm 10%	60	41.2	16.0	370kHz
RC875NP-183K-75	183K	18mH \pm 10%	60	54.5	15.0	330kHz
RC875NP-223K-75	223K	22mH \pm 10%	60	62.0	13.0	300kHz
RC875NP-273K-75	273K	27mH \pm 10%	55	83.2	12.5	270kHz
RC875NP-333K-75	333K	33mH \pm 10%	55	95.9	11.5	250kHz
RC875NP-393K-75	393K	39mH \pm 10%	50	156	11.0	230kHz
RC875NP-473K-75	473K	47mH \pm 10%	50	177	10.0	210kHz

Type:RC-875/35, RC-875/50, RC-875/75, RC-875X
Specification(RC-875/75 -2)

Part Name	Stamp	Inductance [Within] 1	Qu [Min.] 1	D.C.R.() [Max.] (at 20)	Rated Current (mA) [Ref.] 2	S.R.F. [Min.]
RC875NP-1Ø1J-75	101J	100 µH ± 5%	50	0.37	400	4.5MHz
RC875NP-121J-75	121J	120 µH ± 5%	50	0.42	400	4.1MHz
RC875NP-151J-75	151J	150 µH ± 5%	50	0.50	370	3.7MHz
RC875-NP-181J-75	181J	180 µH ± 5%	50	0.64	335	3.3MHz
RC875NP-221J-75	221J	220 µH ± 5%	55	0.75	300	3.0MHz
RC875NP-271J-75	271J	270 µH ± 5%	60	0.84	275	2.7MHz
RC875NP-331J-75	331J	330 µH ± 5%	65	1.09	230	2.5MHz
RC875NP-391J-75	391J	390 µH ± 5%	65	1.20	205	2.3MHz
RC875NP-471J-75	471J	470 µH ± 5%	70	1.52	180	2.1MHz
RC875NP-561J-75	561J	560 µH ± 5%	70	1.76	160	1.9MHz
RC875NP-681J-75	681J	680 µH ± 5%	70	2.00	130	1.7MHz
RC875NP-821J-75	821J	820 µH ± 5%	75	2.82	115	1.6MHz
RC875NP-1Ø2J-75	102J	1.0mH ± 5%	50	3.22	105	1.4MHz
RC875NP-122J-75	122J	1.2mH ± 5%	50	3.55	85	1.3MHz
RC875NP-152J-75	152J	1.5mH ± 5%	50	5.12	70	1.2MHz
RC875NP-182J-75	182J	1.8mH ± 5%	50	5.92	55	1.0MHz
RC875NP-222J-75	222J	2.2mH ± 5%	50	6.75	50	950kHz
RC875NP-272J-75	272J	2.7mH ± 5%	50	9.50	45	870kHz
RC875NP-332J-75	332J	3.3mH ± 5%	55	10.9	40	790kHz
RC875NP-392J-75	392J	3.9mH ± 5%	55	12.2	33	720kHz
RC875NP-472J-75	472J	4.7mH ± 5%	50	17.3	30	660kHz
RC875NP-562J-75	562J	5.6mH ± 5%	50	18.9	28	600kHz
RC875NP-682J-75	682J	6.8mH ± 5%	50	24.6	25	550kHz
RC875NP-822J-75	822J	8.2mH ± 5%	50	28.4	23	500kHz
RC875NP-1Ø3J-75	103J	10mH ± 5%	60	26.0	19.5	450kHz
RC875NP-123J-75	123J	12mH ± 5%	60	35.6	18.0	410kHz
RC875NP-153J-75	153J	15mH ± 5%	60	41.2	16.0	370kHz
RC875NP-183J-75	183J	18mH ± 5%	60	54.5	15.0	330kHz
RC875NP-223J-75	223J	22mH ± 5%	60	62.0	13.0	300kHz
RC875NP-273J-75	273J	27mH ± 5%	55	83.2	12.5	270kHz
RC875NP-333J-75	333J	33mH ± 5%	55	95.9	11.5	250kHz
RC875NP-393J-75	393J	39mH ± 5%	50	156	11.0	230kHz
RC875NP-473J-75	473J	47mH ± 5%	50	177	10.0	210kHz

Type:RC-875/35, RC-875/50, RC-875/75, RC-875X
Specification(RC-875X)

Part Name	Stamp	Inductance [Within] 1	Qu [Min.] 1	D.C.R.() [Max.] (at 20)	Rated Current (mA) [Ref.] 2	S.R.F. [Min.]
RC875XNP-101K	101K	100 μ H \pm 10%	50	0.37	400	4.5MHz
RC875XNP-121K	121K	120 μ H \pm 10%	50	0.42	400	4.1MHz
RC875XNP-151K	151K	150 μ H \pm 10%	50	0.50	370	3.7MHz
RC875XNP-181K	181K	180 μ H \pm 10%	50	0.64	335	3.3MHz
RC875XNP-221K	221K	220 μ H \pm 10%	55	0.75	300	3.0MHz
RC875XNP-271K	271K	270 μ H \pm 10%	60	0.84	275	2.7MHz
RC875XNP-331K	331K	330 μ H \pm 10%	65	1.09	230	2.5MHz
RC875XNP-391K	391K	390 μ H \pm 10%	65	1.20	205	2.3MHz
RC875XNP-471K	471K	470 μ H \pm 10%	70	1.52	180	2.1MHz
RC875XNP-561K	561K	560 μ H \pm 10%	70	1.76	160	1.9MHz
RC875XNP-681K	681K	680 μ H \pm 10%	70	2.00	130	1.7MHz
RC875XNP-821K	821K	820 μ H \pm 10%	75	2.82	115	1.6MHz
RC875XNP-102K	102K	1.0mH \pm 10%	50	3.22	105	1.4MHz
RC875XNP-122K	122K	1.2mH \pm 10%	50	3.55	85	1.3MHz
RC875XNP-152K	152K	1.5mH \pm 10%	50	5.12	70	1.2MHz
RC875XNP-182K	182K	1.8mH \pm 10%	50	5.92	55	1.0MHz
RC875XNP-222K	222K	2.2mH \pm 10%	50	6.75	50	950kHz
RC875XNP-272K	272K	2.7mH \pm 10%	50	9.50	45	870kHz
RC875XNP-332K	332K	3.3mH \pm 10%	55	10.9	40	790kHz
RC875XNP-392K	392K	3.9mH \pm 10%	55	12.2	33	720kHz
RC875XNP-472K	472K	4.7mH \pm 10%	50	17.3	30	660kHz
RC875XNP-562K	562K	5.6mH \pm 10%	50	18.9	28	600kHz
RC875XNP-682K	682K	6.8mH \pm 10%	50	24.6	25	550kHz
RC875XNP-822K	822K	8.2mH \pm 10%	50	28.4	23	500kHz
RC875XNP- 103K	103K	10mH \pm 10%	60	26.0	19.5	450kHz
RC875XNP-123K	123K	12mH \pm 10%	60	35.6	18.0	410kHz
RC875XNP-153K	153K	15mH \pm 10%	60	41.2	16.0	370kHz
RC875XNP-183K	183K	18mH \pm 10%	60	54.5	15.0	330kHz
RC875XNP-223K	223K	22mH \pm 10%	60	62.0	13.0	300kHz
RC875XNP-273K	273K	27mH \pm 10%	55	83.2	12.5	270kHz
RC875X-NP-333K	333K	33mH \pm 10%	55	95.9	11.5	250kHz
RC875XNP-393K	393K	39mH \pm 10%	50	156	11.0	230kHz
RC875XNP-473K	473K	47mH \pm 10%	50	177	10.0	210kHz

The named of this part is very specially please pay attention to it

1 Measuring frequency 100 μ H ~ 820 μ H Inductance: at 1 kHz ; Qu: at 100 kHz
1.0 mH ~ 47 mH Inductance: at 1 kHz ; Qu: at 50 kHz

2. Rated current

The DC current at which the temperature rise is $t = 40$ ($T_a = 20$),(for 101K and 121K)

The DC current at which the inductance decreases to 95% of it's nominal value.(for the other Part Numbers)