

# 4.0 Amp SINGLE PHASE SILICON BRIDGE

**KBU400 . . . 410 Series**

## Description



## Mechanical Dimensions

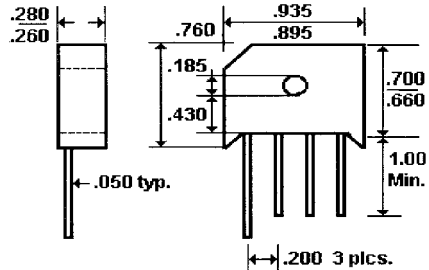

**Mechanical Data:** Weight - 0.3 Ounces. Mounting Torque - 5.1 lbs. Mounting Position - Any.

## Features

- COMPACT SIZE
- LOW LEAKAGE CURRENT
- 200 AMP SURGE OVERLOAD RATING
- MEETS UL SPECIFICATION 94V-0

Electrical Characteristics @ 25°C.	KBU400 . . . 410 Series								Units
Maximum Ratings	KBU400	KBU401	KBU402	KBU404	KBU406	KBU408	KBU410		
Peak Repetitive Reverse Voltage... $V_{RRM}$	50	100	200	400	600	800	1000	Volts	
RMS Reverse Voltage... $V_{R(rms)}$	35	70	140	280	420	560	700	Volts	
DC Blocking Voltage... $V_{DC}$	50	100	200	400	600	800	1000	Volts	
Average Forward Rectified Current... $I_{F(av)}$ $T_A = 25^\circ C$	.....			4.0	.....			Amps	
Non-Repetitive Peak Forward Surge Current... $I_{FSM}$ 8.3 ms Single ½ Sine Wave Imposed on Rated Load	.....			200	.....			Amps	
Forward Voltage... $V_F$ Bridge Element @ 4.0 Amps	.....			1.1	.....			Volts	
DC Reverse Current... $I_R$ @ Rated DC Blocking Voltage	.....			10	.....			$\mu$ Amps	
	.....			1.0	.....			mAmps	
Typical Thermal Resistance... $R_{\theta JC}$	.....			14	.....			°C/W	
Operating Temperature Range... $T_J$	.....			-55 to 125	.....			°C	
Storage Temperature Range... $T_{STRG}$	.....			-55 to 150	.....			°C	

# 4.0 Amp SINGLE PHASE SILICON BRIDGE

**KBU400 . . . 410 Series**

**Forward Current Derating Curve**

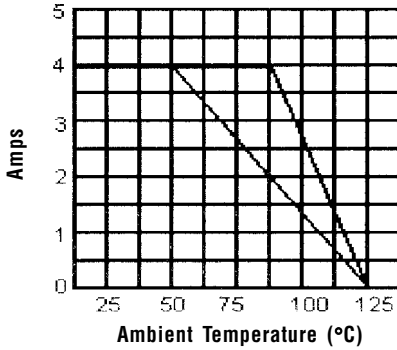

**Non-Repetitive Peak Forward Surge Current**

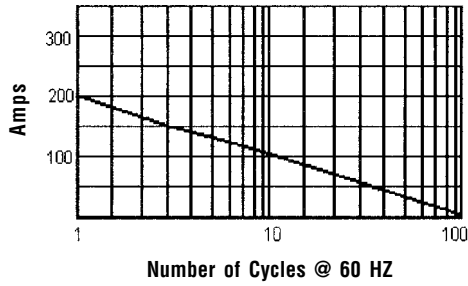

**Typical Instantaneous Forward Characteristics**

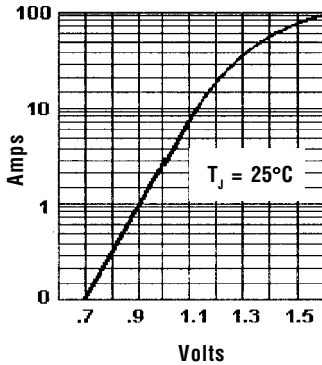

**Typical Reverse Characteristics**

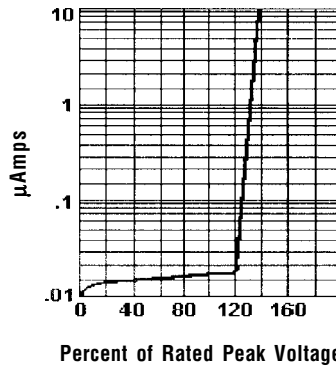

**Typical Junction Capacitance**

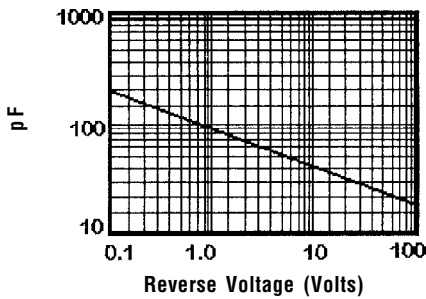

**Electrical Description**

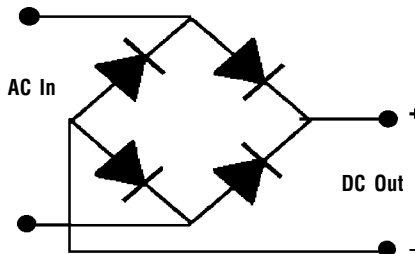

Ratings at 25 Deg. C ambient temperature unless otherwise specified.

Single Phase Half Wave, 60 HZ Resistive or Inductive Load.

For Capacitive Load, Derate Current by 20%.