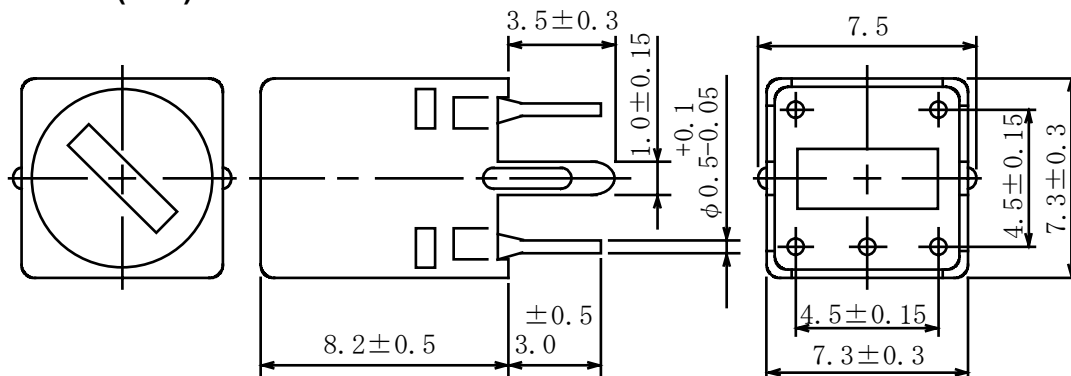

Type: PG78 /FM, PG78/AM, PG78/SW, PG78/MW
◆ Product Description

- 7.6×7.6mm Max.(L×W), 8.7mm Max. Height.
- Operating frequency:20MHz Max.
- In addition to the reference versions of parameters shown here, custom designs are available to meet your exact requirements.

◆ Feature

- Variable shielded type.
- FM,AM,SW,MW types are available.
- Internally assembled condenser is available.
- Ideally used in Radio (FM, AM,SW,MW),TV. Transceiver
- RoHS Compliance

◆ Dimensions (mm)

- * Dimension does not include solder used on coil.
- * Pin pitch shall be measured at the root of terminal.
- * Dimension without tolerance are approx.

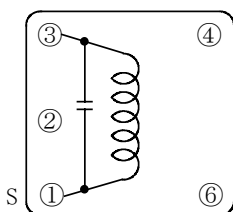
◆ Connection (Bottom View)

PG78/FM

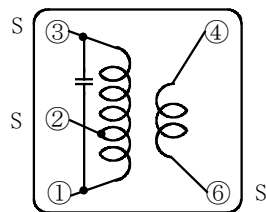

PG78/AM

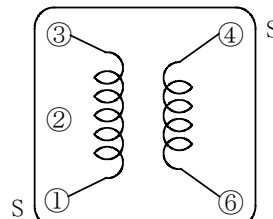

PG78/SW

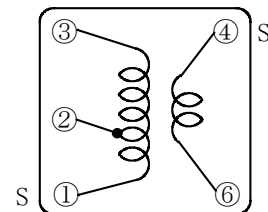

PG78/MW

"S" is winding start

Type: PG78 /FM, PG78/AM, PG78/SW, PG78/MW
◆ Specification (PG78/FM) (Part No. 2176-T060)

	(1-3)	Measuring Condition
Using frequency	1 0 . 7 MH z ± 1 % Variable	
Unloaded Qu	6 0 Min.	1 0 . 7 MH z
Capacity (Int.)	1 0 0 p F ± 1 0 %	
Ext stray capacity 0pF between (1-3) at measuring.		

◆ Specification (PG78/AM) (Part No. S0975881)

Item	(1-3)	Measuring Conditions
Frequency	455kHz±2% Variable	
Unloaded Qu	50 Min.	455kHz
Capacity (INT.)	180pF±10%	

◆ Specification (PG78/SW) (Part No. 2178-T044)

Item	(1-3)	Measuring Conditions
Inductance	110μH ± 4% Variable	2.52MHz
Unloaded Qu	40 Min.	2.52MHz

◆ Specification (P-7GB/MW) (Part No. 2177-T074)

Item	(1-3)	Measuring Condition
Inductance	400 μ H ± 5% Variable	7 9 6 KHz
Unloaded Qu	55 Min.	7 9 6 KHz