

## 300mA Low Profile Chip Schottky Rectifier

### Features

- Low profile with SMD package
- Low power loss , High efficiency
- High current capability, Low voltage drop
- Plastic package has Underwriters Laboratory Flammability Classification 94V-0
- RoHS compliant

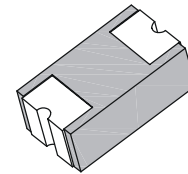

C0603  
(SOD-523)



### Mechanical Data

<b>Case:</b>	0603 SMD package, Molded plastic body
<b>Terminals:</b>	Pure Tin plated, solderable per MIL-STD-750, Method 2026
<b>Polarity</b>	Laser cathode band marking
<b>Weight:</b>	0.003 gram

### Maximum Ratings *(T<sub>Ambient</sub>=25°C unless noted otherwise)*

Symbol	Description	TSCD032WT	TSCD034WT	Unit	Conditions
	Marking Code	2C	4C		
<b>VRRM</b>	Repetitive Peak Reverse Voltage	20	40	V	
<b>VRWM</b>	Working Peak Reverse Voltage	20	40	V	
<b>IF(AV)</b>	Forward Rectified Current	300		mA	
<b>IFSM</b>	Non-repetitive Peak Forward Surge Current	2.0		A	8.3ms single half sine-wave
<b>TJ</b>	Operating Junction temperature range	-40 to +125		° C	
<b>TSTG</b>	Storage Temperature Range	-40 to +125		° C	

### Electrical Characteristics *(T<sub>Ambient</sub>=25°C unless noted otherwise)*

Symbol	Description	TSCD032WT	TSCD034WT	Unit	Conditions
<b>VF</b>	Forward Voltage	0.50		V	IF= 0.3A
<b>IR</b>	Reverse Current	50		µA	Maximum DC Reverse Current at Rated DC Blocking Voltage
		20			Maximum DC Reverse Current at 10 V

# 300mA Low Profile Chip Schottky Rectifier

## TSCD032WT-TSCD034WT

### Typical Characteristics Curves

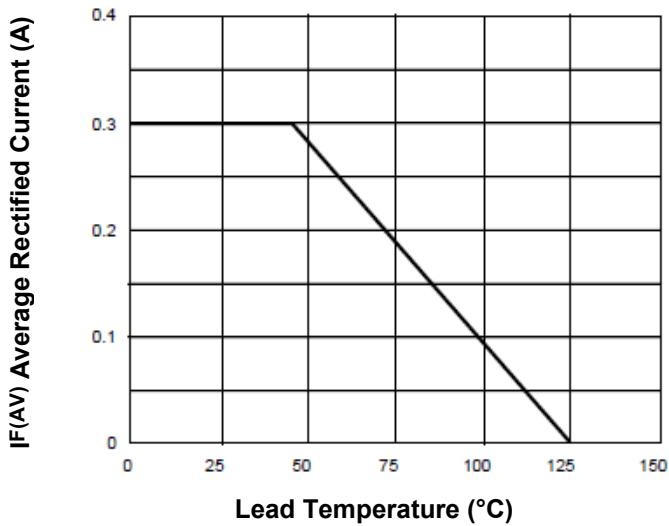

Fig.1- Forward Current Derating Curve

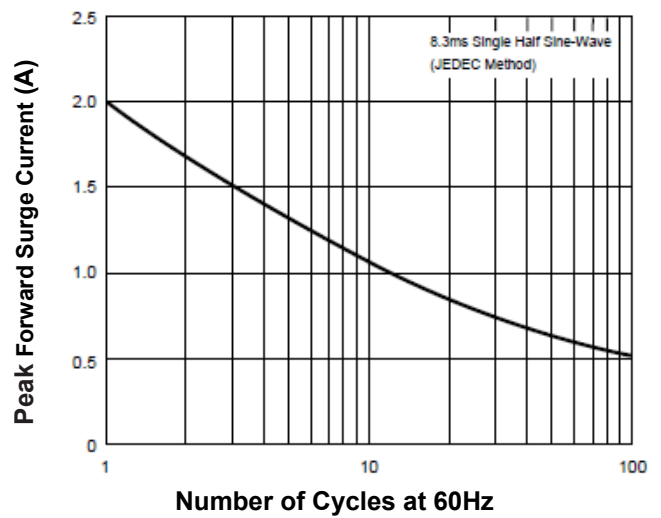
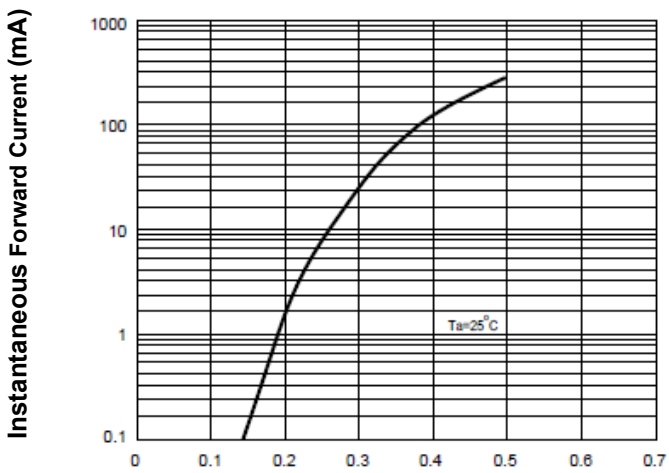
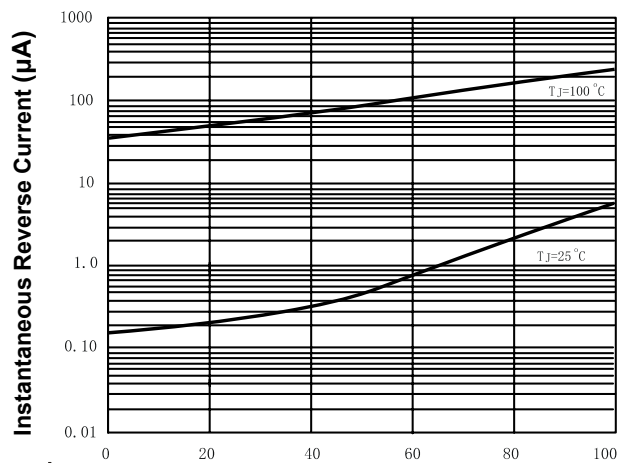

Fig.2- Max. Non-Repetitive Forward Surge Current



Instantaneous Forward Voltage (V)  
Fig.3- Typical Forward Characteristics



Percent of Rated Peak Reverse Voltage (%)  
Fig.4- Typical Reverse Characteristics

# 300mA Low Profile Chip Schottky Rectifier

## TSCD032WT-TSCD034WT

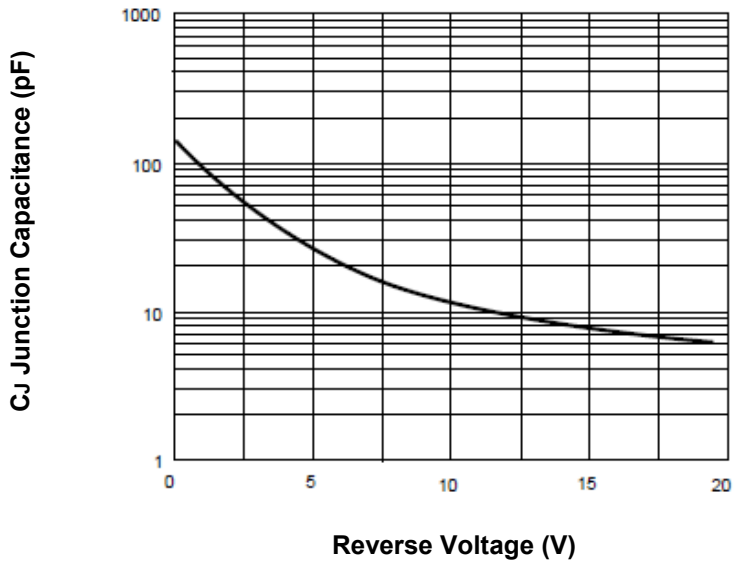
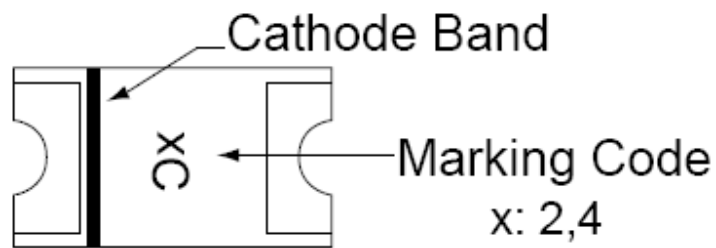

Fig.5-Typical junction capacitance

### Marking Information:



# 300mA Low Profile Chip Schottky Rectifier

## TSCD032WT-TSCD034WT

### Dimensions in inch (mm)

**C0603**  
**(SOD-523)**

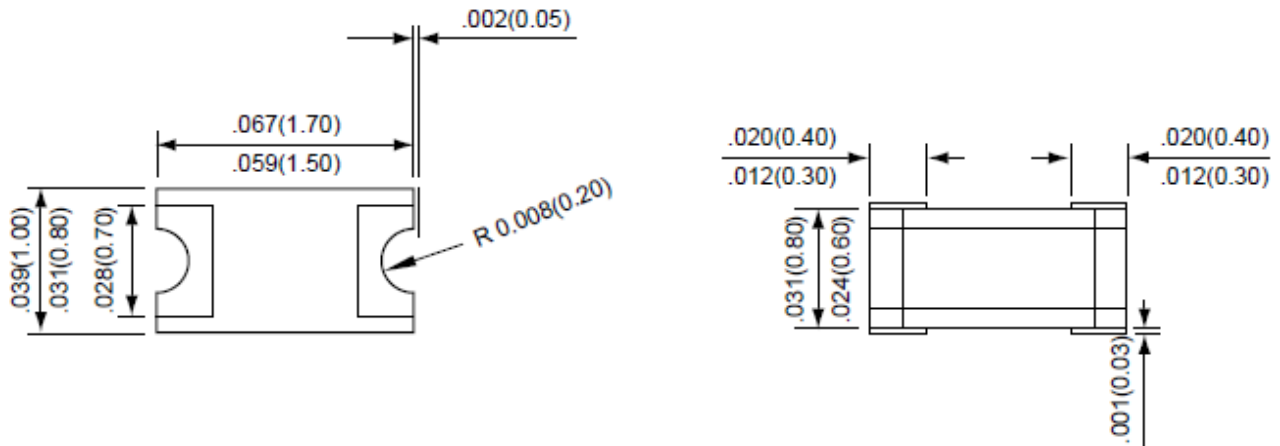

### How to contact us:

#### US HEADQUARTERS

28040 WEST HARRISON PARKWAY, VALENCIA, CA 91355-4162

Tel: (800) TAITRON (800) 824-8766 (661) 257-6060

Fax: (800) TAITFAX (800) 824-8329 (661) 257-6415

Email: [taitron@taitroncomponents.com](mailto:taitron@taitroncomponents.com)

Http://[www.taitroncomponents.com](http://www.taitroncomponents.com)

#### TAITRON COMPONENTS MEXICO, S.A .DE C.V.

BOULEVARD CENTRAL 5000 INTERIOR 5 PARQUE INDUSTRIAL ATITALAQUIA, HIDALGO C.P.

42970 MEXICO

Tel: +52-55-5560-1519

Fax: +52-55-5560-2190

#### TAITRON COMPONENTS INCORPORATED REPRESENTAÇÕES DO BRASIL LTDA

RUA DOMINGOS DE MORAIS, 2777, 2.ANDAR, SALA 24 SAÚDE - SÃO PAULO-SP 04035-001 BRAZIL

Tel: +55-11-5574-7949

Fax: +55-11-5572-0052

#### TAITRON COMPONENTS INCORPORATED, SHANGHAI REPRESENTATIVE OFFICE

METROBANK PLAZA, 1160 WEST YAN' AN ROAD, SUITE 1503, SHANGHAI, 200052, CHINA

Tel: +86-21-5424-9942

Fax: +86-21-5424-9931