

**Technical Data Sheet****White SMD Surface Mount Device****67-13/W3C-MW1X2/2T****Features**

- Fluorescence Type
- High Luminous Intensity
- High Efficiency
- Emission Color:x=0.29,y=0.30
- Pb free
- The product itself will remain within RoHS compliant version.

**Descriptions**

The white LED which was fabricated using a blue LED and a phosphor, and the phosphor is excited by blue light and emits yellow fluorescence. The mixture of blue light and yellow light results in a white emission.

**Applications**

- OA Equipment
- Backlighting of Full Color LCD
- Automotive Equipment
- Replacement of Conventional Light Bulbs and Fluorescent Lamps

**Device Selection Guide**

Chip		Lens Color
Material	Emitted Color	
InGaN	White	Water Clear

**67-13/W3C-MW1X2/2T**

**Package Dimensions**

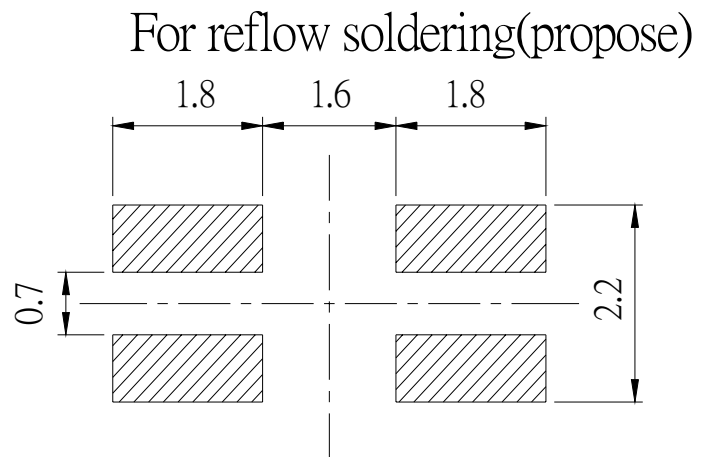
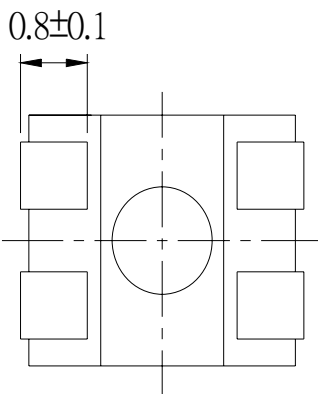
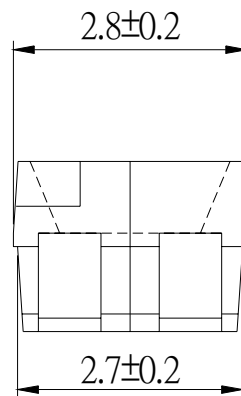
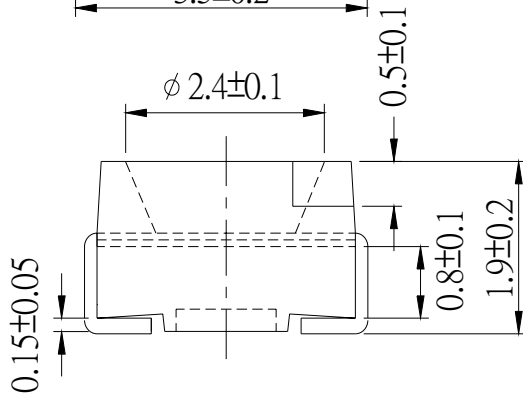
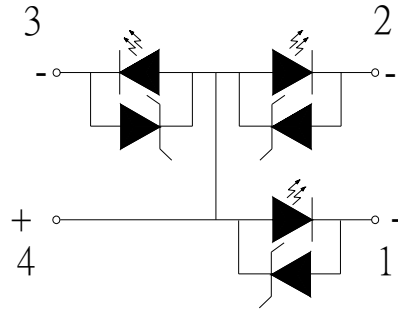
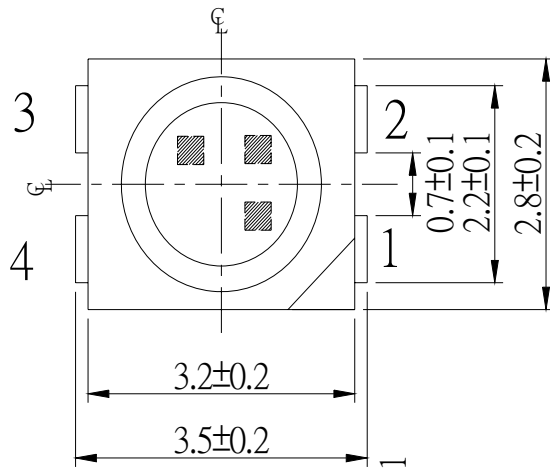

**Note:** The tolerances unless mentioned is ±0.1mm ,Unit = mm

**67-13/W3C-MW1X2/2T**

**Absolute Maximum Ratings (Ta=25°C)**

Parameter	Symbol	Rating	Unit
Reverse Voltage*1	V <sub>R</sub>	5	V
Forward Current*1	I <sub>F</sub>	25	mA
Operating Temperature	T <sub>opr</sub>	-40 ~ +85	°C
Storage Temperature	T <sub>stg</sub>	-40 ~ +90	°C
Electrostatic Discharge(HBM)*1	ESD	2000	V
Power Dissipation*1	P <sub>d</sub>	110	mW
Peak Forward Current (Duty 1/10 @1KHz)*1	I <sub>FP</sub>	100	mA
Soldering Temperature	T <sub>sol</sub>	Reflow Soldering : 260 °C for 10 sec. Hand Soldering : 350 °C for 3 sec.	

\* 1: The value are based on 1 die performance

Notes: The products are sensitive to static electricity and care must be fully taken when handling products.

**Electro-Optical Characteristics (Ta=25°C)**

Parameter	Symbol	Min.	Typ.	Max.	Units	Condition
Luminous Intensity*1	I <sub>v</sub>	1120	-----	2850	mcd	I <sub>F</sub> =20mA*2
Forward Voltage*2	V <sub>F</sub>	-----	3.3	3.7	V	I <sub>F</sub> =20mA*2
Viewing Angle	2θ 1/2	--	120	--	deg	I <sub>F</sub> =20mA*2

\*1 When three LED dies are operated simultaneously.

\*2 For each die.

Notes:

**1.Tolerance of Luminous Intensity ±10%**

**67-13/W3C-MW1X2/2T****Bin Range Of Luminous Intensity**

Bin Code	Min.	Max.	Unit	Condition
W1	1120	1420	mcd	I <sub>F</sub> =20mA
W2	1420	1800		
X1	1800	2250		
X2	2250	2850		

Notes:

**1.Tolerance of Luminous Intensity  $\pm 10\%$**

**67-13/W3C-MW1X2/2T**

Chromaticity Coordinates Specifications for Bin Grading

Group	Bin Code	CIE_x	CIE_y	Bin Code	CIE_x	CIE_y
M	B5-1	0.291	0.286	B5-3	0.296	0.276
		0.287	0.295		0.292	0.286
		0.297	0.305		0.300	0.295
		0.300	0.295		0.304	0.285
	B5-2	0.300	0.295	B5-4	0.304	0.285
		0.297	0.305		0.300	0.295
		0.307	0.315		0.309	0.305
		0.309	0.305		0.311	0.294
	A0-1	0.272	0.258	A0-3	0.280	0.248
		0.264	0.267		0.272	0.258
		0.276	0.281		0.282	0.272
		0.282	0.272		0.288	0.262
	A0-2	0.282	0.272	A0-4	0.288	0.262
		0.276	0.281		0.282	0.272
		0.287	0.295		0.292	0.286
		0.292	0.286		0.296	0.276

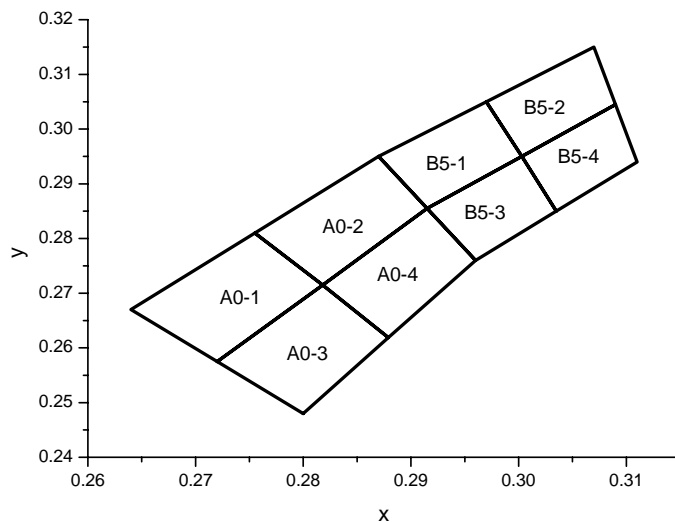

\*The C.I.E. 1931 chromaticity diagram ( Tolerance  $\pm 0.01$ ).

**Typical Electro-Optical Characteristics Curves**

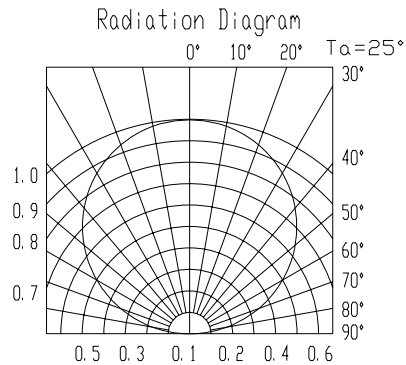
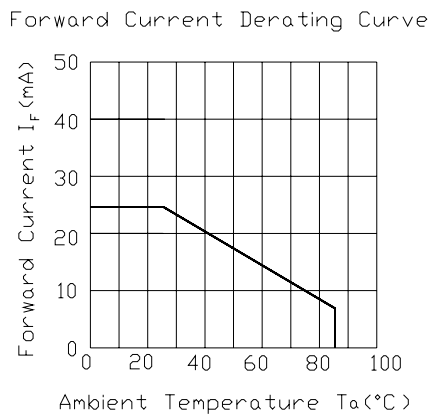
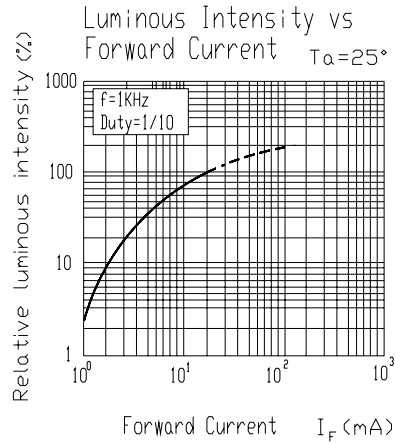
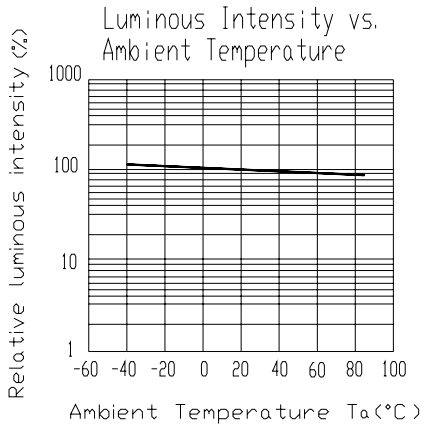
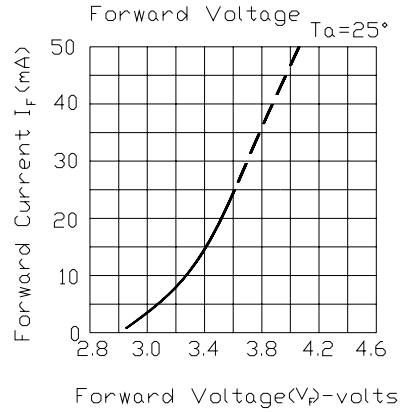
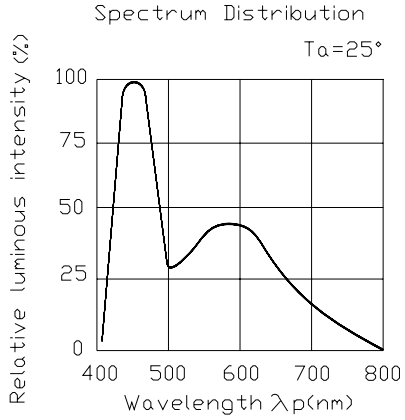

**67-13/W3C-MW1X2/2T**

**Label explanation**

**CAT: Luminous Intensity Rank**

**HUE: Chromaticity Coordinates**

**REF: Forward Voltage Rank**

EVERLIGHT

CPN: XXXXXX  
P/N: XXXXXX



RoHS

XXXXXXXXXXXXXXXXXXXX  
QTY: XXXX



LOT NO: XXXXXXXXXXXX



CAT:  
HUE:  
REF:

MADE IN TAIWAN

**Reel Dimensions**

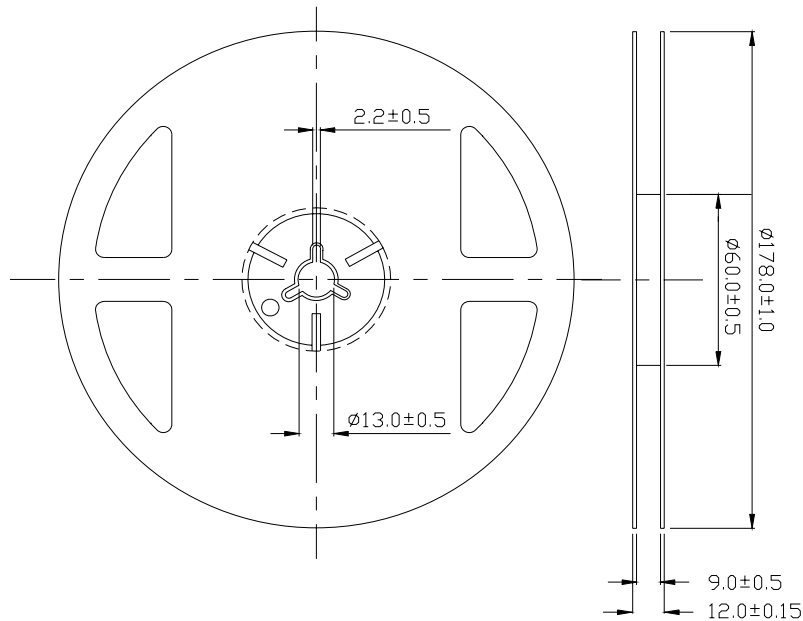

**Note:** The tolerances unless mentioned is  $\pm 0.1$ mm ,Unit = mm

**67-13/W3C-MW1X2/2T**

**Carrier Tape Dimensions: Loaded quantity 2000 PCS per reel.**

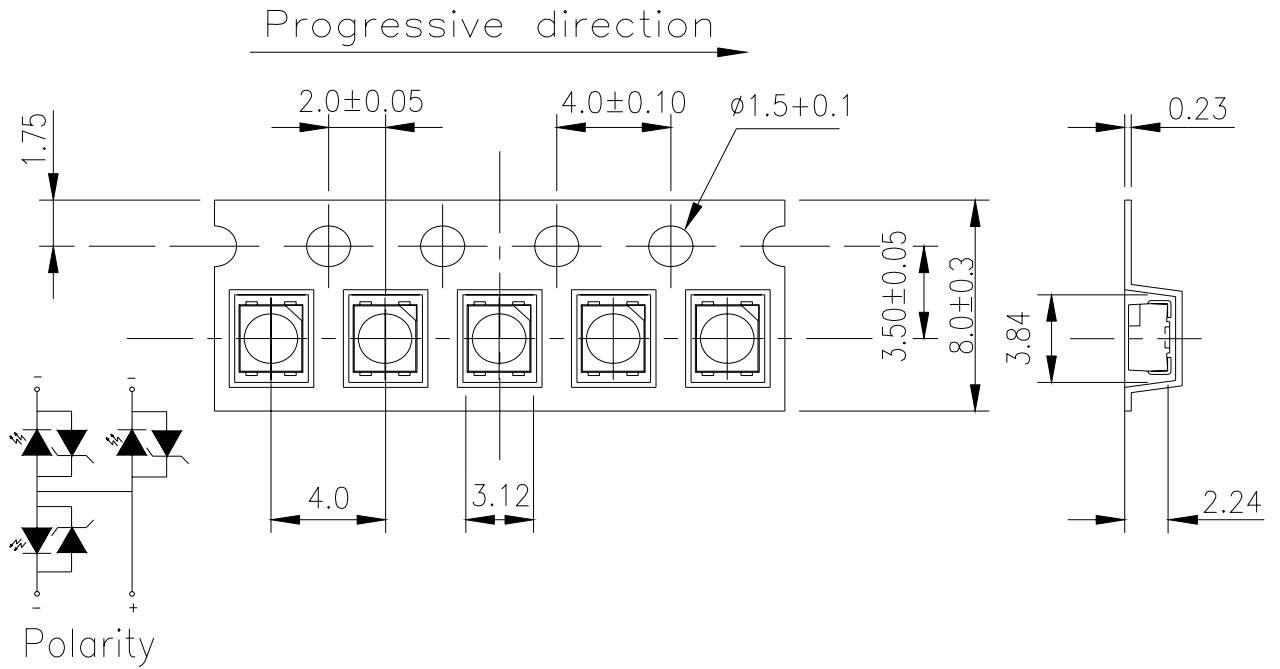

**Note:** The tolerances unless mentioned is  $\pm 0.1$ mm ,Unit = mm

**Moisture Resistant Packaging**

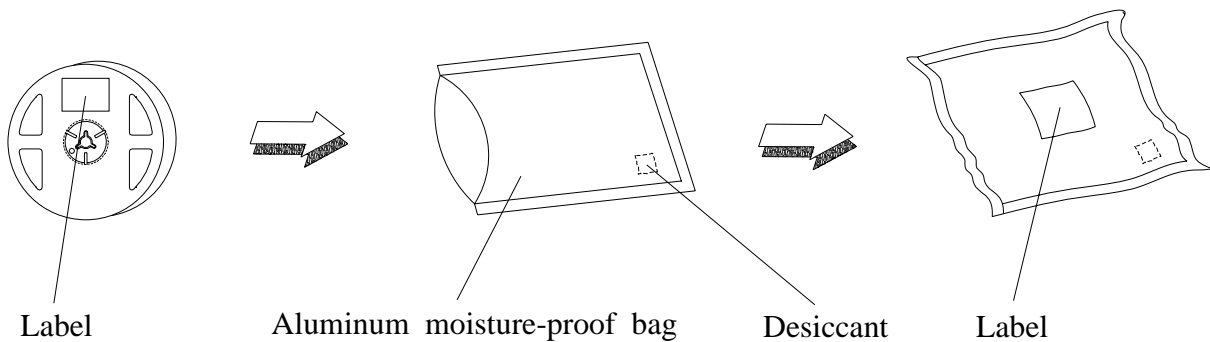



**67-13/W3C-MW1X2/2T**

**Reliability Test Items And Conditions**

The reliability of products shall be satisfied with items listed below.

Confidence level : 90%

LTPD : 10%

No.	Items	Test Condition	Test Hours/Cycles	Sample Size	Ac/Re
1	Reflow Soldering	Temp. : 260°C±5°C Min. 5sec.	6 min	22 PCS.	0/1
2	Temperature Cycle	H : +100°C 15min ∫ 5 min L : -40°C 15min	300 Cycles	22 PCS.	0/1
3	Thermal Shock	H : +100°C 5min ∫ 10 sec L : -10°C 5min	300 Cycles	22 PCS.	0/1
4	High Temperature Storage	Temp. : 100°C	1000 Hrs.	22 PCS.	0/1
5	Low Temperature Storage	Temp. : -40°C	1000 Hrs.	22 PCS.	0/1
6	DC Operating Life	I <sub>F</sub> = 20 mA / 25°C	1000 Hrs.	22 PCS.	0/1
7	High Temperature / High Humidity	85°C/ 85%RH	1000 Hrs.	22 PCS.	0/1

**Precautions For Use**

## 1. Over-current-proof

Customer must apply resistors for protection, otherwise slight voltage shift will cause big current change ( Burn out will happen ).

## 2. Storage

2.1 Do not open moisture proof bag before the products are ready to use.

2.2 Before opening the package: The LEDs should be kept at 30°C or less and 90%RH or less.

2.3 After opening the package: The LED's floor life is 1 year under 30 deg C or less and 60% RH or less.

If unused LEDs remain, it should be stored in moisture proof packages.

2.4 If the moisture absorbent material (silica gel) has faded away or the LEDs have exceeded the storage time, baking treatment should be performed using the following conditions.

Baking treatment : 60±5°C for 24 hours.

## 3. Soldering Condition

## 3.1 Pb-free solder temperature profile

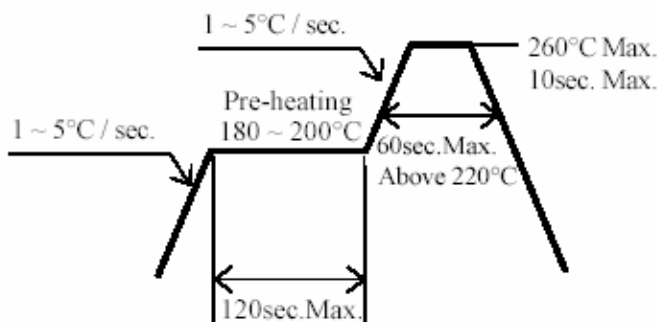

3.2 Reflow soldering should not be done more than two times.

3.3 When soldering, do not put stress on the LEDs during heating.

3.4 After soldering, do not warp the circuit board.

## 4.Soldering Iron

Each terminal is to go to the tip of soldering iron temperature less than 350°C for 3 seconds within once in less than the soldering iron capacity 25W. Leave two seconds and more intervals, and do soldering of each terminal. Be careful because the damage of the product is often started at the time of the hand solder.

**67-13/W3C-MW1X2/2T****5.Repairing**

Repair should not be done after the LEDs have been soldered. When repairing is unavoidable, a double-head soldering iron should be used (as below figure). It should be confirmed beforehand whether the characteristics of the LEDs will or will not be damaged by repairing.

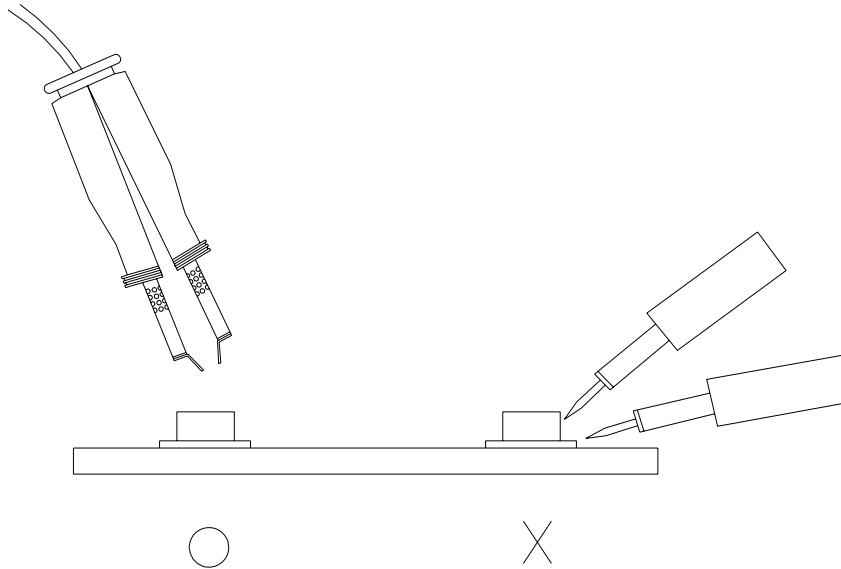

**EVERLIGHT ELECTRONICS CO., LTD.**  
Office: No 25, Lane 76, Sec 3, Chung Yang Rd,  
Tucheng, Taipei 236, Taiwan, R.O.C

Tel: 886-2-2267-2000, 2267-9936  
Fax: 886-2267-6244, 2267-6189, 2267-6306  
<http://www.everlight.com>