

Accessories

Torque supports for hollow shaft encoders

Z 119.040



Features

- Easy mounting in confined a place since no radial space required
- For applications with minimized space consumption

Mounting description

Use either rubber buffer Z 119.036 or Z 119.037 according to encoder model. Fix shoulder screw onto the mounting surface. Push encoder onto the drive shaft and position the shoulder screw in the encoder's rubber buffer.

Part number

Z 119.040 Shoulder screw M5 as torque support

Scope of delivery

Included: Shoulder screw M5

Suitable for

GI341, GI342,
G1M2H, G1MMH, G2M2H, G2MMH, GXN1H, GXP1H,
GXP6H, RXA1H

Dimensions

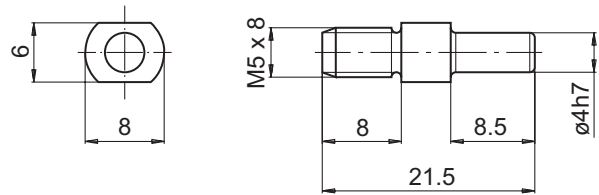

Dimension

