

Stealth Microwave's **SMTR2425-11G38** is a solid state amplifier for use in 802.11g WLAN systems. This SSPA utilizes state of the art LDMOS FET transistors which allow for more efficient operation while still meeting EVM and spectral mask requirements. Designed primarily for military use, the design can be applied for various ISM band applications as well.



Features

- LED Tx/Rx mode status indicator
- +28V Power Supply
- Rugged Weatherproof Housing
- Various DC/RF connector options available

Transmit Path	
Parameter	Specification
Frequency Range	2400-2500 MHz
802.11g Compliant Power Out	+ 38 dBm / 6W (min)
Gain	26 dB
DC Input Voltage	+ 28 Volts
DC Input Current (On Transmit)	2.1 A (6W output)
Receive Path	
Receive Gain	23 dB (can be adjusted based on requirements)
DC Input Current (On Recieve)	Approx 150 mA

Mechanical Dimensions	3.84 x 5.36 x .93 inches
RF Connectors	SMA Female
Weight	18 oz.
Operating Temperature (Baseplate)	0°C to +65°C <i>(Extended range available)</i>

TYPICAL S_{11} / S_{21} RESPONSE

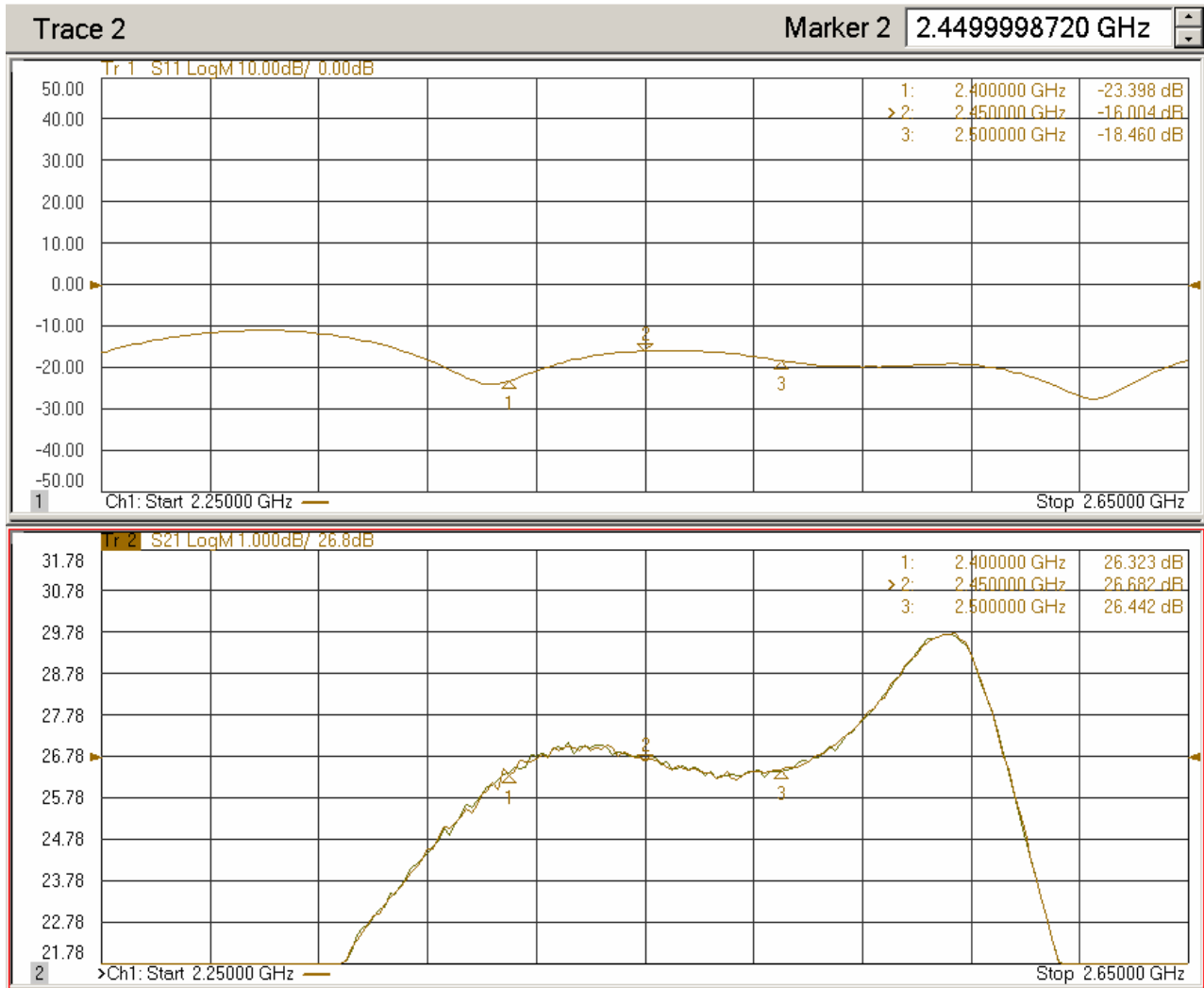

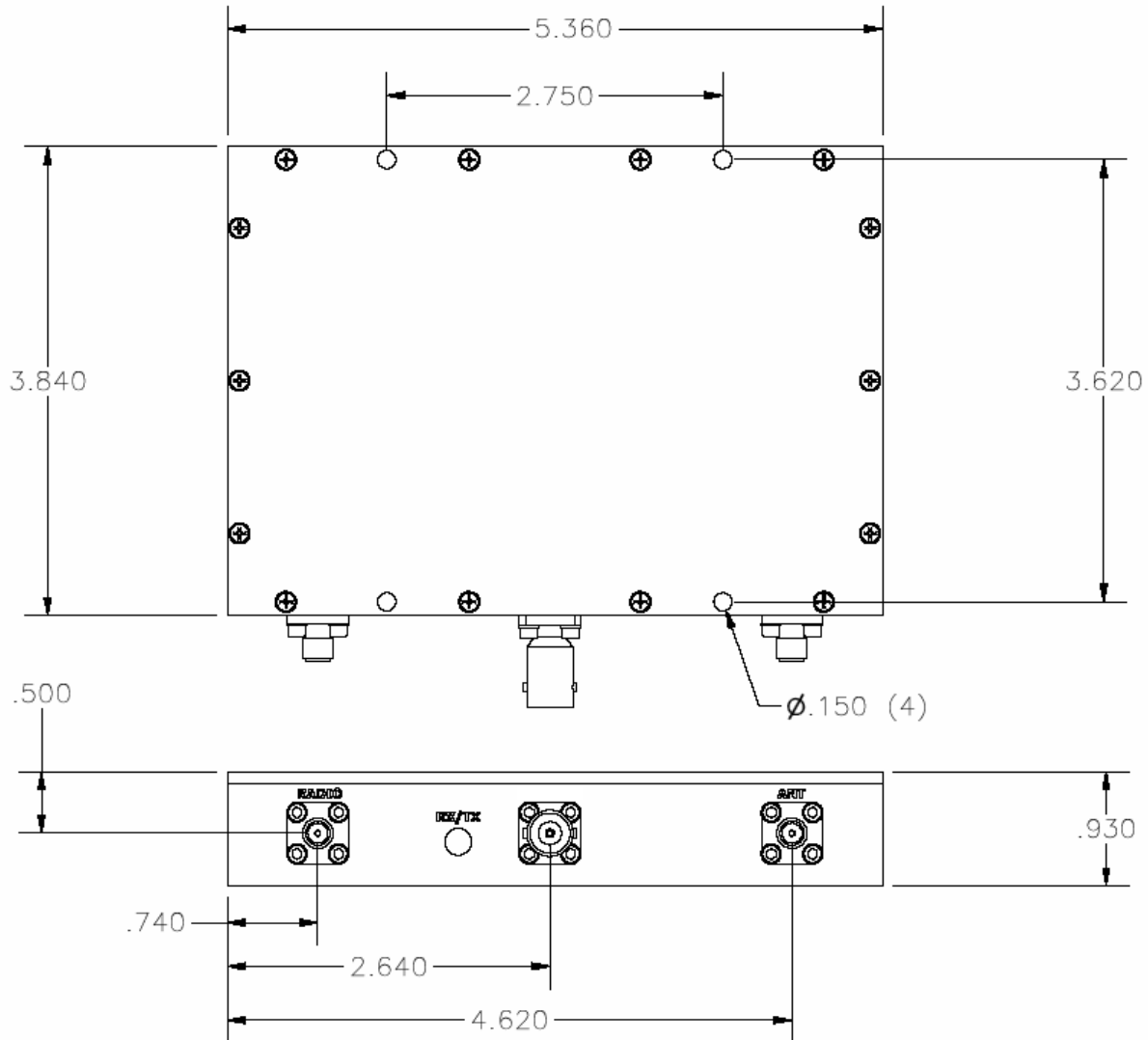
DIMENSIONS IN INCHES

Pin	Description	Values
RF INPUT	Input Connector (SMA Female)	Input power fixed per customer requirements – Typically +5 to +20dBm input
RF OUTPUT	Output Connector (SMA Female)	+38dBm max 802.11g output
GND	Ground Turret	---
+28VDC	DC Input Voltage	+ 28 Volts @ 2.1 Amperes (typ.)

Specifications subject to change without notice.