

1. CONFIGURATION & DIMENSIONS :

Style 1

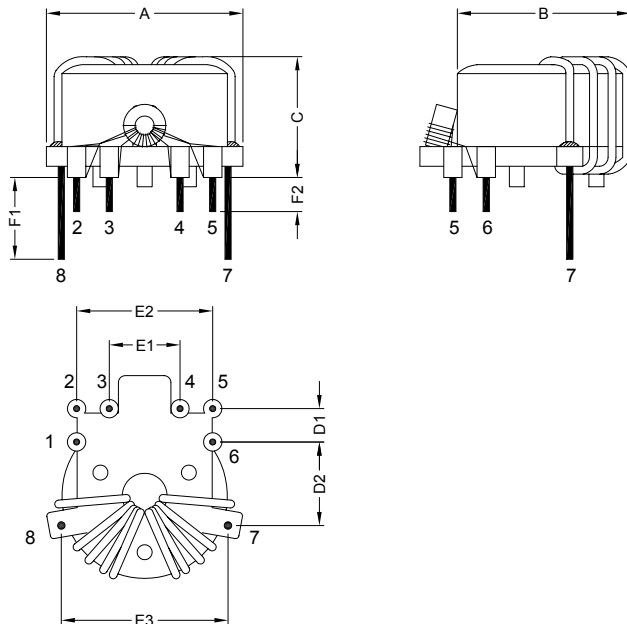

Unit : mm

Dim.	Style 1	Style 2
A	30.00 Max.	30.00 Max.
B	33.00 Max.	33.00 Max.
C	17.00 Max.	26.00 Max.
D1	5.00±0.30	5.00±0.30
D2	11.00±0.30	11.00±0.30
E1	10.00±0.30	10.00±0.30
E2	20.00±0.30	20.00±0.30
E3	24.50±0.30	24.50±0.30
F1	12.00±1.00	12.00±1.00
F2	5.00±1.00	5.00±1.00

Style 2

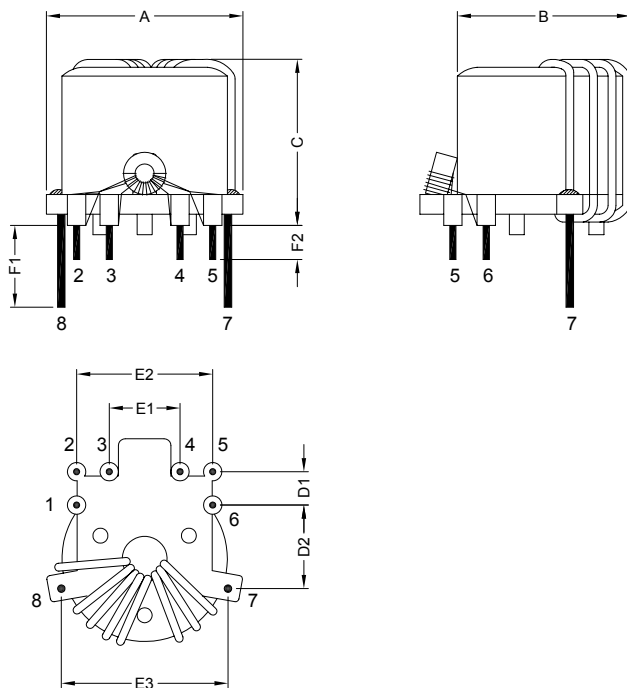

RoHS Compliant

NOTE : Specifications subject to change without notice. Please check our website for latest information.

03.06.2008

2. GENERAL SPECIFICATION :

- a) Operating temp. : -25°C to +105°C
- b) Insulation Class : B (130°C)

3. ELECTRICAL CHARACTERISTICS :

Part No.	Style	Electrical	Conditions	Test Freq.	DCR
STRC0HTF	1	L : (4-3) = 16mH Min.	-	10KHz / 50mV	(4-3) = 1.54Ω Max. @ 25°C
		L : (5-6) = 11μH Min.	-	10KHz / 50mV	(5-6) = 32.6mΩ Max. @ 25°C
		L : (2-1) = 11μH Min.	-	10KHz / 50mV	(2-1) = 32.6mΩ Max. @ 25°C
		L : (8-7) = 210μH Min.	-	10KHz / 50mV	(8-7) = 19.6mΩ Max. @ 25°C
STRC0HTF	2	L : (4-3) = 17mH Min.	-	10KHz / 50mV	(4-3) = 0.72Ω Max. @ 25°C
		L : (5-6) = 47μH Min.	-	10KHz / 50mV	(5-6) = 57.6mΩ Max. @ 25°C
		L : (2-1) = 47μH Min.	-	10KHz / 50mV	(2-1) = 57.6mΩ Max. @ 25°C
		L : (8-7) = 200μH Min.	-	10KHz / 50mV	(8-7) = 12.0mΩ Max. @ 25°C



RoHS Compliant

NOTE : Specifications subject to change without notice. Please check our website for latest information.

03.06.2008



SUPERWORLD ELECTRONICS (S) PTE LTD