

MTJH, MTJS, and MTJZ Series



- **11.7 x 9.6 SMD Package**
- **RoHS Compliant Available**
- **Voltage Control Option**
- **Wide Frequency Range**

ELECTRICAL SPECIFICATIONS:

Output	HCMOS	Clipped Sinewave	Sinewave
Frequency Range	9.600MHz to 50.000MHz		
Load	10k Ohms // 15pF	10k Ohms // 15pF	50 Ohms
Supply Current	35mA max	3mA max	25mA max
Output Level	Logic "1" = 90% of Vdd min Logic "0" = 10% of Vdd max	1.0V p-p min	7 dBm
Symmetry	See Part Numbering Guide	N/A	N/A
Freq. Stability vs Temp (Note 1)	(See Frequency Stability vs Temperature Table)		
Freq. Stability vs Aging	±1 ppm per year max		
Freq. Stability vs Voltage	±0.3 ppm with a 5% change in Vdd		
Freq. Stability vs Load	±0.3 ppm with a 10% change in Load		
Operating Range	(See Frequency Stability vs Temperature Table)		
Storage Temperature	-40°C to +85°C		
Supply Voltage (Vdd)	+3.3VDC ±5%	+5.0VDC ±5%	
Control Voltage with VC option	+1.65VDC ±1.50VDC Positive Slope	+2.50VDC ±2.00VDC Positive Slope	
Pin 1 Connection			
No Connection	No Connection		
VC Option	±10 ppm min		

Note 1: Oscillator frequency shall be ±1 ppm at +25°C ±3°C at time of shipment.

PART NUMBER GUIDE:

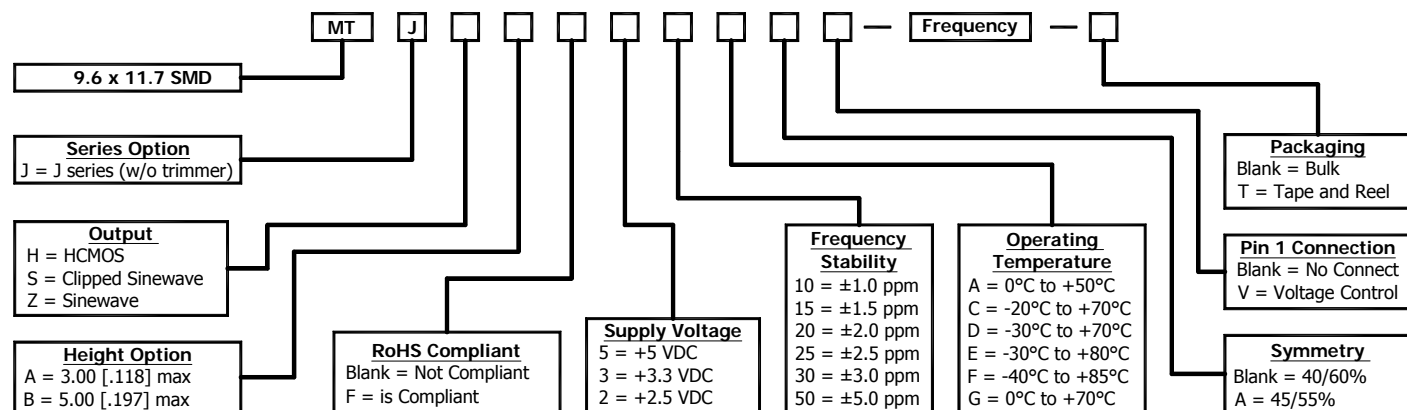

Please Consult with MMD Sales Department for any other Parameters or Options

MMD Components, 30400 Esperanza, Rancho Santa Margarita, CA, 92688
 Phone: (949) 709-5075, Fax: (949) 709-3536, www.mmdcomp.com
 Sales@mmdcomp.com

FREQUENCY STABILITY vs TEMPERATURE TABLE:

Code	Stability	10	15	20	25	30	50
	Temp	±1.0ppm	±1.5ppm	±2.0ppm	±2.5ppm	±3.0ppm	±5.0ppm
A	0°C TO +50°C	●	●	●	●	●	●
G	0°C TO +70°C	□	●	●	●	●	●
C	-20°C TO +70°C	□	□	●	●	●	●
D	-30°C TO +70°C	□	□	□	●	●	●
F	-40°C TO +85°C	□	□	□	●	●	●

● = Available

□ = Consult with the Manufacturer

MECHANICAL DIMENSIONS:

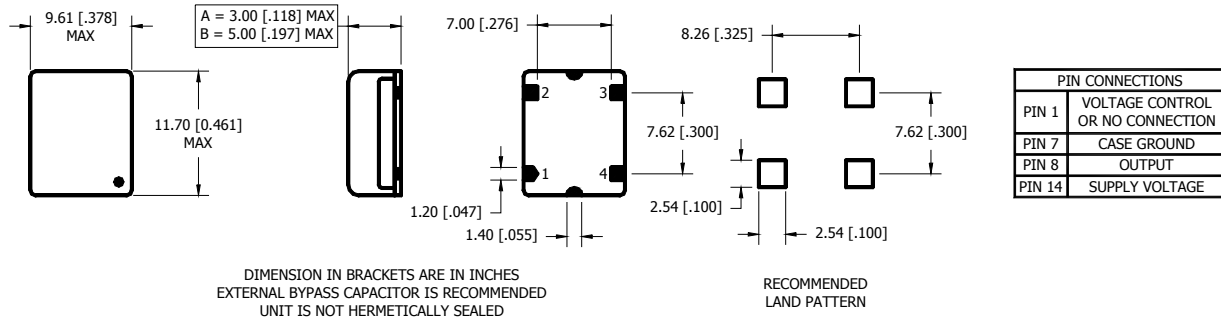

ENVIRONMENT / MECHANICAL:

Shock	MIL-STD-883, Method 2002, Condition B
Solderability	MIL-STD-883, Method 2003
Vibration	MIL-STD-883, Method 2007, Condition A

TAPE and DIMENSIONS:

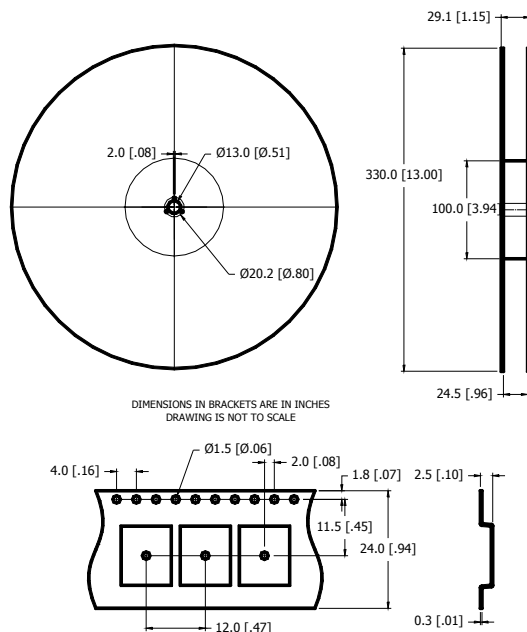

PHASE NOISE:

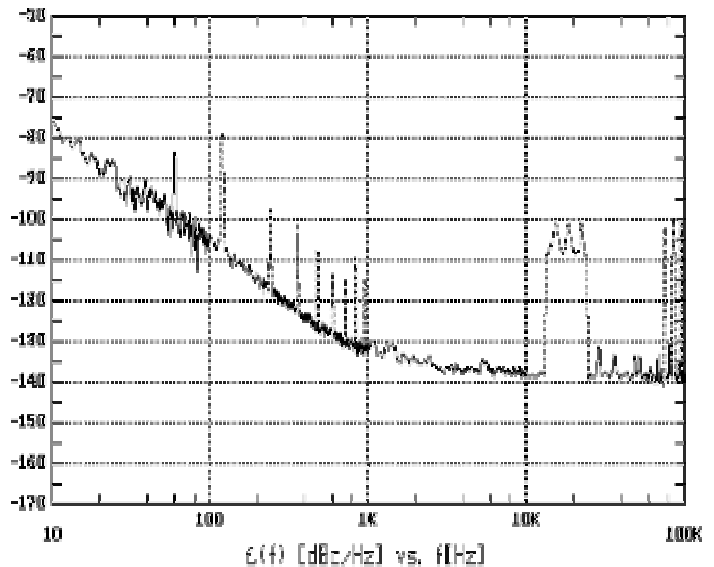

MMD Components, 30400 Esperanza, Rancho Santa Margarita, CA, 92688

Phone: (949) 709-5075, Fax: (949) 709-3536, www.mmdcomp.com

Sales@mmdcomp.com