

# SPECIFICATION FOR APPROVAL

REF : 20100118-A

PAGE: 1

PROD. NAME	RADIAL INDUCTOR	ABC'S DWG NO. ABC'S ITEM NO.	RB0608□□□□L□-□□□
---------------	-----------------	---------------------------------	------------------

## I . CONFIGURATION & DIMENSIONS :

Marking :

" ● " : Start

● 101----100 uH ( Inductance code )

A	: 5.0±0.5	m/m
B	: 6.5 <sup>+1.0</sup> <sub>-0.5</sub>	m/m
C	: 28.0±5	m/m
D	: 20.0±5	m/m
E	: 2.5 max.	m/m
F	: 2.0±0.5	m/m
Wφ	: 0.50	m/m

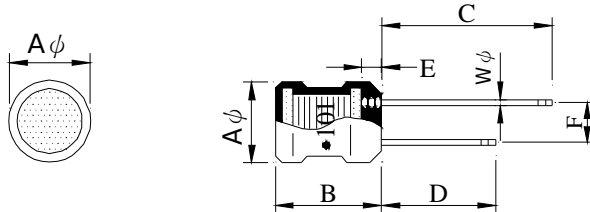

## II . SCHEMATIC DIAGRAM :



## III . MATERIALS :

- a . Coer : Ferrite DR core
- b . Wire : Enamelled copper wire (Class F)
- c . Lead : Sn/Ag/Cu
- d . Tube : Shrinkable tube 125°C , 600V
- e . Remark : Products comply with RoHS' requirements

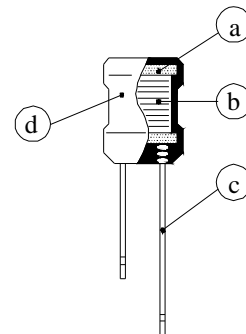

## IV . GENERAL SPECIFICATION :

- a . Temp. rise : 20°C max. at rated current.
- b . Storage temp. : -25°C ---- +85°C
- c . Operating temp. : -40°C ---- +105°C

AR-001A



千如電子集團  
ABC ELECTRONICS GROUP.

# SPECIFICATION FOR APPROVAL

REF: 20100118-A

PAGE: 2

PROD. NAME	RADIAL INDUCTOR	ABC'S DWG NO.	RB0608□□□□L□-□□□
		ABC'S ITEM NO.	

## V . ELECTRICAL CHARACTERISTICS :

DWG No.	Inductance ( $\mu$ H)	Q min.	Test Freq. ( MHz )		SRF ( MHz ) min.	RDC ( $\Omega$ ) max.	IDC ( mA ) max.
			L	Q			
RB06081R0ML□-□□□	1.0 $\pm$ 20%	60	7.96		105.0	0.10	1030
RB06081R2ML□-□□□	1.2 $\pm$ 20%	60	7.96		90.0	0.15	980
RB06081R5ML□-□□□	1.5 $\pm$ 20%	60	7.96		75.0	0.20	920
RB06081R8ML□-□□□	1.8 $\pm$ 20%	60	7.96		70.0	0.22	880
RB06082R2ML□-□□□	2.2 $\pm$ 20%	60	7.96		65.0	0.24	830
RB06082R7ML□-□□□	2.7 $\pm$ 20%	60	7.96		60.0	0.27	790
RB06083R3ML□-□□□	3.3 $\pm$ 20%	60	7.96		50.0	0.30	750
RB06083R9ML□-□□□	3.9 $\pm$ 20%	60	7.96		45.0	0.30	720
RB06084R7ML□-□□□	4.7 $\pm$ 20%	60	7.96		40.0	0.35	670
RB06085R6KL□-□□□	5.6 $\pm$ 10%	60	7.96		35.0	0.35	640
RB06086R8KL□-□□□	6.8 $\pm$ 10%	60	7.96		30.0	0.40	620
RB06088R2KL□-□□□	8.2 $\pm$ 10%	60	7.96		25.0	0.40	590
RB0608100KL□-□□□	10.0 $\pm$ 10%	60	2.52		20.0	0.45	550
RB0608120KL□-□□□	12.0 $\pm$ 10%	60	2.52		15.0	0.50	530
RB0608150KL□-□□□	15.0 $\pm$ 10%	60	2.52		13.0	0.55	500
RB0608180KL□-□□□	18.0 $\pm$ 10%	60	2.52		11.0	0.60	480
RB0608220KL□-□□□	22.0 $\pm$ 10%	60	2.52		10.0	0.65	460
RB0608270KL□-□□□	27.0 $\pm$ 10%	50	2.52		9.0	0.75	430
RB0608330KL□-□□□	33.0 $\pm$ 10%	50	2.52		8.0	0.85	410
RB0608390KL□-□□□	39.0 $\pm$ 10%	50	2.52		7.5	0.90	390
RB0608470KL□-□□□	47.0 $\pm$ 10%	50	2.52		7.0	1.00	370
RB0608560KL□-□□□	56.0 $\pm$ 10%	50	2.52		6.5	1.20	350
RB0608680KL□-□□□	68.0 $\pm$ 10%	50	2.52		6.0	1.30	340
RB0608820KL□-□□□	82.0 $\pm$ 10%	50	2.52		5.5	1.50	320
RB0608101KL□-□□□	100.0 $\pm$ 10%	50	0.796		5.0	1.70	305
RB0608121KL□-□□□	120.0 $\pm$ 10%	50	0.796		4.8	1.90	290
RB0608151KL□-□□□	150.0 $\pm$ 10%	50	0.796		4.4	2.10	275
RB0608181KL□-□□□	180.0 $\pm$ 10%	50	0.796		4.2	2.30	235
RB0608221KL□-□□□	220.0 $\pm$ 10%	45	0.796		3.8	2.50	200
RB0608271KL□-□□□	270.0 $\pm$ 10%	45	0.796		3.6	2.75	180
RB0608331KL□-□□□	330.0 $\pm$ 10%	45	0.796		3.3	4.68	165
RB0608391KL□-□□□	390.0 $\pm$ 10%	45	0.796		3.0	6.00	150
RB0608471KL□-□□□	470.0 $\pm$ 10%	55	0.796		2.8	6.50	140
RB0608561KL□-□□□	560.0 $\pm$ 10%	55	0.796		2.4	8.50	135
RB0608681KL□-□□□	680.0 $\pm$ 10%	55	0.796		2.2	9.00	125
RB0608821KL□-□□□	820.0 $\pm$ 10%	55	0.796		2.0	9.60	120
RB0608102KL□-□□□	1000.0 $\pm$ 10%	55	0.252		1.8	11.50	100

1). □ : Packafing information... [A]: Bulk

2). "-□□□":Reference code

AR-001A





# SPECIFICATION FOR APPROVAL

REF : 20100118-A

PAGE: 4

PROD. NAME	RADIAL INDUCTOR	ABC'S DWG NO.	RB0608□□□□L□-□□□
		ABC'S ITEM NO.	

**VII . UL CARD :**

OBMW2 September 8, 2000

Magnet Wire-Component

JUNG SHING WIRE CO LTD E174837

231 CHUNG CHENG RD, SEC 3 JEN-TEH HSIANG, TAINAN

HSIEN TAIWAN

Mtl Dsg	Mark Dsg	BC	Coat Typ	OC	ANSI Type	Temp Class
AIW	---	Polyamideimide	---	---	MW81-C	220
CFUEWB	---	Polyurethane	---	---	MW75C	130
EIAIW	---	Polyesterimide	Polyamideimide	---	MW35C	200
EILOCKY	---	Polyesterimide	Polyamide	---	---	180
EILOCKW	---	Polyesterimide	Modified Polyesterimide	---	---	200
			Epoxy	---	---	220
EIW	---	Polyesterimide	---	---	---	200
EIW-2	---	Polyesterimide	---	---	MW74-C	155
FL.EILOCKY	---	Modified Polyester	Polyamide	---	---	155
LSFFW	---	Polyurethane	---	---	MW79-C	155
LSUEW	---	Polyurethane	---	---	---	130
PEW	---	Polyester	---	---	---	155
PEY	---	Polyester	Nylon	---	MW24-C	155
SF.FLW	---	Modified Polyester	---	---	MW26C	155
SF.EIW	---	Polyesterimide	---	---	MW77C	180
SF.BY@	---	Modified Polyester	Nylon	---	MW27-C	155
SF.FLY@	---	Modified Polyester	Nylon	---	MW27-C	155
SF.BLOCKBS	---	Modified Polyester	Modified Polyesterimide	---	---	155
SF.EILOCKY#	---	Polyesterimide	Polyamide	---	---	180
SF.EILOCKBS	---	Polyesterimide	Polyamide	---	---	180
			Modified Polyesterimide	---	---	180
SF.BW@	---	Modified Polyester	---	---	MW26C	155
SFFW	---	Polyurethane	---	---	MW79	155

287806002 Page 1 of 2

A not-for-profit organization dedicated to public safety and committed to quality service

Mtl Dsg	Mark Dsg	BC	Coat Typ	OC	ANSI Type	Temp Class
SFFY	---	Polyurethane	Polyamide	---	MW80C	155
UEW-1	---	Polyurethane	---	---	MW2-C	105
UEW-2	---	Polyurethane	---	---	---	130
UEW-4	---	Polyurethane	---	---	MW75C	130
UEY	---	Polyurethane	Nylon	---	MW28-C	130
UEY-2	---	Polyurethane	Polyamide	---	MW28-C	130

@-May be suffixed by LZ; # - May be suffixed by LZ, EL or LZL.  
 LZ - Signifies magnet wires twisted together; EL - signifies base coated magnet wire laid parallel with top coat applied overall; LZL - signifies base coated magnet wire twisted together and covered with top coat overall.

Marking: Company name or trademarks or 榮星電線, material designation or marked designation on packaed or reel, and Recognized Component Mark.

See General Information Preceding These Recognitions  
 For use only in equipment where the acceptability of the combination is determined by Underwriters Laboratories Inc.

287806002 Page 2 of 2

OBMW2E174837  
September 8, 2000

AR-001A

