

1. Mechanical Dimensions:

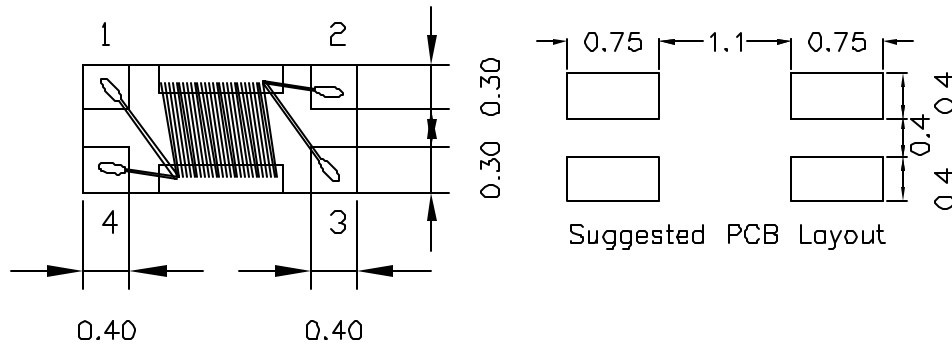

2. Schematic:

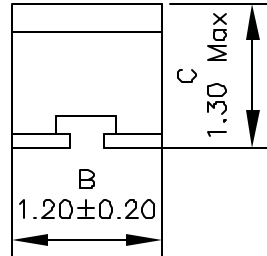
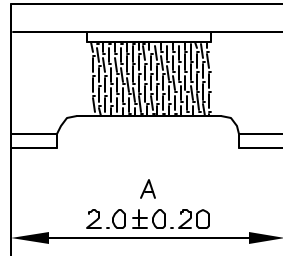
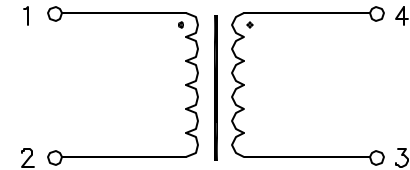

3. Electrical Specifications:

Common Mode Impedance: 120 Ohms±25% @100MHz

Rated Current: 370mA

Rated Voltage: 50Vdc

DCR: 0.30 Ohms Max

Insulation Resistance: 10 MOhms

Withstand Voltage: 125Vdc

Notes:

1. Solderability: Leads shall meet MIL-STD-202, Method 208D for solderability.
2. Flammability: UL94V-0
3. ASTM oxygen index: > 28%
4. Insulation System: Class F 155°C, UL file E151556
5. Operating Temperature Range: All listed parameters are to be within tolerance from -40°C to +85°C
6. Storage Temperature Range: -55°C to +125°C
7. Aqueous wash compatible
8. SMD Lead Coplanarity: ±0.004*(0.102mm)
9. Moisture Sensitivity: Level 3
10. Electrical and mechanical specifications 100% tested
11. RoHS Compliant Component

DOC. REV: A/2

PROPRIETARY Document is the property of XFMRS Group & is not allowed to be duplicated without authorization.

| | | | |
|----------------------------------------------------------------------------|--|-----------------------------|-----------|
| XFMRS Inc www.XFMRS.com | | Title: Common Mode Choke | |
| UNLESS OTHERWISE SPECIFIED TOLERANCES: .xx ±0.20 Dimensions in MM | | P/N: XFWCMC201213-121 | REV A |
| | | DWN. 李小锋 | Mar-13-08 |
| Scale 2.5:1 SHT 1 OF 1 | | CHK. 康玉坤 | Mar-13-08 |
| | | APP. BW | Mar-13-08 |