

# Schematic:

(One of Two)

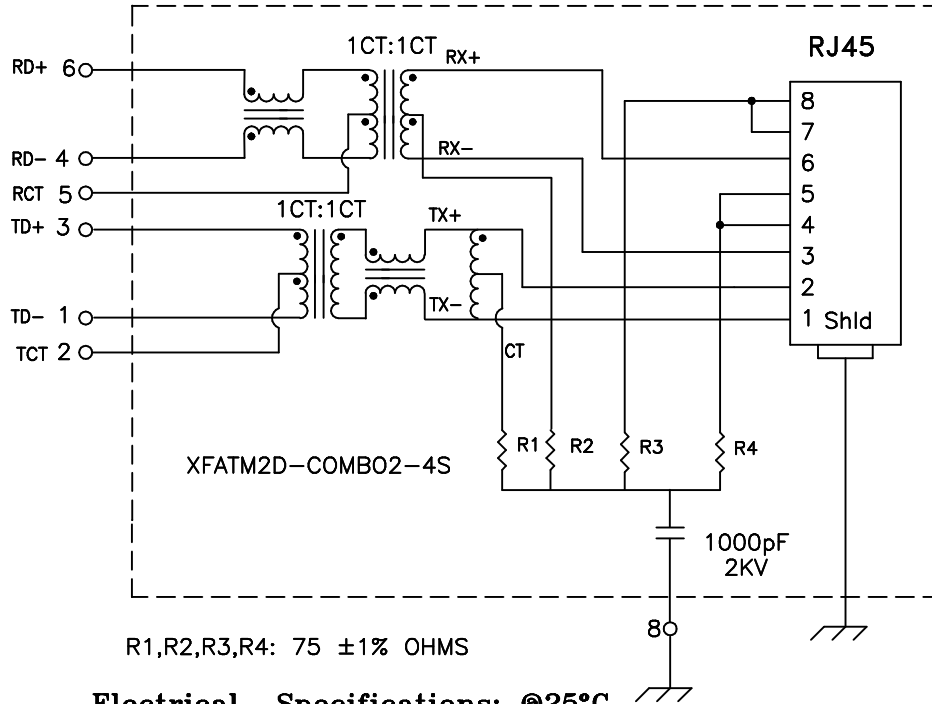

## Electrical Specifications: @25°C

- Isolation Voltage: 1500 Vrms (INPUT to OUTPUT)
- UTP SIDE OCL: 350uH Min @100KHz 100mV 8mA DC
- Rise Time (10-90%): 2.5ns Typical
- Insertion Loss (100KHz-100MHz): -1.1dB Maximum
- Insertion Loss (100MHz-125MHz): -1.5dB Maximum
- Return Loss: -20dB Typ @30MHz  
-15dB Typ @80MHz
- Crosstalk:
  - 100KHz-60MHz -40dB Typical
  - 60MHz-100MHz -38dB Typical
- Common Mode to Differential Mode Rejection:
  - 100KHz-60MHz -45dB Typ (Tx) / -40dB Typ (Rx)
  - 60MHz-100MHz -40dB Typ (Tx) / -35dB Typ (Rx)

### Notes:

1. Solderability: Leads shall meet MIL-STD-202, Method 208D for solderability.
2. Flammability: UL94V-0
3. ASTM oxygen index: > 28%
4. Insulation System: Class F 155°C. UL file E151556
5. Operating Temperature Range: -40°C to +85°C

<b>XFMRs Inc.</b>		Title: <b>SINGLE PORT COMBO</b>	
UNLESS OTHERWISE SPECIFIED TOLERANCES: .xxx ±0.010 Dimensions in Inch	XFATM2D-COMBO2-4S		REV. A
	DWN.	李小锋	Jan-31-02
	CHK.	廖玉坤	Jan-31-02
	APP.	Isaiah M	Jan-31-02
SHEET 1 OF 2			

DOC. REV A/2

# Mechanical Dimensions: (FOR COMB02-4S)

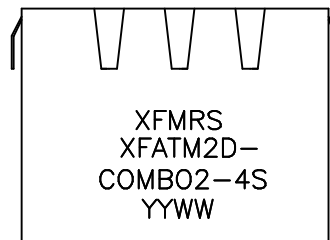
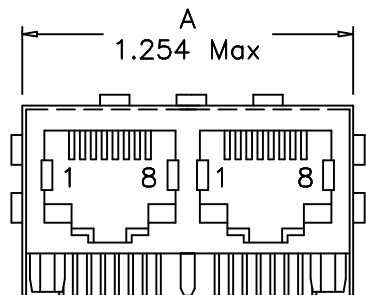

TOP VIEW

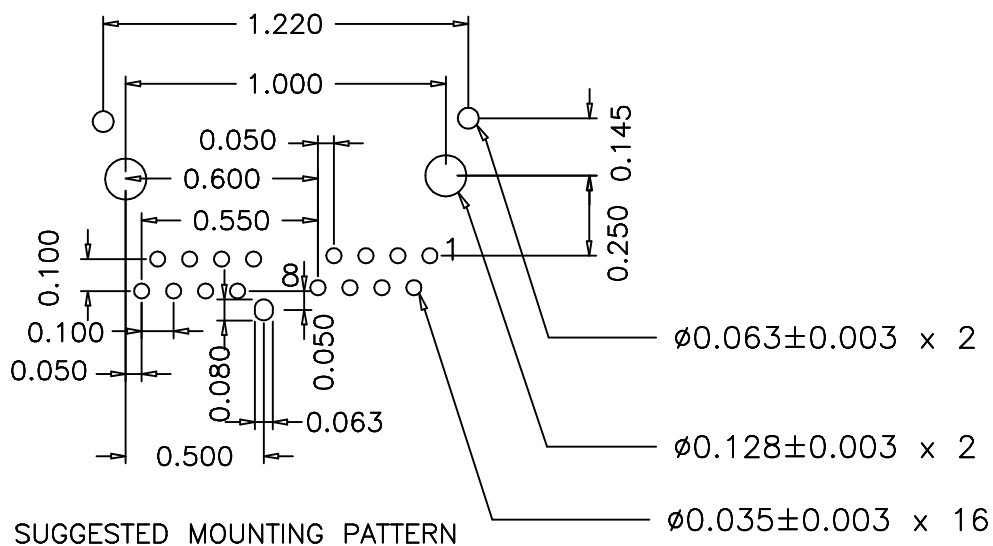
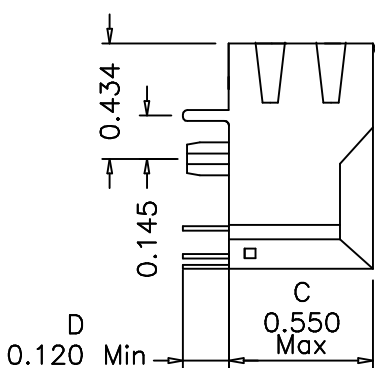
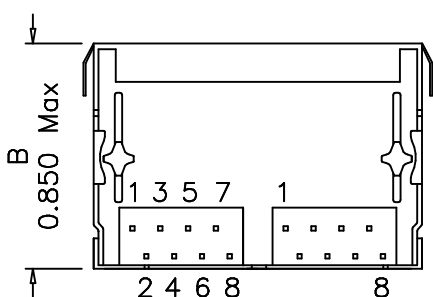

<b>XFMRS Inc.</b>	Title: Mechanical Dimensions For COMB02-4S Series	
	P/N: XFATM2D-COMB02-4S	REV. A
UNLESS OTHERWISE SPECIFIED TOLERANCES: .xxx ±0.010 Dimensions in Inch	DWN.	李小锋 Jan-31-02
	CHK.	廖玉坤 Jan-31-02
	APP.	Isaiah M Jan-31-02
SHEET 2 OF 2		

DOC REV: A/2