

2-Way Power Divider

P/N: JXWBGF-T-2-0-3000

Frequency Range(GHz)	DC-3
Insertion Loss(dB)	15
Power(W)	1 max
VSWR	1.4 max
Connector	N-Female
Operating Temperature(°C)	-40 ~ +70
Storage Temperature(°C)	-55 ~ +85
Size(mm)	32x32x20

Outline Drawing

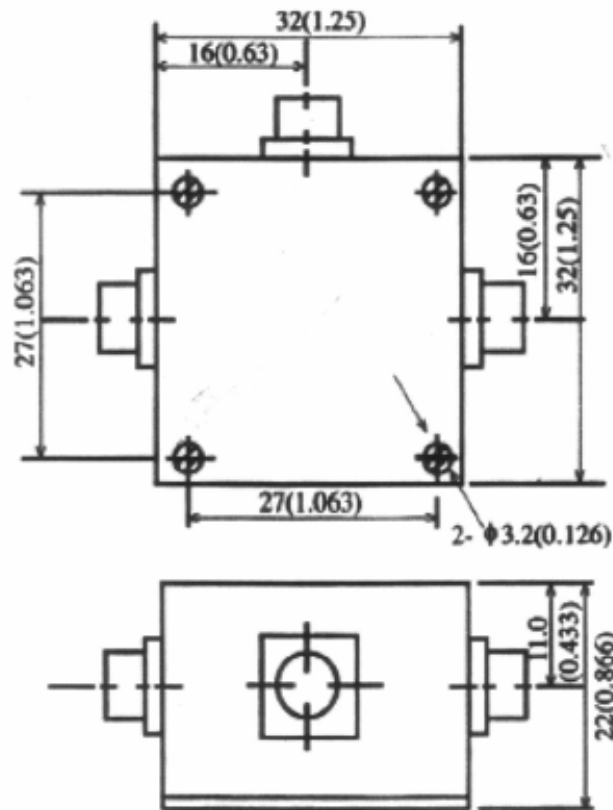

For current data sheets, please contact: sales@aacix.com