



TAI-SAW TECHNOLOGY CO., LTD.

No. 3, Industrial 2nd Rd., Ping-Chen Industrial District,
Taoyuan, 324, Taiwan, R.O.C.

TEL: 886-3-4690038 FAX: 886-3-4697532

E-mail: tstsales@mail.taisaw.com Web: www.taisaw.com

Approval Sheet For Product Specification

Issued Date:

Product Name: SAW Filter 285MHz SMD 5.0×5.0 mm

TST Parts No.:TA0486A

Customer Parts No.:_____

Company: _____
Division: _____
Approved by : _____
Date: _____

Checked by: _____ Asin Lin

Approval by: _____ Francis Chen

Date: _____ 2005/06/01



TAI-SAW TECHNOLOGY CO., LTD.

No. 3, Industrial 2nd Rd., Ping-Chen Industrial District,
Taoyuan, 324, Taiwan, R.O.C.

TEL: 886-3-4690038 FAX: 886-3-4697532

E-mail: tstsales@mail.taisaw.com Web: www.taisaw.com

SAW Filter 285 MHz

MODEL NO.: TA0486A

REV. NO.:1

A. MAXIMUM RATING:

1. Input Power Level: 0 dB_m
2. DC voltage: 5 V
3. Operating Temperature: -10°C to +50°C
4. Storage Temperature: -40°C to +85°C

RoHS Compliant
Lead free
Lead-free soldering

B. ELECTRICAL CHARACTERISTICS:

Characteristics	Specification			Note	
	Unit	Min.	Typ.		Max.
Center frequency F_c (MHz)		-	285	-	1
I.L. (Within $F_c \pm 4$ MHz) (dB)		-	2.5	4.5	
Pass band BW_{3dB} (MHz)		8.0	12	-	1
Ripple(Within $F_c \pm 4$ MHz) (dB)		-	1.2	2.0	1
Attenuation:(Reference level from 0 dB)					
$F_c - 100$ MHz to -37.5 MHz (dB)		48	52	-	1
$F_c + 37.5$ MHz to $+ 100$ MHz (dB)		48	52	-	
Impedance at F_c ; Input $Z_{IN} = R_{IN} // C_{IN}$			150 Ω // 0 Pf		2
Output $Z_{OUT} = R_{OUT} // C_{OUT}$			150 Ω // 0 Pf		2

Note1. The standard definitions is in JIS C 6703

Note2.

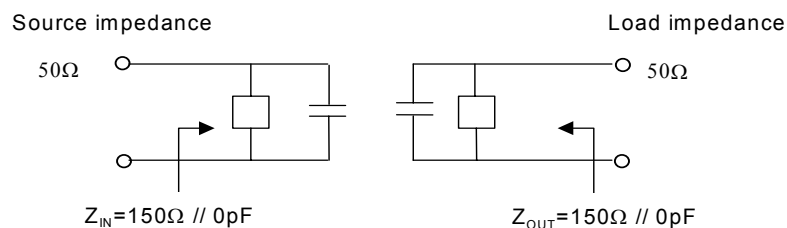

C. Frequency Characteristics :

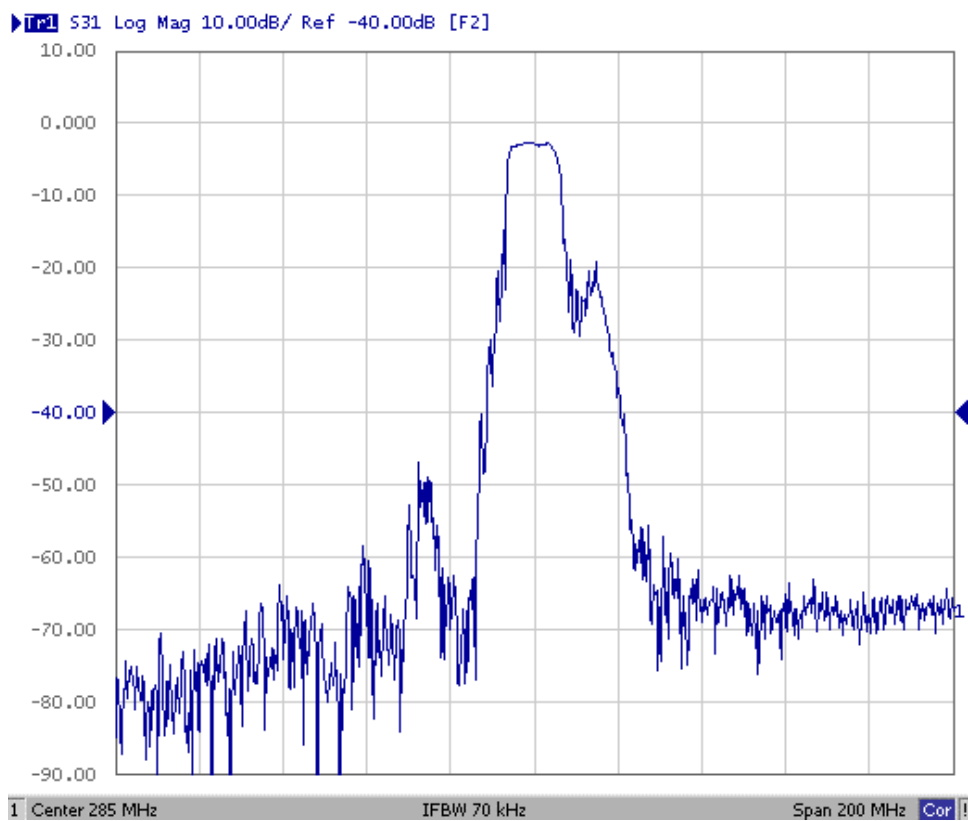
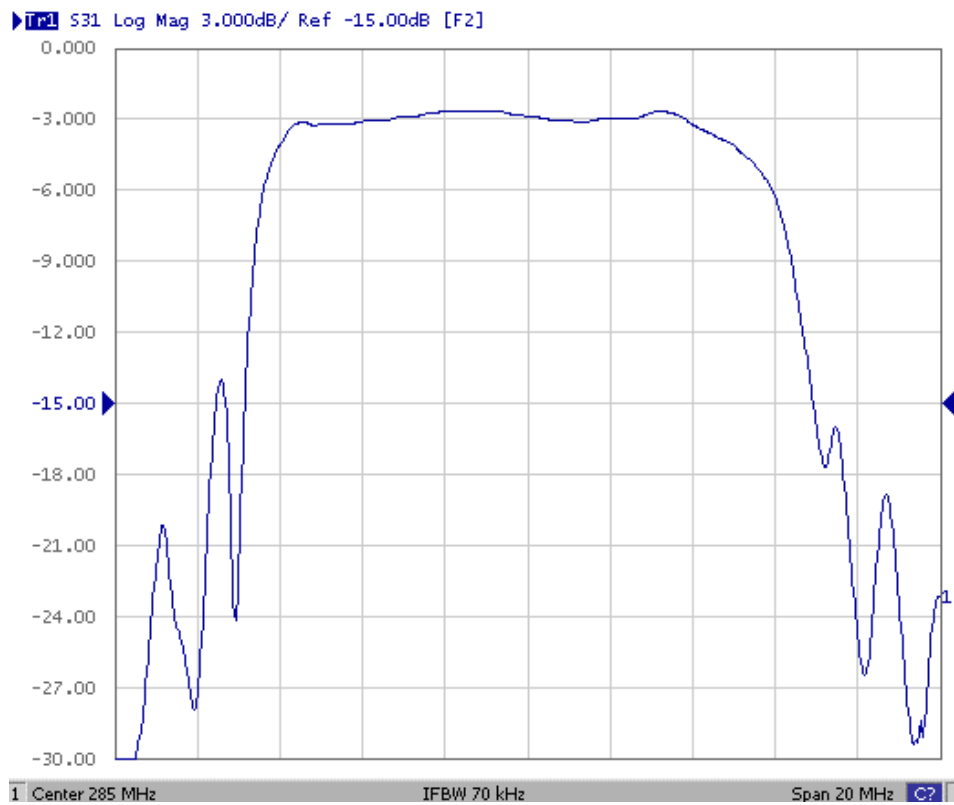

D. MEASUREMENT CIRCUIT:

Network analyzer

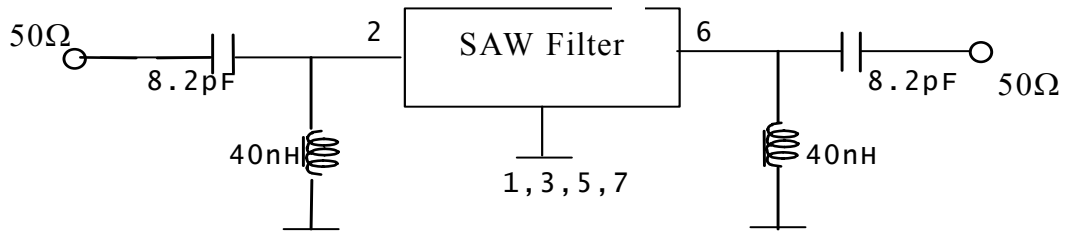

E. OUTLINE DRAWING:

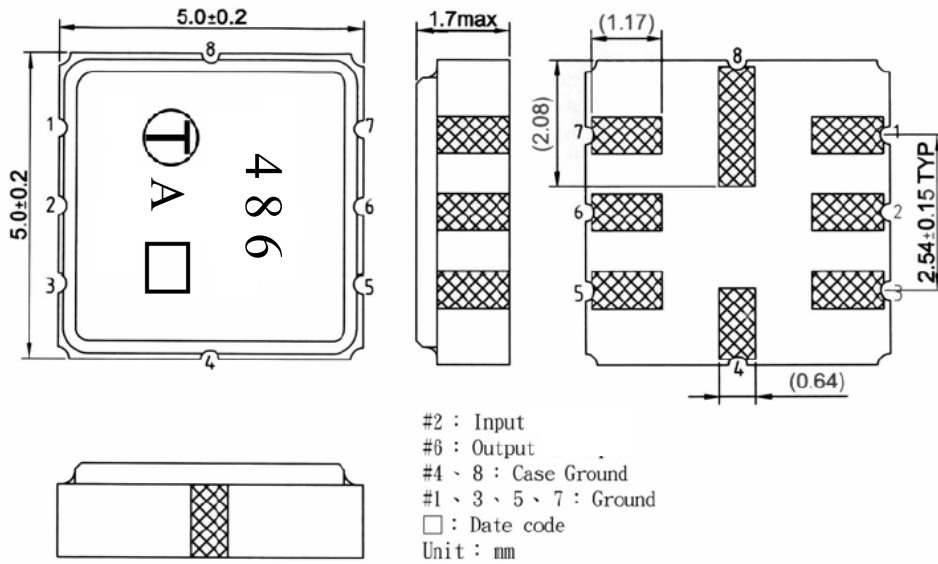

F. PCB FOOTPRINT:

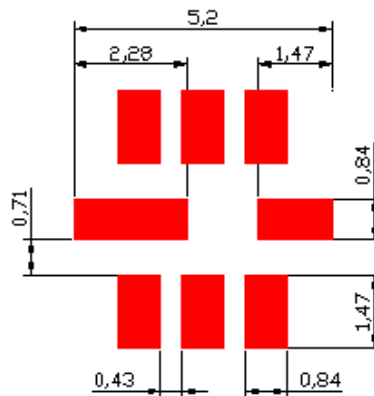

G. PACKING:

1. REEL DIMENSION

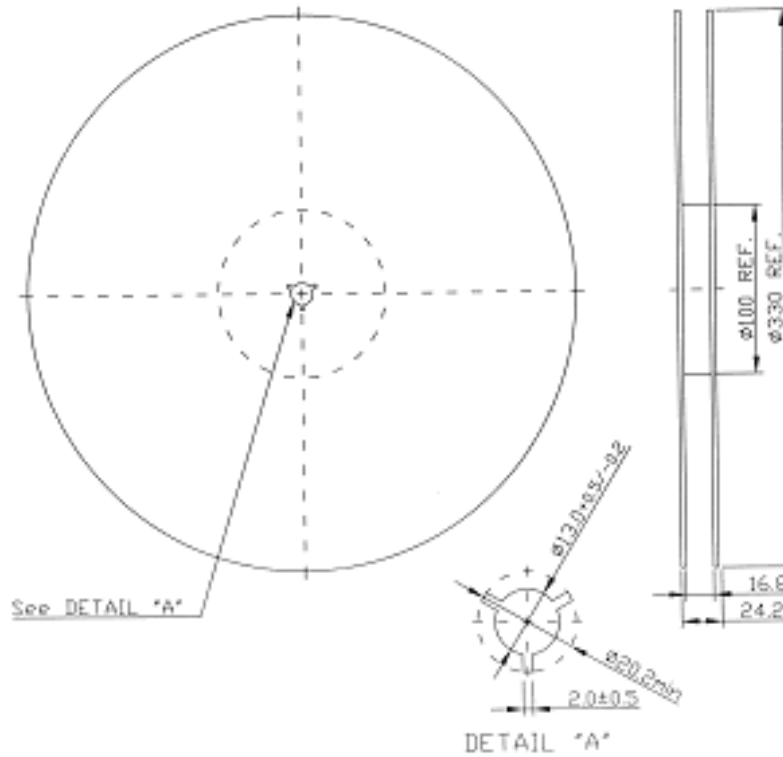

2. TAPE DIMENSION

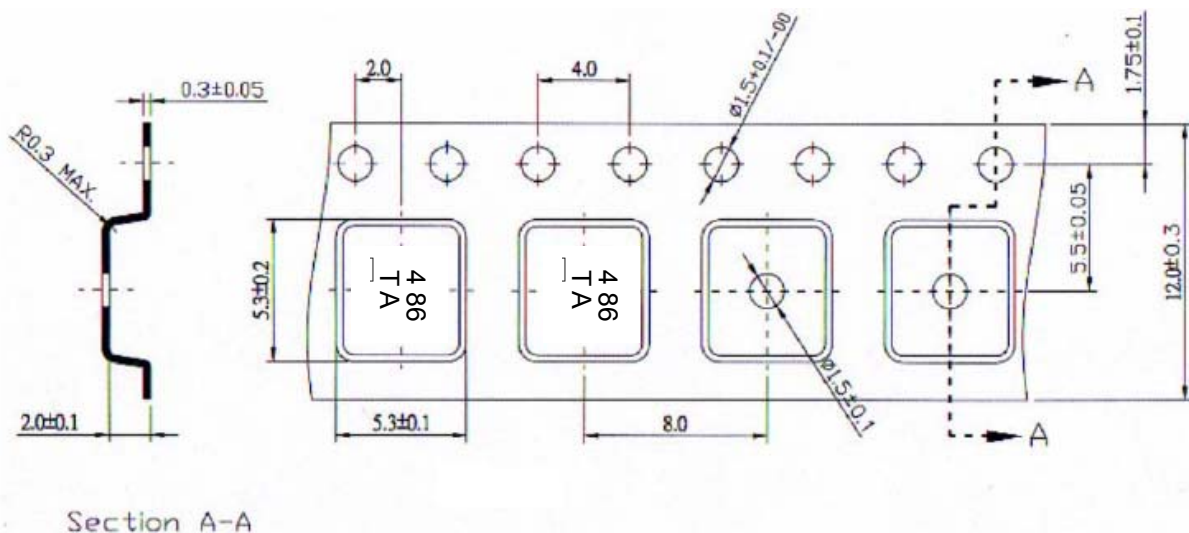

Direction of Feed

