

CTDR3 Series

From 1.0 μH to 4,700 μH

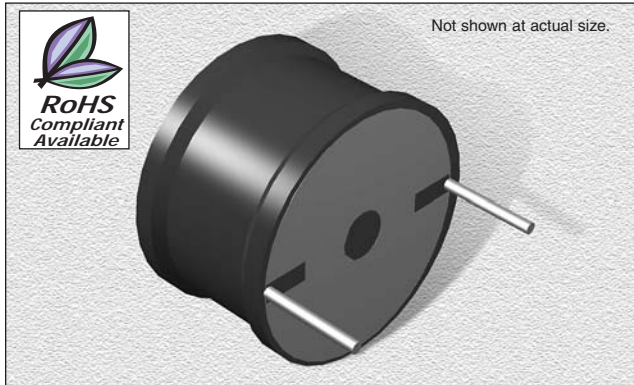

CHARACTERISTICS

- Description:** Radial leaded drum core inductor
- Applications:** Used in switching regulators, power amplifiers, power supplies, SCR and Triac controls, speaker crossover networks, RFI suppression and filters
- Operating Temperature:** -25°C to +85°C
- Temperature Rise:** 50°C Max. at IDC
- IDC:** Current at which inductance drops 10% Max.
- Inductance Tolerance:** $\pm 10\%$, $\pm 20\%$
- Testing:** Inductance is tested on an HP4284A at 1.0 kHz
- Packaging:** Bulk pack
- Sleeving:** Coils finished with UL-VW-1 sleeving
- Mounting:** Center hole furnished for mechanical mounting
- Miscellaneous:** RoHS Compliant available. Non-standard tolerances and other values available.
- Additional Information:** Additional electrical & physical information available upon request
- Samples available. See website for ordering information.**

SPECIFICATIONS

Parts numbers indicate available tolerance.

K = $\pm 10\%$, M = $\pm 20\%$

CTDR3E Please specify "F" for RoHS compliant.

Part Number	Inductance (μH)	L Test Freq. (kHz)	DCR Max. (Ω)	IDC Max. (A)
CTDR3_-1R0M	1.0	1.0	.003	21
CTDR3_-1R2M	1.2	1.0	.003	21
CTDR3_-1R5M	1.5	1.0	.003	21
CTDR3_-2R2M	2.2	1.0	.003	21
CTDR3_-2R7M	2.7	1.0	.003	21
CTDR3_-3R3M	3.3	1.0	.003	21
CTDR3_-3R9M	3.9	1.0	.003	21
CTDR3_-4R7M	4.7	1.0	.003	21
CTDR3_-5R6M	5.6	1.0	.003	21
CTDR3_-6R8M	6.8	1.0	.004	21
CTDR3_-8R2M	8.2	1.0	.004	21
CTDR3_-100M	10	1.0	.006	17
CTDR3_-120K	12	1.0	.008	13.5
CTDR3_-150K	15	1.0	.009	13.5
CTDR3_-180K	18	1.0	.010	13.5
CTDR3_-220K	22	1.0	.011	13.5
CTDR3_-270K	27	1.0	.012	13.5
CTDR3_-330K	33	1.0	.017	13.5
CTDR3_-390K	39	1.0	.022	11.4
CTDR3_-470K	47	1.0	.024	9.0
CTDR3_-560K	56	1.0	.026	9.0
CTDR3_-680K	68	1.0	.029	9.0
CTDR3_-820K	82	1.0	.032	9.0
CTDR3_-101K	100	1.0	.034	9.0
CTDR3_-121K	120	1.0	.046	7.2
CTDR3_-151K	150	1.0	.064	5.5
CTDR3_-181K	180	1.0	.072	5.5
CTDR3_-221K	220	1.0	.080	5.5
CTDR3_-271K	270	1.0	.110	4.5
CTDR3_-331K	330	1.0	.122	4.5
CTDR3_-391K	390	1.0	.169	4.0
CTDR3_-471K	470	1.0	.187	4.0
CTDR3_-561K	560	1.0	.205	4.0
CTDR3_-681K	680	1.0	.256	2.8
CTDR3_-821K	820	1.0	.288	2.8
CTDR3_-102K	1000	1.0	.426	2.0
CTDR3_-122K	1200	1.0	.462	2.0
CTDR3_-152K	1500	1.0	.518	2.0
CTDR3_-182K	1800	1.0	.705	1.6
CTDR3_-222K	2200	1.0	1.02	1.3
CTDR3_-272K	2700	1.0	1.14	1.3
CTDR3_-332K	3300	1.0	1.27	1.3
CTDR3_-392K	3900	1.0	1.67	1.0
CTDR3_-472K	4700	1.0	1.86	1.0

PHYSICAL DIMENSIONS

Size	A Max.	B Max.	C	D Typ.	E
mm	22.0	28	15 \pm 2	4.0	22.0
inches	0.87	1.1	0.59 \pm 0.08	0.16	0.87

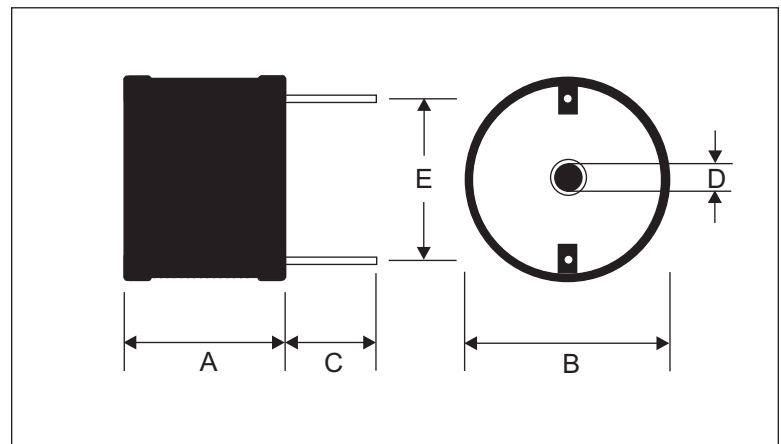

08.25.06