

1. PART NO. EXPRESSION :

<u>R</u>	<u>C</u>	<u>B</u>	<u>1</u>	<u>6</u>	<u>2</u>	<u>0</u>	<u>1</u>	<u>0</u>	<u>0</u>	<u>M</u>	<u>Z</u>	<u>F</u>
(a)	(b)	(c)	(d)	(e)	(f)							
			(a) Series code						(d) Tolerance code : K = ±10%, M = ±20%			
			(b) Dimension code						(e) X, Y, Z : Standard part			
			(c) Inductance code : 100 = 10uH						(f) F : Lead Free			

2. CONFIGURATION & DIMENSIONS :

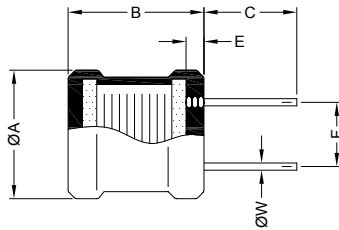

Unit:m/m

ØA	B	C	E	F	ØW
16.0 Max.	20.0 Max.	15.0±5.0	3.0 Max.	8.0±1.5	1.0±0.1

3. SCHEMATIC :

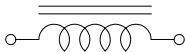

4. MATERIALS :

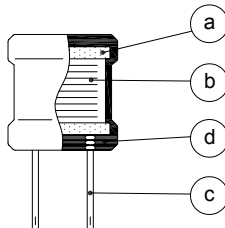

- (a) Core : DR Ferrite Core
- (b) Wire : Enamelled Copper Wire
- (c) Lead : Tinned Copper Wire
- (d) Tube : Shrinkable Tube

5. GENERAL SPECIFICATION :

- a) The inductance drop at rated current is 10% max.
- b) Temp. rise : 45°C at rated current
- c) Storage temp. : -40°C to +125°C
- d) Operating temp. : -25°C to +80°C



RoHS Compliant

NOTE : Specifications subject to change without notice. Please check our website for latest information.

25.04.2008



SUPERWORLD ELECTRONICS (S) PTE LTD

6. ELECTRICAL CHARACTERISTICS :

Part No.	Inductance (μH)	Test Frequency (Hz)	RDC (Ω) Max.	IDC (A) Max.
RCB1620100MZF	10 \pm 20%	1K / 1V	0.024	5.0
RCB1620250KZF	25 \pm 10%	1K / 1V	0.040	4.0
RCB1620500KZF	50 \pm 10%	1K / 1V	0.060	3.0
RCB1620101KZF	100 \pm 10%	1K / 1V	0.090	2.0
RCB1620251KZF	250 \pm 10%	1K / 1V	0.180	1.5
RCB1620501KZF	500 \pm 10%	1K / 1V	0.400	1.0
RCB1620102KZF	1000 \pm 10%	1K / 1V	0.800	0.7

RECOMMENDED SOLDERING CONDITIONS REFLOW SOLDERINGS

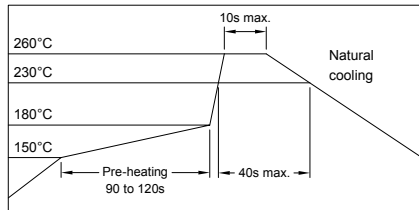

RoHS Compliant

NOTE : Specifications subject to change without notice. Please check our website for latest information.

25.04.2008



SUPERWORLD ELECTRONICS (S) PTE LTD

7. CHARACTERISTICS CURVES :

@ TEMP. RISE VS. DC SUPERPOSITION RESPONSE CURVE

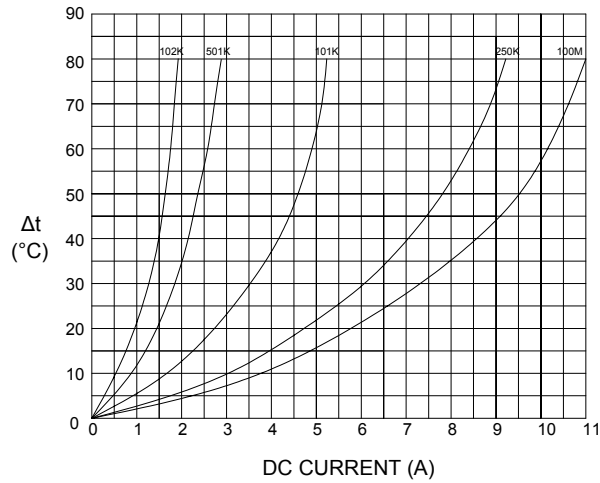

@ INDUCTANCE VS. FREQUENCY RESPONSE CURVE

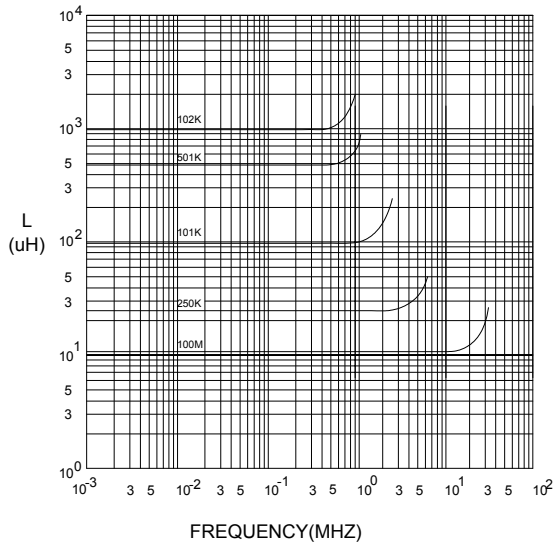

@ INDUCTANCE VS. DC SUPERPOSITION RESPONSE CURVE

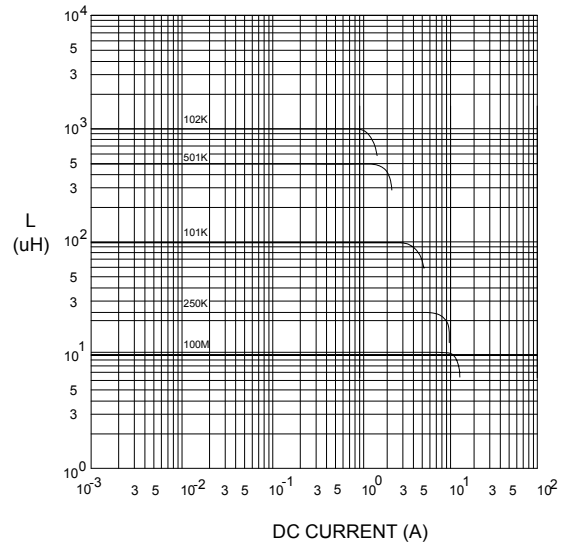

RoHS Compliant

NOTE : Specifications subject to change without notice. Please check our website for latest information.

25.04.2008



SUPERWORLD ELECTRONICS (S) PTE LTD

RADIAL CHOKE COIL

RCB1620 SERIES

8. UL CARD :

OBMW2 **November 30, 2000**
Magnet Wire - Component

PACIFIC ELECTRIC WIRE & CABLE (SHENZHEN) CO LTD **E201757**
 607 BAOLONG INDUSTRIAL ESTATE LONGGANG, SHENZHEN
 GUANGDONG CHINA

Mtl Dsg	Coating Type		ANSI Type	TI
UEW/U	BC	Polyurethane	—	130
PEW/U		Polyester	—	155°C
PEWH/U		Modified Polyester	—	180
PEW-NY/U		Polyester	Polyamide	155
HAI/U	Polyester(Amide)(Imide)		Polyamideimide	200
UEW-NY/U		Polyurethane	Polyamide	155
			MW28-C	130

Marking: Company name and material designation or marked designation on package or reel, and Recognized Component Mark.

See General Information Preceding These Recognitions

1/3/2001 Underwriters Laboratories Inc. Card 1 of 2

YDPU8 **August 18, 1999**
Tubing Extruded Insulating Certified For Canada - Component

SHENZHEN CHANGBAO SPECIAL PLASTIC PRODUCTS CO LTD **E180908**
 SHENZHEN SCIENCE & INDUSTRY PARK NAN SHAN
 SHENZHEN, GUANGDONG 518057 CHINA

Cat. No.	Max V	Max Temp C	Col. Recognized	Max Temp Rated Oil Resistance *C	OFT Rated #
Polyolefin heat shrinkable tubing.					
Changbao 102	600	125	All	—	Yes

#Tubing is considered to comply with the optional OFT flammability requirements only if it is so marked.

Marking: Company name, catalog number and temperature rating in degrees C appears on tubing, tags attached to both ends of the tubing or on the shipping spool label or smallest unit container and the Recognized Component Mark for Canada .

See General Information Preceding These Recognitions
 For use only in equipment where the acceptability of the combination is determined by Underwriters Laboratories Inc.

8/31/1999 Underwriters Laboratories Inc. Card 1 of 1



RoHS Compliant

NOTE : Specifications subject to change without notice. Please check our website for latest information.

25.04.2008



SUPERWORLD ELECTRONICS (S) PTE LTD