

### 1. Mechanical Dimensions:

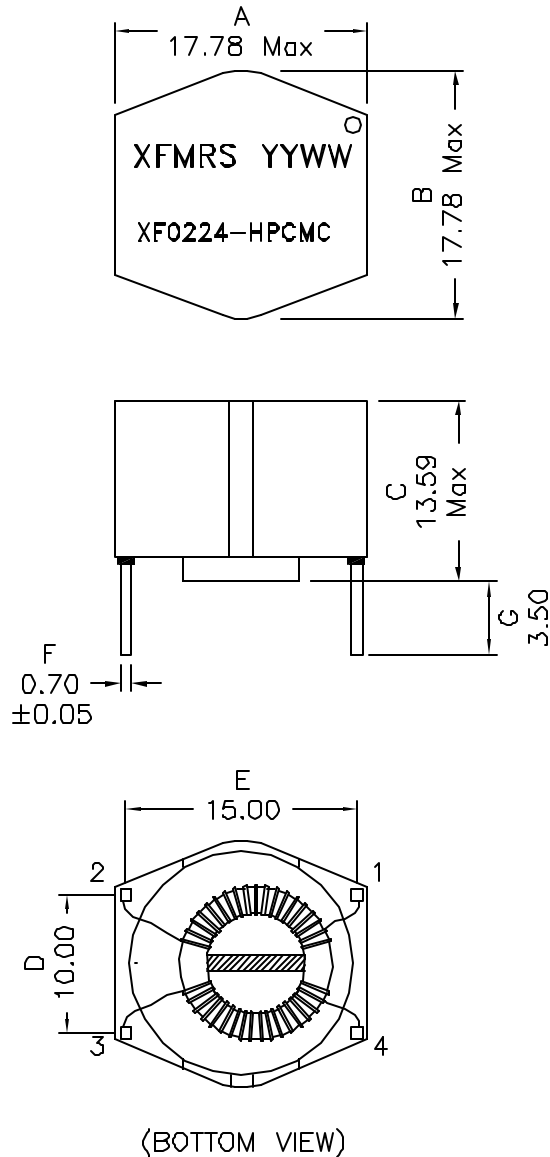

### 2. Schematic:

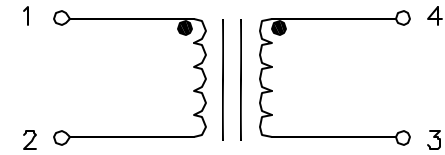

### 3. Electrical Specifications: @25°C

OCL: 2.2mH ±30% @10KHz 0.05V, Each Wdg (0°C to +85°C)  
 1.2mH Min @10KHz 0.05V, Each Wdg (0°C to -40°C)  
 DCR: 0.070 Ohms Max, Each Wdg  
 LL: 25uH Max @100KHz 0.1V  
 Rated Current: 2.5Amps  
 Isolation Voltage: 1500Vac, Wdg to Wdg  
 Rated Voltage: 250VAC

Notes:

1. Solderability: Leads shall meet MIL-STD-202G, Method 208H for solderability.
2. Flammability: UL94V-0
3. ASTM oxygen Index: > 28%
4. Insulation System: Class F 155°C. UL file E151556
5. All listed parameters are to be within tolerance from -40°C to +85°C unless otherwise noted.
6. Storage Temperature Range: -55°C to +125°C
7. Aqueous wash compatible
8. Electrical and mechanical specifications 100% tested
9. RoHS Compliant Component

DOC REV: A/3

<b>XFMRS Inc.</b> www.XFMRS.com	Title: Common Mode Choke			
	UNLESS OTHERWISE SPECIFIED TOLERANCES:	P/N: XF0224-HPCMC	REV. A	
.xx ±0.25	DWN.	Xianyi	Sep-18-09	
Dimensions in MM	CHK.	YK Liao	Sep-18-09	
SHEET 1 OF 1	APP.	Joe Huff	Sep-18-09	

**PROPRIETARY**

Document is the property of XFMRS Group & is not allowed to be duplicated without authorization.