

HSR-0025TSM Micro SMD Reed Switch



Electrical Characteristics

Contact form		A
Contact material		Durel
Contact rating max.	W / VA	0.25
Switching current max.	A	0.01
Carry current max.	A	0.01
Switching voltage max.	VDC	30
	VAC	30
Breakdown voltage min.	VDC	80
Contact resistance (initial) max.	mΩ	500
Isolation resistance min.	Ω	10 ⁹
Capacitance typ.	pF	0.7

Magnetical Characteristics

Pull in range available ¹	AT	2-15
--------------------------------------	----	------

¹ AT range stated for unmodified Reed Switch

Operating Characteristics

Operate time (incl. bounce) max.	ms	0.3
Release time max.	ms	0.2
Switching frequency max.	Hz	900
Resonant frequency typ.	Hz	10,000
Vibration (50-2000 Hz)	g	15
Shock (1/2 sin 11 ms)	g	75
Operating temperature	°C	-40 to +125

Dimensions

in mm

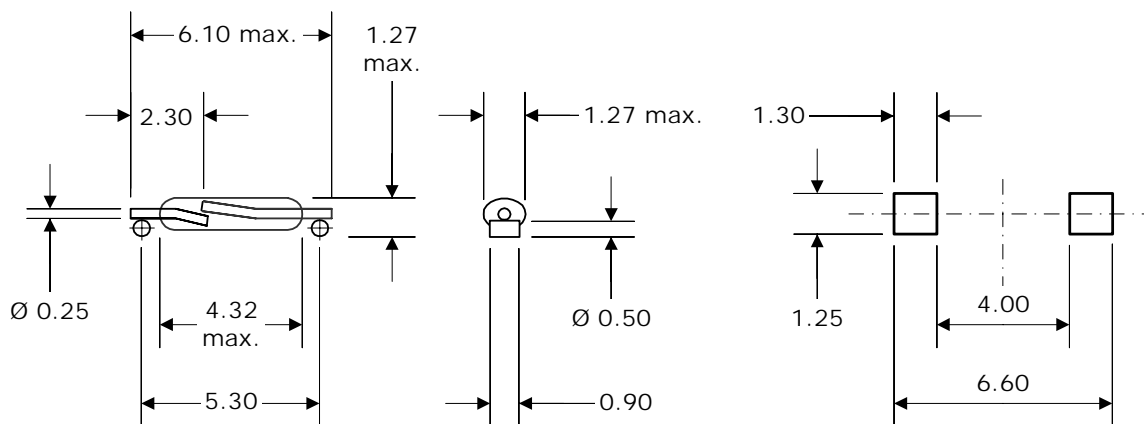

Recommended pad size