

PLEASE CHECK WWW.MOLEX.COM FOR LATEST PART INFORMATION

Part Number: [0359771400](#)
Status: **Planned for Obsolescence**
Overview: [mv396](#)
Description: 3.96mm (.156") Pitch Wire-to-Board Housing, Positive Lock, 14 Circuits, White, Glow Wire Compatible

Documents:

[3D Model](#) [Product Specification PS-35979-001 \(PDF\)](#)
[Drawing \(PDF\)](#) [RoHS Certificate of Compliance \(PDF\)](#)

Agency Certification

CSA LR19980

General

Product Family Crimp Housings
 Series [35977](#)
 Overview [mv396](#)
 Product Name MV-396™

Physical

Circuits (maximum) 14
 Color - Resin White
 Flammability 94V-0
 Gender Female
 Glow-Wire Compliant No
 Keying to Mating Part None
 Lock to Mating Part Yes
 Material - Resin Nylon
 Number of Rows 1
 Packaging Type Bag
 Panel Mount No
 Pitch - Mating Interface (in) 0.156 In
 Pitch - Mating Interface (mm) 3.96 mm
 Polarized to Mating Part Yes
 Stackable Yes
 Temperature Range - Operating -25°C to +85°C

Electrical

Current - Maximum per Contact 7A

Material Info

Reference - Drawing Numbers

Packaging Specification PK-35977-001
 Product Specification PS-35979-001
 Sales Drawing SD-35977-001

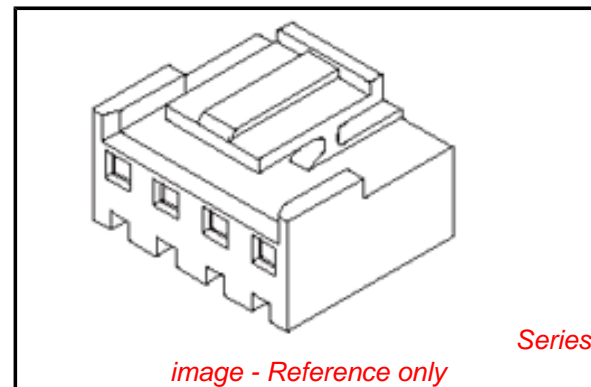

EU RoHS

**ELV and RoHS
 Compliant
 REACH SVHC
 Not Reviewed
 Halogen-Free
 Status
 Not Reviewed**

China RoHS



**Need more information on product
 environmental compliance?**

Email productcompliance@molex.com
 For a multiple part number RoHS Certificate of Compliance, [click here](#)

Please visit the [Contact Us](#) section for any non-product compliance questions.

Search Parts in this Series

[35977Series](#)

Mates With

Wire-to-Board Header [35978](#) , [35979](#)

Use With

Wire-to-Board Terminal [35922](#)



NOTES

- 1. USED WITH TERMINAL : 35922-9002
- 2. MATED WITH HEADER ASS'Y : 35978-**1*(PA66) 35978-**2*(PA66)

35977-****

- COLOR : 0 - WHITE
- 1 - BLACK
- 2 - RED
- 3 - YELLOW
- 4 - BLUE

MATERIAL 0 : PA66 (E) 9 : PC/PET
 CURCUIT NO. (02,03,04...)

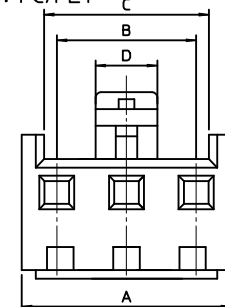
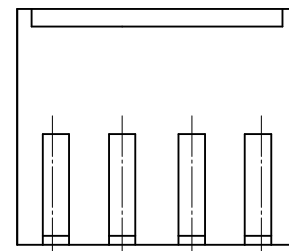

* 2~3 CIRCUITS ONLY *

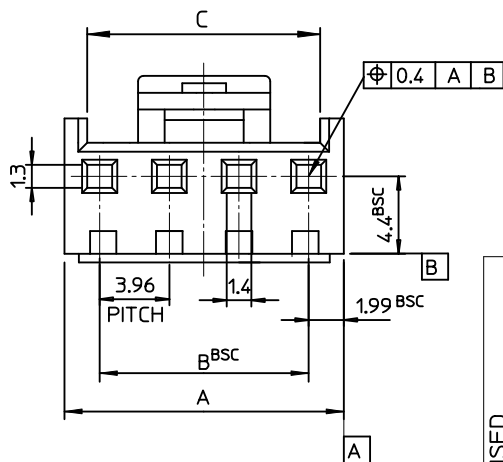

| | | | | | | |
|-------|-------|-------|-------|-----------|------------|----------|
| 19.9 | 56.88 | 55.44 | 59.42 | 3597715** | 35977-15** | 15 |
| 19.9 | 52.92 | 51.48 | 55.46 | 3597714** | -14** | 14 |
| 19.9 | 48.96 | 47.52 | 51.5 | 3597713** | -13** | 13 |
| 19.9 | 45.0 | 43.56 | 47.54 | 3597712** | -12** | 12 |
| 19.9 | 41.04 | 39.6 | 43.58 | 3597711** | -11** | 11 |
| Ⓜ19.9 | 37.08 | 35.64 | 39.62 | 3597710** | -10** | 10 |
| 17.7 | 33.12 | 31.68 | 35.66 | 3597709** | -09** | 9 |
| 15.7 | 29.16 | 27.72 | 31.70 | 3597708** | -08** | 8 |
| 13.7 | 25.20 | 23.76 | 27.74 | 3597707** | -07** | 7 |
| 7.5 | 21.24 | 19.80 | 23.78 | 3597706** | -06** | 6 |
| | 17.28 | 15.84 | 19.82 | 3597705** | -05** | 5 |
| | 13.32 | 11.88 | 15.86 | 3597704** | -04** | 4 |
| | 9.36 | 7.92 | 11.90 | 3597703** | -03** | 3 |
| 3.5 | 5.4 | 3.96 | 7.94 | 3597702** | 35977-02** | 2 |
| D | C | B | A | MAT'L NO | ENG NO. | CIRCUITS |

| | | | | | | |
|--|-----------------|--|-----------------|---|--------------------------------------|------------------------|
| REVISED EC NO: KOR2009-0137 DRAWN: JHPARK01 2009/05/21 CHKD: WY YANG 2009/05/21 APPR: YUNSIKKIM 2009/05/22 | QUALITY SYMBOLS | GENERAL TOLERANCES (UNLESS SPECIFIED) | DIMENSION STYLE | SCALE | DESIGN UNITS | THIRD ANGLE PROJECTION |
| | | mm INCH 4 PLACES ± --- ± --- 3 PLACES ± --- ± --- 2 PLACES ± --- ± --- 1 PLACE ± 0.30 ± --- ANGULAR ± 2 ° | MM ONLY | 3:1 | METRIC | |
| | DESCRIPTION | DRAFT WHERE APPLICABLE MUST REMAIN WITHIN DIMENSIONS | DRAWN BY | DATE | 3.96 PITCH W-T-B CONN. HOUSING | |
| | REV | | YR.WI | 1999/05/06 | MOLEX INCORPORATED | |
| | | JH.OH | 1999/05/06 | SD-35977-001 | | |
| | | CW.LEE | 1999/05/06 | SHEET NO. 1 OF 01 | | |
| | | | | THIS DRAWING CONTAINS INFORMATION THAT IS PROPRIETARY TO MOLEX INCORPORATED AND SHOULD NOT BE USED WITHOUT WRITTEN PERMISSION | | |