

PLEASE CHECK WWW.MOLEX.COM FOR LATEST PART INFORMATION

Part Number: [0945291201](#)
Status: **Active**
Description: Fork Type for PCB Edge Mating, Vertical Crimp Terminal, Reel, Tin (Sn) Brass

Documents:

Drawing (PDF)	Product Specification PS-94529-002 (PDF)
Product Specification PS-94529-001 (PDF)	RoHS Certificate of Compliance (PDF)

Agency Certification

CSA	LR19980
UL	E29179

General

Product Family	Crimp Terminals
Series	94529
Comments	For PCB Edge Mounting in White Goods
Crimp Quality Equipment	Yes
Product Name	Fork Terminal, One Piece

Physical

Flammability	94V-0
Gender	Female
Material - Metal	Brass
Material - Plating Mating	Tin
Material - Plating Termination	Tin
Packaging Type	Reel
Plating min: Mating (µin)	120.00
Plating min: Mating (µm)	3.000
Plating min: Termination (µin)	120.00
Plating min: Termination (µm)	3.00
Termination Interface: Style	Crimp or Compression
Wire Insulation Diameter	2.00-2.80mm(.079"-.110")
Wire Size AWG	18, 20
Wire Size mm²	0.50 TO 1.00

Material Info

Reference - Drawing Numbers

Product Specification	PS-94529-001, PS-94529-002
Sales Drawing	SD-94529-001

EU RoHS

**ELV and RoHS
Compliant**
**REACH SVHC
Not Reviewed**
**Halogen-Free
Status
Not Reviewed**

China RoHS



**Need more information on product
environmental compliance?**

Email productcompliance@molex.com
 For a multiple part number RoHS Certificate of
 Compliance, [click here](#)

Please visit the [Contact Us](#) section for any
 non-product compliance questions.

Search Parts in this Series

[94529Series](#)

CODICE P/N	MATERIALE TERMINALE	FINITURA PLACCA	SEZ. FILLO WIRE SIZE	ISOLANTE INSULATION	26.2 mm				PACCHETTO 15.0 g. L'AVVOLGIMENTO * per bobina in 6 bobine * per bobina in 6 metri
					A	B	C	D	
94529-1103	BRONZO FOSFORATO PHOSPHOR BRONZE	PRESTADIMATO	0.30-0.50	1.70 max.	1.9	2.7	2.7	2.7	24.000
94529-1201	OTTONE BRASS	TW PREPLATED	0.50-1.00	2.80 max.	3.0	2.9	4.0	4.5	21.000

* FILLO AD ISOLAMENTO RIDOTTO
* LOW RESISTANCE WIRE

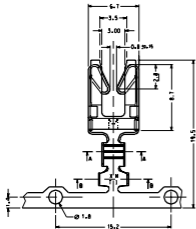

SENDO DI SVOLGIMENTO DALLA BOBINA
DIRECTION OFF REEL

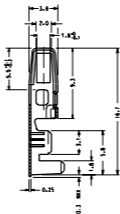

SECTION A - A



SECTION B - B

CARATTERISTICHE PRODOTTO SECONDO PS-94529-001
PRODUCT CHARACTERISTICS ACCORDING TO PS-94529-001

Std. Descr: "FORM TERM STRAIGHT 1.5 GAP (inner) WIRE SIZE"

EC NO. Z2002-0020 DIN 9130 EN 60302-1 EN 60302-2 EN 60302-3 EN 60302-4 EN 60302-5 EN 60302-6 EN 60302-7 EN 60302-8 EN 60302-9 EN 60302-10 EN 60302-11 EN 60302-12 EN 60302-13 EN 60302-14 EN 60302-15 EN 60302-16 EN 60302-17 EN 60302-18 EN 60302-19 EN 60302-20 EN 60302-21 EN 60302-22 EN 60302-23 EN 60302-24 EN 60302-25 EN 60302-26 EN 60302-27 EN 60302-28 EN 60302-29 EN 60302-30 EN 60302-31 EN 60302-32 EN 60302-33 EN 60302-34 EN 60302-35 EN 60302-36 EN 60302-37 EN 60302-38 EN 60302-39 EN 60302-40 EN 60302-41 EN 60302-42 EN 60302-43 EN 60302-44 EN 60302-45 EN 60302-46 EN 60302-47 EN 60302-48 EN 60302-49 EN 60302-50 EN 60302-51 EN 60302-52 EN 60302-53 EN 60302-54 EN 60302-55 EN 60302-56 EN 60302-57 EN 60302-58 EN 60302-59 EN 60302-60 EN 60302-61 EN 60302-62 EN 60302-63 EN 60302-64 EN 60302-65 EN 60302-66 EN 60302-67 EN 60302-68 EN 60302-69 EN 60302-70 EN 60302-71 EN 60302-72 EN 60302-73 EN 60302-74 EN 60302-75 EN 60302-76 EN 60302-77 EN 60302-78 EN 60302-79 EN 60302-80 EN 60302-81 EN 60302-82 EN 60302-83 EN 60302-84 EN 60302-85 EN 60302-86 EN 60302-87 EN 60302-88 EN 60302-89 EN 60302-90 EN 60302-91 EN 60302-92 EN 60302-93 EN 60302-94 EN 60302-95 EN 60302-96 EN 60302-97 EN 60302-98 EN 60302-99 EN 60302-100	QUALITY STANDARD	GENERAL TOLERANCES UNLESS SPECIFIED	SCALE 1:1	DESIGN UNITS mm	FIRST ANGLE PROJECTION	DIMENSIONS:				REV	
						mm	inch	mm	inch		mm
4 PLACES ± 0.10	1.										
2 PLACES ± 0.10	2.										
1 PLACE ± 0.15	3.										
APPROVED BY & DATE Previato 05-03-93											
CAS FILENAME SP94529001.DGN											
QUALITY CONTROL REV. 1											
THIS DRAWING CONTAINS INFORMATION THAT IS PROPRIETARY TO MOLEX INCORPORATED AND SHOULD NOT BE USED WITHOUT WRITTEN PERMISSION.											

TITolo: CONTATTO A FORCELLA DIRITTO
- SPESSORE NOM. DEL MASCHIO: 1.5 mm -
STRAIGHT FORM TERMINAL 1.5mm WIRE SIZE: 1.5 mm

MATERIAL NO. DRAWING NO.
vedi tabella 90-94529-001

MATERIAL NO. DRAWING NO.
vedi tabella 90-94529-001

1/1

SIZE

A.1