

PLEASE CHECK WWW.MOLEX.COM FOR LATEST PART INFORMATION

Part Number: [0191410063](#)
Status: **Active**
Description: Krimptite™ Spade Tongue Terminal for 14-16 AWG Wire

Documents:

[Drawing \(PDF\)](#) [RoHS Certificate of Compliance \(PDF\)](#)

Agency Certification

CSA LR18689
 UL E32244

General

Product Family Ring and Spade Terminals
 Series [19141](#)
 Crimp Quality Equipment Yes
 Mil-Spec N/A
 Product Name Krimptite™
 Type Spade

Physical

Barrel Type Closed
 Insulation None
 Material - Plating Mating Tin
 Packaging Type Bag
 Plating min: Mating (µin) 100
 Plating min: Mating (µm) 2.5
 Plating min: Termination (µin) 100
 Plating min: Termination (µm) 2.5
 Stud Size 8 (M4)
 Wire Size AWG 14, 16
 Wire Size mm² 1.30 - 2.00

Material Info

Old Part Number BB-127-08

Reference - Drawing Numbers

Sales Drawing BBCD10302, SD-19141-001

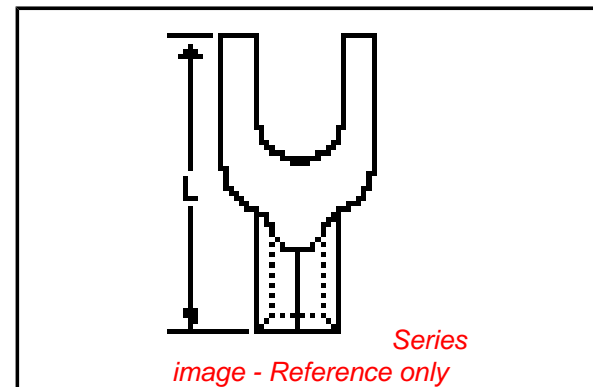

EU RoHS

ELV and RoHS Compliant
REACH SVHC Contains SVHC: No
Halogen-Free Status

China RoHS



Need more information on product environmental compliance?

Email productcompliance@molex.com
 For a multiple part number RoHS Certificate of Compliance, [click here](#)

Please visit the [Contact Us](#) section for any non-product compliance questions.

Search Parts in this Series

[19141Series](#)

Application Tooling | [FAQ](#)

Tooling specifications and manuals are found by selecting the products below. Crimp Height Specifications are then contained in the Application Tooling Specification document.

Global

Description	Product #
Hand Crimp Tool	0640030100
Crimp Head for the AT-200™ Pneumatic Hand Tool	0640070100

NOTES:

① MAT'L: COPPER (STOCK TKN. $\frac{.031}{.79}$) $\pm .001$
 PLATING: ELECTRO-TIN (.0003 MIN.)

STUD SIZES: ($\pm .005$)

- 02 = .094
- 04 = .119
- 06 = .146
- 08 = .173
- 10 = .198
- 14 = .265
- 56 = .328
- 38 = .390

"UL" LISTING *E32244
 "CSA" LISTING #18689

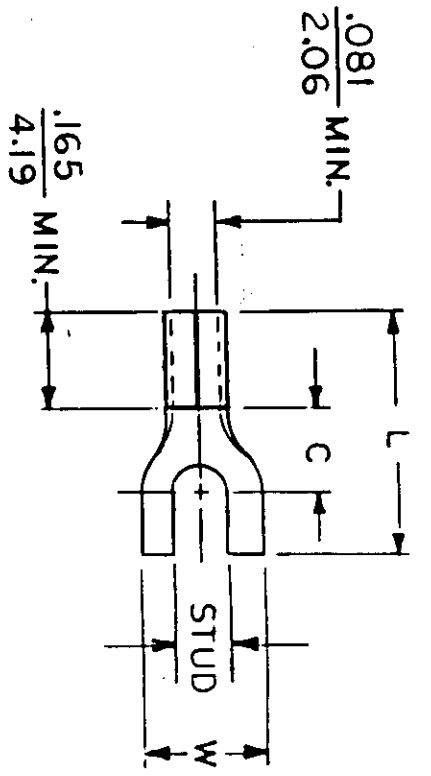

ALL DIMENSIONS = $\frac{\text{INCHES}}{\text{M M}}$

WIRE SIZE: 16 - 14 AWG
 1.0 - 2.5 MM²

PART NUMBER	"W" ±.010	"C" MIN.	"L" MAX.	AVAILABLE STUD SIZES	TITLE:		
					SPADE TONGUE TERMINAL	KRIMP TITE 100-SERIES	
BB-107-	$\frac{.245}{6.22}$	$\frac{.209}{5.31}$	$\frac{.565}{14.35}$	04, 06	SCALE: NTS	DATE	
BB-124-	$\frac{.295}{7.49}$	$\frac{.211}{5.36}$	$\frac{.564}{14.33}$	04, 06, 08	DRWN. BY: <i>h</i>	10-18-84	
BB-127-	$\frac{.362}{9.19}$	$\frac{.269}{6.83}$	$\frac{.687}{17.45}$	06, 08, 10	CHKD. BY: <i>GT</i>	11-2-84	
					APPRD. BY:		
DIMENSIONAL TOLERANCES UNLESS OTHERWISE SPECIFIED					FRAC.	DEC.	ANG.
					±	±	±



DWG. NO. A CUSTOMER DWG.

10	9	8	7	6	5			
MATERIAL NUMBER	ALTERNATE NUMBER	STUD SIZE	"S" ±.005/(0.13)	"W" ±.010/(0.25)	"C" MIN (A1)	"L" MAX (A1)	PACKAGING	
191410050	BB-107-04	4	.119/(3.02)	.245/(6.22)	.209/(5.31)	.565/(14.35)	LOOSE PIECE	
191410052	BB-107-06	6	.146/(3.71)	.245/(6.22)	.209/(5.31)	.565/(14.35)		
191410054	BB-124-04	4	.119/(3.02)	.295/(7.49)	.211/(5.36)	.564/(14.33)		
191410056	BB-124-06	6	.146/(3.71)	.295/(7.49)	.211/(5.36)	.564/(14.33)		
191410058	BB-124-08	8	.173/(4.39)	.295/(7.49)	.211/(5.36)	.564/(14.33)		
191410061	BB-127-06	6	.146/(3.71)	.362/(9.19)	.269/(6.83)	.687/(17.45)		
191410063	BB-127-08	8	.173/(4.39)	.388/(9.85)	.269/(6.83)	.687/(17.45)		
191410065	BB-127-10	10	.198/(5.03)	.388/(9.85)	.269/(6.83)	.687/(17.45)		
191410051	BB-107-04T	4	.119/(3.02)	.245/(6.22)	.209/(5.31)	.565/(14.35)		TAPE MOUNTED
191410053	BB-107-06T	6	.146/(3.71)	.245/(6.22)	.209/(5.31)	.565/(14.35)		
191410055	BB-124-04T	4	.119/(3.02)	.295/(7.49)	.211/(5.36)	.564/(14.33)		
191410057	BB-124-06T	6	.146/(3.71)	.295/(7.49)	.211/(5.36)	.564/(14.33)		
191410059	BB-124-08T	8	.173/(4.39)	.295/(7.49)	.211/(5.36)	.564/(14.33)		
191410062	BB-127-06T	6	.146/(3.71)	.362/(9.19)	.269/(6.83)	.687/(17.45)		
191410064	BB-127-08T	8	.173/(4.39)	.388/(9.85)	.269/(6.83)	.687/(17.45)		
191410066	BB-127-10T	10	.198/(5.03)	.388/(9.85)	.269/(6.83)	.687/(17.45)		

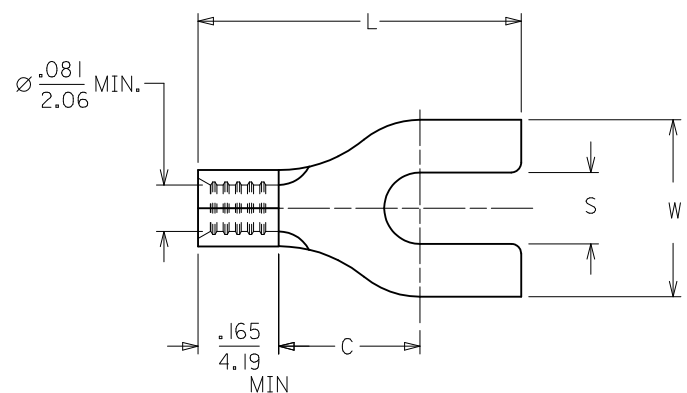
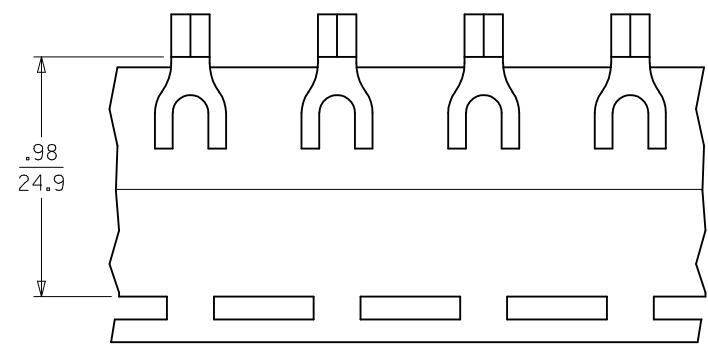

CUSTOMER DRAWING

NOTES:
 1. MATERIAL: COPPER .031/(.79) THICK.
 2. PLATING: ELECTRO-TIN.
 3. PARTS ARE ROHS COMPLIANT. (A1)

ADD MISSING TOLRNC EC NO: WNA2010-0362 DRAWN: THRODAHL 2009/12/21 CHKD: JMACNEIL 2009/12/21 APPR: JMACNEIL 2009/12/21 A1	QUALITY SYMBOLS	GENERAL TOLERANCES (UNLESS SPECIFIED)	DIMENSION STYLE	SCALE	DESIGN UNITS	THIRD ANGLE PROJECTION	
	▼=0 ∇=0	mm INCH 4 PLACES ± --- ± --- 3 PLACES ± --- ± .005 2 PLACES ± 0.13 ± .01 1 PLACE ± 0.25 ± --- ANGULAR ± ---°	IN/MM	---	INCH	DRAWN BY DATE HEB 1999/11/12 CHECKED BY DATE RWD 1999/11/12 APPROVED BY DATE RWD 1999/11/12	
		DRAFT WHERE APPLICABLE MUST REMAIN WITHIN DIMENSIONS	SEE CHART	TITLE SPADE TONGUE TERMINAL 16-14 AWG KRIMPTITE SERIES		MOLEX INCORPORATED DOCUMENT NO. SD-19141-001	SHEET NO. 1 OF 1
				THIS DRAWING CONTAINS INFORMATION THAT IS PROPRIETARY TO MOLEX INCORPORATED AND SHOULD NOT BE USED WITHOUT WRITTEN PERMISSION			