

# KR 2391-1.75-75 Lowpass Filter

## General Description

KR 2391-1.75-75 is a group delay equalized lowpass filters. The filter's flat passband response and group delay equalization make it a good choice for video applications.

## Features

- Flat passband response
- Group delay equalized

## Typical Performance

**Passband Amplitude & Group Delay**  
(0.25 dB/div & 50 nsec/div) 100 KHz to 1.75 MHz

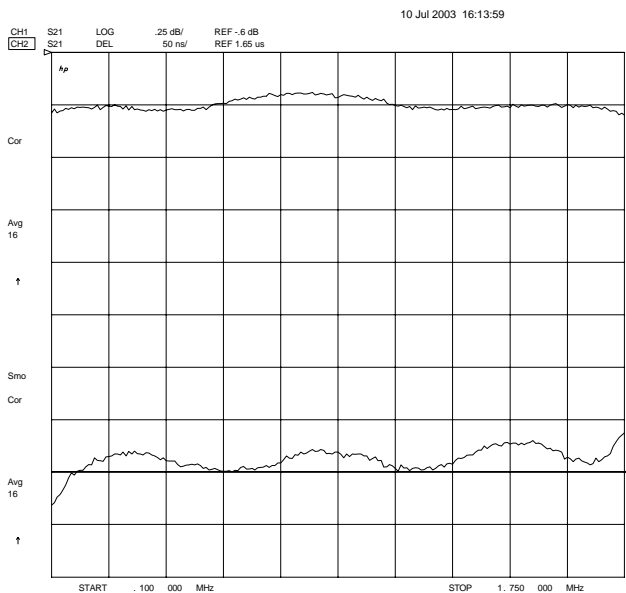

**Overall Response**  
(10 dB/div) 100 KHz to 5 MHz

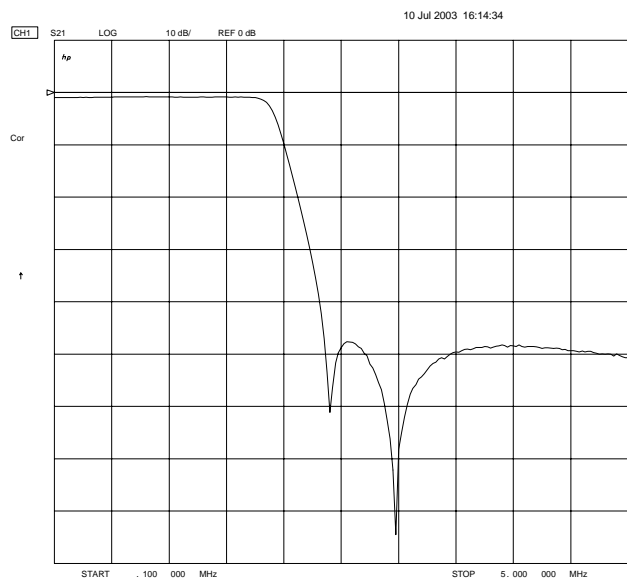

KR Electronics, Inc.  
91 Avenel Street  
Avenel, NJ 07001

Web [www.krfilters.com](http://www.krfilters.com)  
Email [sales@krfilters.com](mailto:sales@krfilters.com)  
Phone (732) 636-1900  
Fax (732) 636-1982

# KR Series 2391-1.75-75

## Specifications

Parameter	Specification
Filter type	Lowpass
Insertion Loss	< 1 dB
End of Passband (fc)	1.75 MHz
Passband Ripple	< 0.25 dB
Attenuation at 1.92 MHz	< 3 dB
Attenuation at 2.415 MHz	> 45 dB
Group Delay Ripple to fc	< 50 nsec
Source and Load	75 Ω

## Physical Dimensions

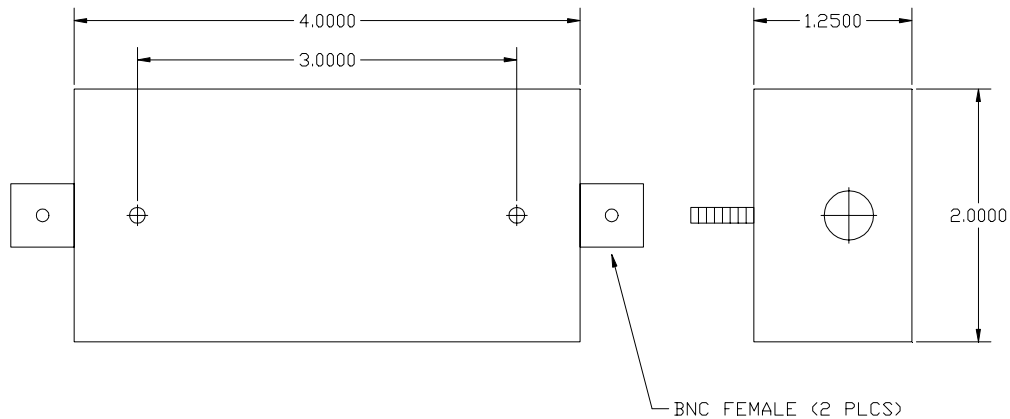

Also available in a 4 x 2 x 0.5 inch metal can  
with PCB terminals  
Other configurations available on request

All dimensions in inches

KR Electronics, Inc.  
91 Avenel Street  
Avenel, NJ 07001

Web [www.krfilters.com](http://www.krfilters.com)  
Email [sales@krfilters.com](mailto:sales@krfilters.com)  
Phone (732) 636-1900  
Fax (732) 636-1982