

PLEASE CHECK WWW.MOLEX.COM FOR LATEST PART INFORMATION

Part Number: [0511920600](#)
Status: **Active**
Description: HMC™ Rectangular Industrial Male Housing, Multi-Module Type, 6 Circuits

Documents:

[Drawing \(PDF\)](#) [RoHS Certificate of Compliance \(PDF\)](#)
[Product Specification PS-58691-004 \(PDF\)](#)

Agency Certification

| | |
|-----|-----------|
| CSA | LR19980 |
| TUV | R72081037 |
| UL | E29179 |

General

| | |
|----------------|-----------------------|
| Product Family | I/O Connectors |
| Series | 51192 |
| Application | Panel-Mount |
| Component Type | Housing |
| Product Name | HMC™ |
| Type | N/A |

Physical

| | |
|--------------------------------|-----------------|
| Boot Color | N/A |
| Circuits (Loaded) | N/A |
| Circuits (maximum) | 6 |
| Color - Resin | Natural |
| Durability (mating cycles max) | 50 |
| Flammability | 94V-0 |
| Gender | Male |
| Lock to Mating Part | Yes |
| Material - Plating Mating | n/a |
| Material - Resin | Nylon |
| Number of Rows | 2 |
| Orientation | Vertical |
| PCB Locator | No |
| Packaging Type | Bag |
| Panel Mount | N/A |
| Pitch - Mating Interface (in) | 0.165 In |
| Pitch - Mating Interface (mm) | 4.20 mm |
| Pitch - Term. Interface (in) | 0.165 In |
| Pitch - Term. Interface (mm) | 4.20 mm |
| Polarized to Mating Part | Yes |
| Polarized to PCB | N/A |
| Ports | 1 |
| Surface Mount Compatible (SMC) | No |
| Temperature Range - Operating | -55°C to +125°C |
| Termination Interface: Style | N/A |
| Waterproof / Dustproof | No |

Electrical

| | |
|-------------------------------|-------------------|
| Current - Maximum per Contact | N/A |
| Shielded | No |
| Voltage - Maximum | 250V AC / 300V DC |

Material Info

Reference - Drawing Numbers

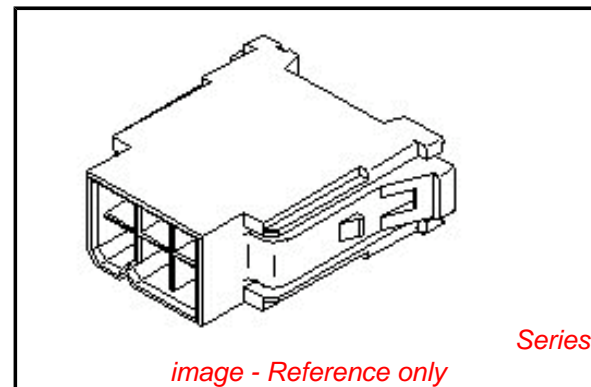

EU RoHS

**ELV and RoHS
Compliant**
REACH SVHC
 Not Reviewed
**Halogen-Free
Status**

China RoHS



**Need more information on product
environmental compliance?**

Email productcompliance@molex.com
 For a multiple part number RoHS Certificate of
 Compliance, [click here](#)

Please visit the [Contact Us](#) section for any
 non-product compliance questions.

Search Parts in this Series

[51192Series](#)

Mates With

[51193-0600](#) housing

Use With

58687 hood bracket and 58691 panel-mount
 bracket, [5558](#) GSX terminal

This document was generated on 04/12/2010

PLEASE CHECK WWW.MOLEX.COM FOR LATEST PART INFORMATION

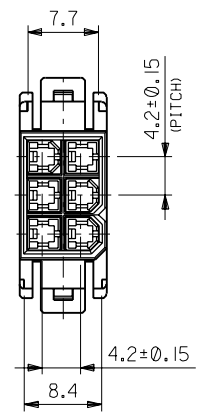
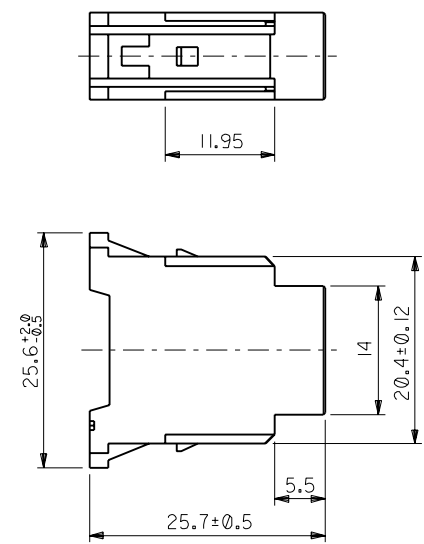
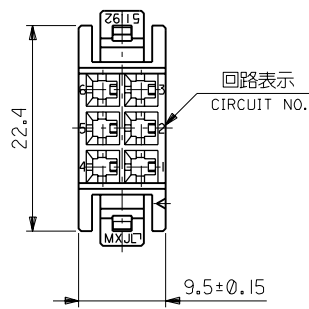

注記:
NOTES:

- 適用ターミナル: 5558****.
APPLICATION TERMINAL
- 指定外公差: ±0.2.
UNSPECIFIED DIMENSION TOLERANCE

| | |
|---|--------------------|
| 51192-0600 | 51192-0600 |
| MATERIAL NO. | MODEL NO. |
| DIMENSIONS: | SHT REV |
| <input type="checkbox"/> mm <input type="checkbox"/> INCH <input checked="" type="checkbox"/> mm ONLY | REVISE ON CAD ONLY |

| | | | | | | | | | | |
|----------------------------------|----------------------------------|----------------------------------|---|--|---|---|---------------|--|---------------------------|--|
| EC NO. DRWN: CHK: APPR: | EC NO. DRWN: CHK: APPR: | EC NO. DRWN: CHK: APPR: | REVISED EC No. JD90675 *sp/11/06 DRWN: Y. TETSUKA CHK: S. AKIYAMA/YO.ITO APPR: H. IKESUGI | RELEASED EC No. JD81452 *sp/04/22 DRWN: M. HOSONO CHK: Y. ITO APPR: H. IKESUGI | MATERIAL 材料 ガラススナイロン66 UL94V-0 色: 自然色 | GENERAL TOLERANCES: (UNLESS SPECIFIED) 一般公差 | SCALE 2-1 | DESIGN UNITS <input checked="" type="checkbox"/> mm <input type="checkbox"/> INCH | THIRD ANGLE PROJECTION | TITLE: POWER CONN PIN HOUSING (6P) |
| INS. RANGE 被覆外径 | FINISH 仕上げ | WIRE RANGE 適用電線範囲 | REV | DESCRIPTION | ANGLE 角度 | 10 UNDER 未満 | 10 OVER 以上 | 30 UNDER 未満 | 30 OVER 以上 | APPROVED BY & DATE <i>M. Hosono</i> '98/04/22 |
| | | | | | | ±0.2 | ±0.25 | ±0.3 | ±3° | MOLEX INCORPORATED |
| | | | | | | | | | | CAD FILENAME 51192002.S01 |
| | | | | | | | | | | MATERIAL NO. SEE CHART |
| | | | | | | | | | | DRAWING NO. SD-51192-002 |
| | | | | | | | | | | SHEET NO. 1 OF 1 |
| | | | | | | | | | | THIS DRAWING CONTAINS INFORMATION THAT IS PROPRIETARY TO MOLEX INCORPORATED AND SHOULD NOT BE USED WITHOUT WRITTEN PERMISSION. |
| | | | | | | | | | | SIZE B |