

KR Series 2391A Lowpass Filter

General Description

KR Series 2391A are group delay equalized lowpass filters. The filter's flat passband response and group delay equalization make them good choices for video applications. Cutoff frequencies can be specified from 1.75 MHz to 10 MHz.

Features

- Flat passband response
- Group delay equalized

Typical Performance

Passband Response $f_c=1.75$ MHz
(0.2 dB/div & 50 nsec/div) 100 KHz to 1.75 MHz

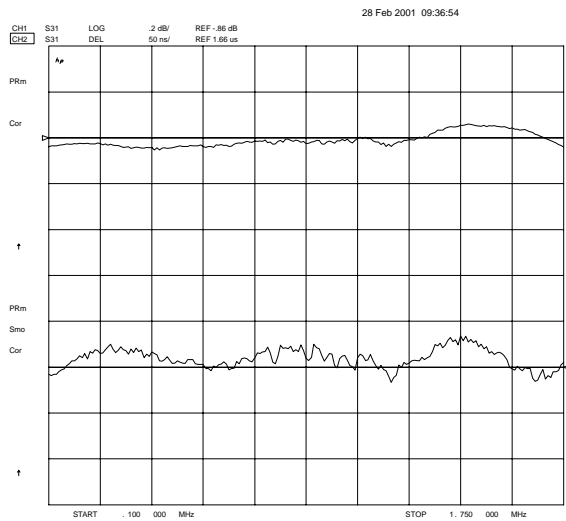

Figure 1

Overall Response $f_c=1.75$ MHz
(10 dB/div) 100 KHz to 10 MHz

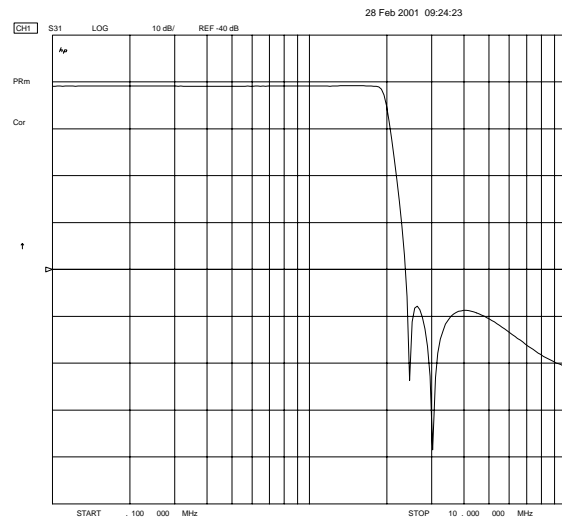

Figure 2

KR Electronics, Inc.
91 Avenel Street
Avenel, NJ 07001

Web www.krfilters.com
Email sales@krfilters.com
Phone (732) 636-1900
Fax (732) 636-1982

KR Series 2391A Series Lowpass

Specifications

Parameter	Specification	
Filter type	Lowpass	
Insertion Loss	< 1 dB	
End of Passband (fc)	1.75 MHz to 10 MHz	User Specified
Passband Ripple	< 0.25 dB	
Attenuation at 1.1 x fc	< 3 dB	
Attenuation at 1.38 x fc	> 45 dB	
Group Delay Ripple to fc	< 87.5 nsec/ fc MHz Example: for fc=1.75 MHz Group Delay Ripple < 87.5/1.75 or < 50 nsec p-p	Consult factory
Source and Load	50Ω or 75Ω	Others available consult factory

Physical Dimensions

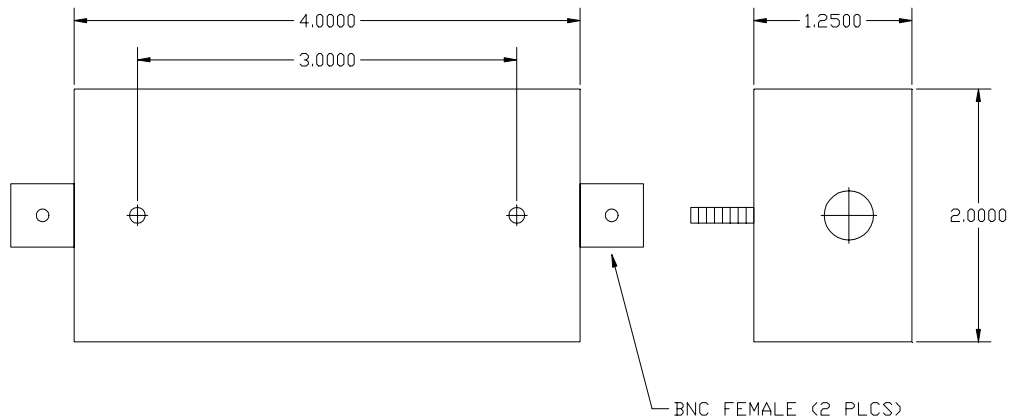

Also available in a 4 x 2 x 0.5 inch metal can with PCB terminals

All dimensions in inches