

SP4T Switch

P/N: JXWBKG-T-4-20-600-A

Frequency Range(MHz)	20-600
Switch Type	Absorptive
Insertion Loss(dB)	1.8 max
VSWR	1.4 max
Isolation(dB)	80 min
RF Power(dBm)	20 max
Impedance(Ohms)	50
Control	TTL("0" OFF, "1" Thru)
Switching Speed(ms)	0.5
DC Power(V)	+5@150mA max;-5@150mA max
Connector	SMA-Female(Removable)
Operating Temperature(°C)	-40 ~ +70
Storage Temperature (°C)	-55 - +85
Net Weight(Kg)	0.085 Around

Outline Drawing (Size: mm)

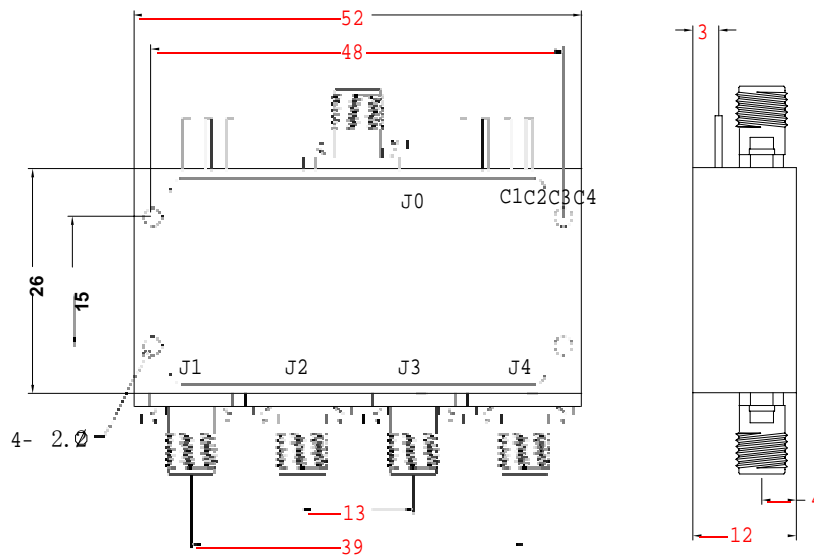

For current data sheets, please contact: sales@aacix.com