

## Power Amplifier

P/N: JXWBPA-T-15.5-16.5-31

Frequency(GHz)	16±0.5
Gain(dB)	10 min;15 max
Pout @1dB(dBm)	31
Flatness(dB)	±1 max
IP3(dBm)	35 min
VSWR	2.0:1 (in)
Power Supply(V/ mA)	+12 / 1500
Connectors	SMA-Female
Net Weight(Kg)	0.075 Around

### Outline Drawing (Size: mm)

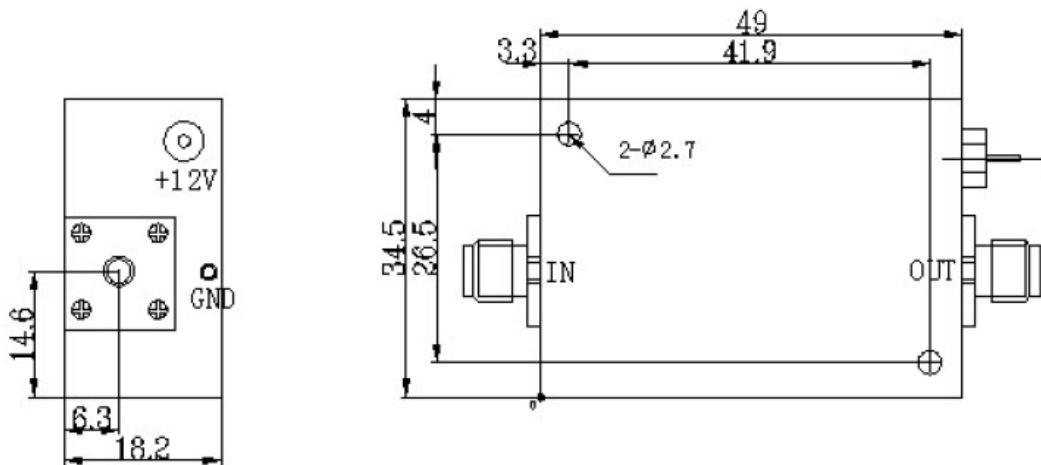

For current data sheets, please contact: [sales@aacix.com](mailto:sales@aacix.com)