

PLEASE CHECK WWW.MOLEX.COM FOR LATEST PART INFORMATION

Part Number: [0511930600](#)
Status: **Active**
Description: HMC™ Rectangular Industrial Female Housing, Multi-Module Type, 6 Circuits

Documents:

[Drawing \(PDF\)](#) [RoHS Certificate of Compliance \(PDF\)](#)
[Product Specification PS-58691-004 \(PDF\)](#)

Agency Certification

CSA	LR19980
TUV	R72081037
UL	E29179

General

Product Family	I/O Connectors
Series	51193
Application	Panel-Mount
Component Type	Housing
Product Name	HMC™
Type	N/A

Physical

Boot Color	N/A
Breakaway	No
Circuits (Loaded)	N/A
Circuits (maximum)	6
Color - Resin	Natural
Flammability	94V-0
Gender	Female
Lock to Mating Part	Yes
Material - Plating Mating	n/a
Material - Resin	Nylon
Number of Rows	2
Orientation	Vertical
PCB Locator	No
Packaging Type	Bag
Panel Mount	N/A
Pitch - Mating Interface (in)	0.165 In
Pitch - Mating Interface (mm)	4.20 mm
Pitch - Term. Interface (in)	0.165 In
Pitch - Term. Interface (mm)	4.20 mm
Polarized to Mating Part	Yes
Polarized to PCB	N/A
Ports	1
Surface Mount Compatible (SMC)	No
Temperature Range - Operating	-55°C to +125°C
Termination Interface: Style	N/A
Waterproof / Dustproof	No

Electrical

Current - Maximum per Contact	N/A
Shielded	No
Voltage - Maximum	250V AC / 300V DC

Material Info

Reference - Drawing Numbers

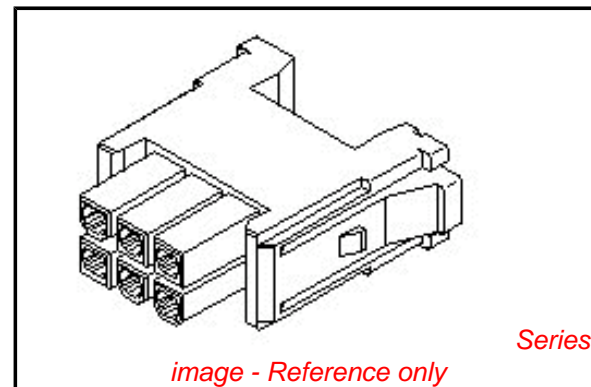

image - Reference only

EU RoHS

**ELV and RoHS
Compliant**
**REACH SVHC
Contains SVHC: No**
**Halogen-Free
Status**

China RoHS



**Need more information on product
environmental compliance?**

Email productcompliance@molex.com
 For a multiple part number RoHS Certificate of
 Compliance, [click here](#)

Please visit the [Contact Us](#) section for any
 non-product compliance questions.

Search Parts in this Series

[51193Series](#)

Mates With

[51192-0600](#) housing

Use With

58687 hood bracket and 58691 panel-mount
 bracket, [5556](#) GSX terminal

This document was generated on 04/12/2010

PLEASE CHECK WWW.MOLEX.COM FOR LATEST PART INFORMATION

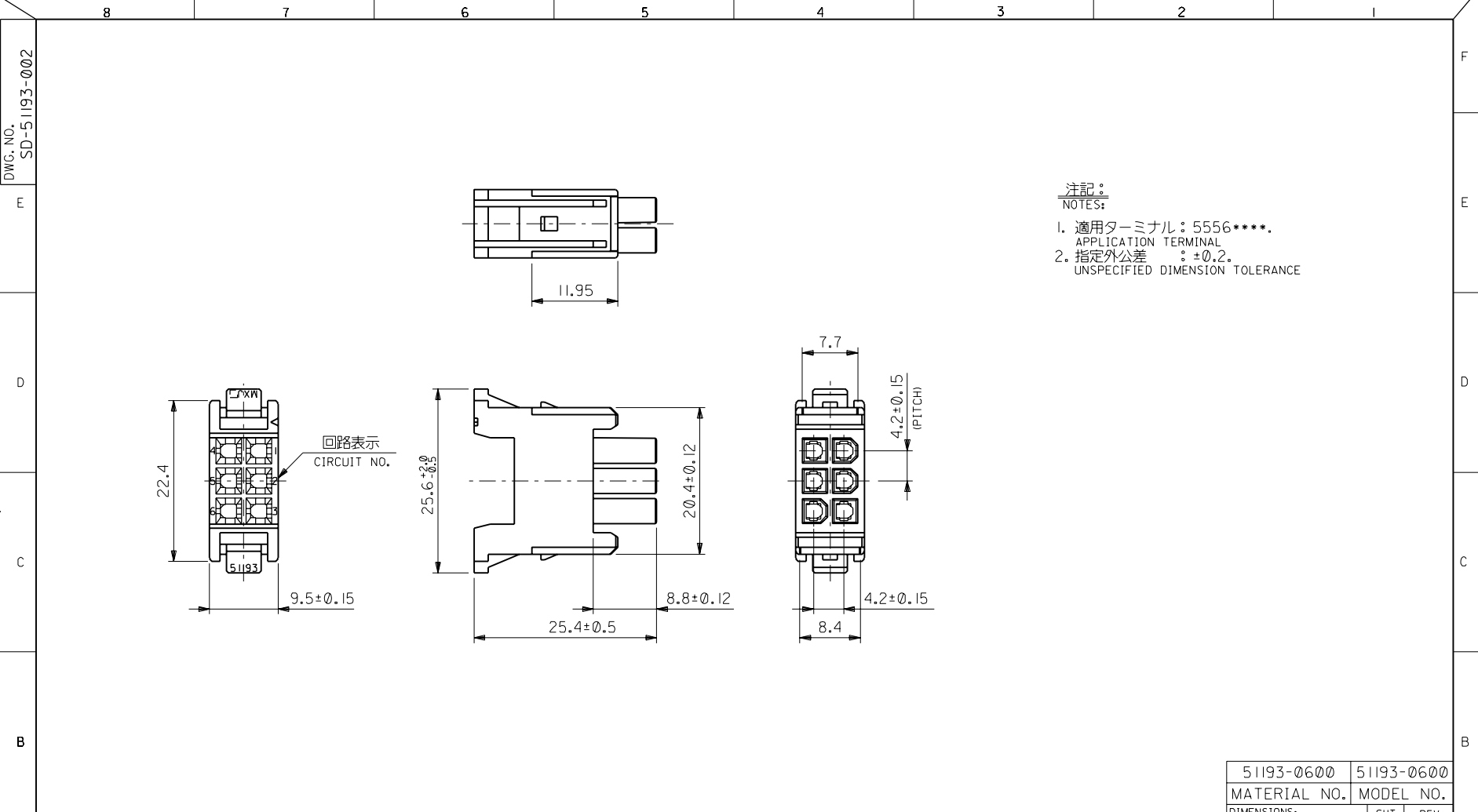

注記:
NOTES:
1. 適用ターミナル: 5556****.
APPLICATION TERMINAL
2. 指定外公差: ±0.2.
UNSPECIFIED DIMENSION TOLERANCE

EC NO. DRWN: CHK: APPR:	EC NO. DRWN: CHK: APPR:	EC NO. DRWN: CHK: APPR:	REVISED EC NO. JD910675 '98/11/06 DRWN: Y. TETSUKA CHK: SAKIYAMA/YOJITO APPR: H. IKESUGI	RELEASED EC NO. JD81452 '98/04/22 DRWN: M. HOSONO CHK: Y. ITO APPR: H. IKESUGI	MATERIAL 材料 ガラスナイロン66 UL94V-0 色: 自然色	GENERAL TOLERANCES: (UNLESS SPECIFIED) 一般公差	SCALE 2-1	DESIGN UNITS <input checked="" type="checkbox"/> mm <input type="checkbox"/> INCH	THIRD ANGLE PROJECTION	51193-0600	51193-0600	
FINISH 仕上り	WIRE RANGE 適用電線範囲	INS. RANGE 被覆外径	10 UNDER 未満	10 OVER 以上	30 UNDER 未満	30 OVER 以上	ANGLE 角度	DRAWN BY & DATE M. HOSONO '98/04/22	CHECKED BY & DATE Y. ITO '98/04/22	TITLE: POWER CONN SOCKET HOUSING (6P)	MATERIAL NO.	MODEL NO.
								APPROVED BY & DATE M. Hosono '98/04/22		MATERIAL NO. SEE CHART	DRAWING NO. SD-51193-002	SHEET NO. 1 OF 1
								CAD FILE NAME 51193002.S01				SIZE B
THIS DRAWING CONTAINS INFORMATION THAT IS PROPRIETARY TO MOLEX INCORPORATED AND SHOULD NOT BE USED WITHOUT WRITTEN PERMISSION.										EN-02J(097) MXJ-54		