

PLEASE CHECK WWW.MOLEX.COM FOR LATEST PART INFORMATION

Part Number: [0190710208](#)
Status: **Active**
Description: InsulKrimp™ Ring Tongue Terminal for 6 AWG Wire

Documents:

[Drawing \(PDF\)](#) [RoHS Certificate of Compliance \(PDF\)](#)
[Product Specification PS-19902-009 \(PDF\)](#)

General

Product Family	Ring and Spade Terminals
Series	19071
Crimp Quality Equipment	Yes
Mil-Spec	N/A
Product Name	InsulKrimp™
Type	Ring

Physical

Barrel Type	Closed
Color - Resin	Natural
Insulation	PVC
Material - Plating Mating	Tin
Packaging Type	Bag
Plating min: Mating (µin)	100
Plating min: Mating (µm)	2.5
Plating min: Termination (µin)	100
Plating min: Termination (µm)	2.5
Stud Size	7/16" (M11)
Termination Interface: Style	Crimp or Compression
Wire Insulation Diameter	11.20mm (.440") max.
Wire Size AWG	6

Material Info

Old Part Number	E-658-76X
-----------------	-----------

Reference - Drawing Numbers

Product Specification	PS-19902-009
Sales Drawing	SD-19071-011

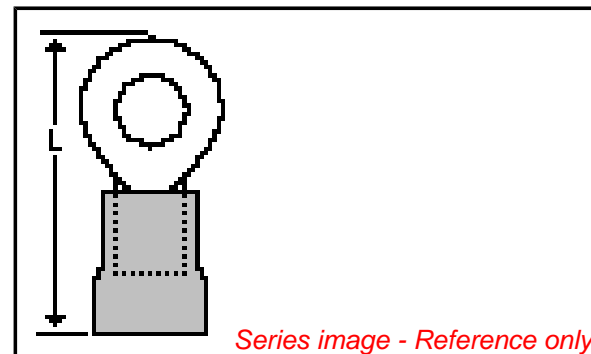

EU RoHS

**ELV and RoHS
Compliant**
REACH SVHC
 Not Reviewed
**Halogen-Free
Status**
Not Reviewed

China RoHS



**Need more information on product
environmental compliance?**

Email productcompliance@molex.com
 For a multiple part number RoHS Certificate of Compliance, [click here](#)

Please visit the [Contact Us](#) section for any non-product compliance questions.

Search Parts in this Series

[19071Series](#)

Application Tooling | [FAQ](#)

Tooling specifications and manuals are found by selecting the products below. Crimp Height Specifications are then contained in the Application Tooling Specification document.

Global

Description	Product #
Manual Putt Pump Hydraulic System, Die set required	0192860117
Die Set (large) for the HHLS Hydraulic Crimper	0192890004
Hand Crimp Tool	0640013900
Putt Pump Dieless Head System	0192860065

MATERIAL NO.	ENG. NO.	STUD SIZE	$\phi S \pm .005$
190710200	E-658-10X	10	.198
190710203	E-658-14X	1/4	.265
190710206	E-658-56X	5/16	.328
190710204	E-658-38X	3/8	.390
190710208	E-658-76X	7/16	.453
190710201	E-658-12X	1/2	.515
190710207	E-658-58X	5/8	.656

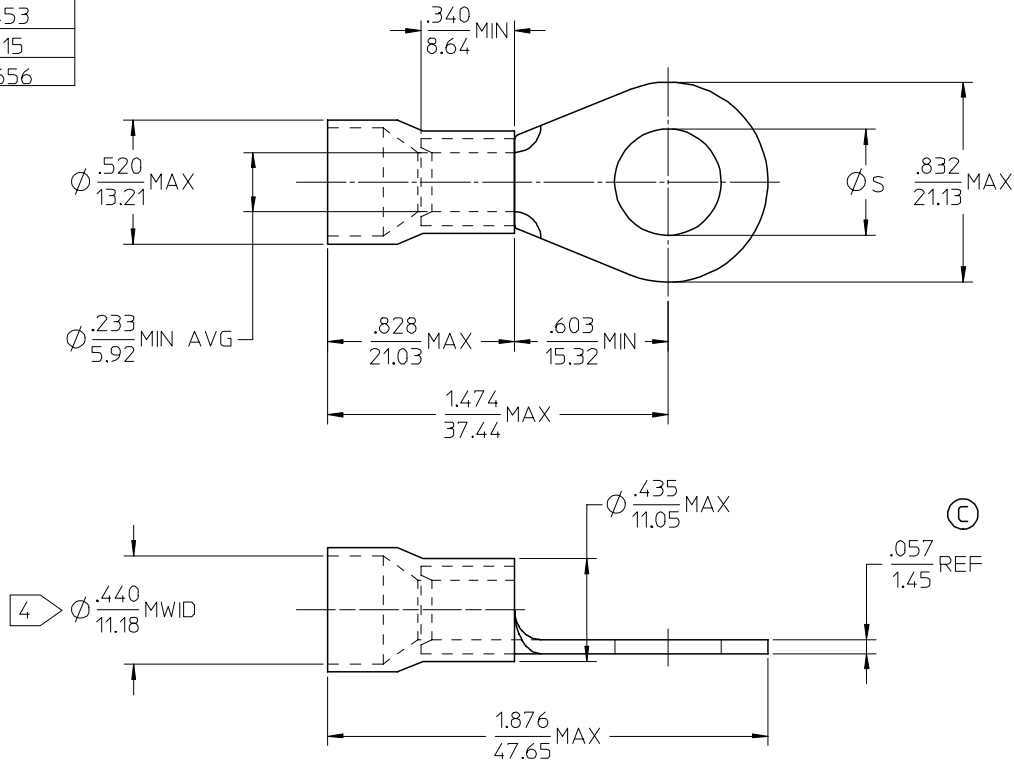

NOTE(S):

1. TERMINAL MATERIAL: COPPER ALLOY.
2. TERMINAL FINISH: ELECTRO TIN PLATE.
3. INSULATION MATERIAL: PVC, COLOR CODED BLUE.
4. MWID = MAXIMUM WIRE INSULATION DIAMETER.
5. ALL COMPONENTS ARE ROHS COMPLIANT.

INCREASED MATL THKNS EC NO: ETC2007-0236 DRW: JHILLE 2007/01/04 CHKD: JMACNEIL 2007/01/04 APPR: JMACNEIL 2007/01/05	QUALITY SYMBOLS	GENERAL TOLERANCES (UNLESS SPECIFIED)	DIMENSION STYLE	SCALE	DESIGN UNITS	THIRD ANGLE PROJECTION																		
	$\nabla=0$ $\nabla=0$	<table border="1"> <thead> <tr> <th></th> <th>mm</th> <th>INCH</th> </tr> </thead> <tbody> <tr> <td>4 PLACES</td> <td>$\pm .005$</td> <td>$\pm .0004$</td> </tr> <tr> <td>3 PLACES</td> <td>$\pm .005$</td> <td>$\pm .0004$</td> </tr> <tr> <td>2 PLACES</td> <td>$\pm .005$</td> <td>$\pm .0004$</td> </tr> <tr> <td>1 PLACE</td> <td>$\pm .005$</td> <td>$\pm .0004$</td> </tr> <tr> <td colspan="3">ANGULAR $\pm .005^\circ$</td> </tr> </tbody> </table>		mm	INCH	4 PLACES	$\pm .005$	$\pm .0004$	3 PLACES	$\pm .005$	$\pm .0004$	2 PLACES	$\pm .005$	$\pm .0004$	1 PLACE	$\pm .005$	$\pm .0004$	ANGULAR $\pm .005^\circ$			IN/MM	4:1	INCH	
		mm	INCH																					
	4 PLACES	$\pm .005$	$\pm .0004$																					
3 PLACES	$\pm .005$	$\pm .0004$																						
2 PLACES	$\pm .005$	$\pm .0004$																						
1 PLACE	$\pm .005$	$\pm .0004$																						
ANGULAR $\pm .005^\circ$																								
DESCRIPTION	DRAWN BY	DATE	TITLE																					
REV	E. HILE	2005/11/23	RING TONGUE TERMINAL INSULKRIMP 658 SERIES 6 AWG																					
	CHECKED BY	DATE	MOLEX INCORPORATED																					
	R. DEROSS	2005/11/23	DOCUMENT NO. SD-19071-011																					
	APPROVED BY	DATE	SHEET NO. 1 OF 1																					
	R. DEROSS	2005/11/23	THIS DRAWING CONTAINS INFORMATION THAT IS PROPRIETARY TO MOLEX INCORPORATED AND SHOULD NOT BE USED WITHOUT WRITTEN PERMISSION																					
	MATERIAL NO.	DATE																						
	SEE CHART																							
	SIZE B																							