

# ACP-1000/ 1000MB

## 1U Rackmount Chassis for SBC or ATX/MicroATX Motherboard

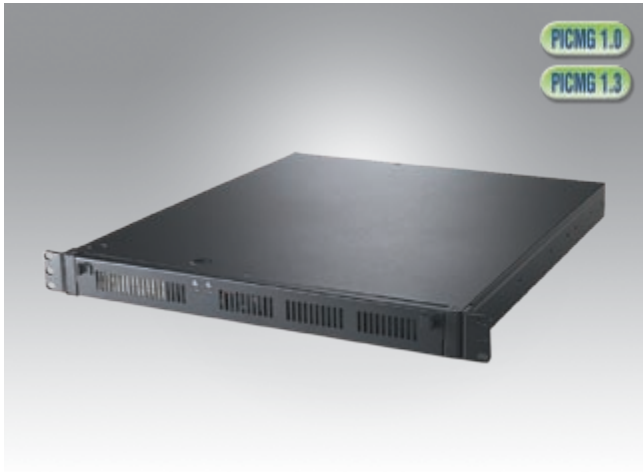

### Features

- Easy-to-install disk drive bay to hold a slim optical disk drive and 3.5" disk drive
- Front-accessible USB and PS/2 ports for easy data transfer
- Reserved 9-pin D-Sub opening at rear
- ACP-1000BP supports up to two 64-bit full-length PCI cards
- ACP-1000MB supports full-length PCI or PCIe expansion cards via different riser card options
- Four cooling fans designed for optimizing the system's airflow

### Specifications

Drive Bay	Slim Optical Disk Drive	Front-accessible	Internal
	3.5"	1	1
Cooling	Fan	Front-accessible	Rear Panel
	Air Filter	3 (10 CFM each)	1 (10 CFM) / 1 (15 CFM)
Front I/O Interface	USB	Yes	-
	PS/2	2	-
Miscellaneous	Rear Panel	Reserved one 9-pin D-Sub opening	
Environment	Temperature	Operating	Non-Operating
	Humidity	0 ~ 40° C (32 ~ 104° F)	-20 ~ 60° C (-4 ~ 140° F)
	Vibration (5 ~ 500 Hz)	10 ~ 85 % @ 40° C, non-condensing	10 ~ 95 % @ 40° C non-condensing
	Shock	1 Grms	2 G
Physical Characteristics	Dimensions (W x H x D)	10 G (with 11 ms duration, half sine wave)	30 G
	Weight	BP: 480 x 44 x 497 mm (18.9" x 1.7" x 19.6") MB: 480 x 44 x 450 mm (18.9" x 1.7" x 17.7")	

#### ACP-1000

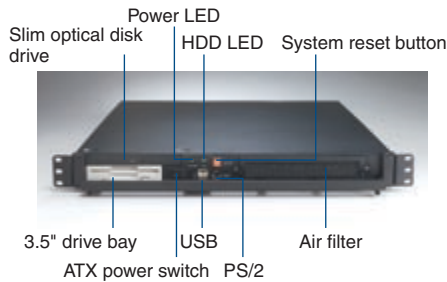

One internal 3.5" disk drive  
One rear 10-CFM cooling fan

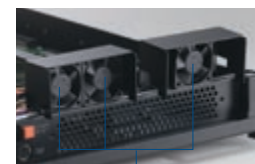

Three filtered 10-CFM cooling fans are on the front

#### ACP-1000MB

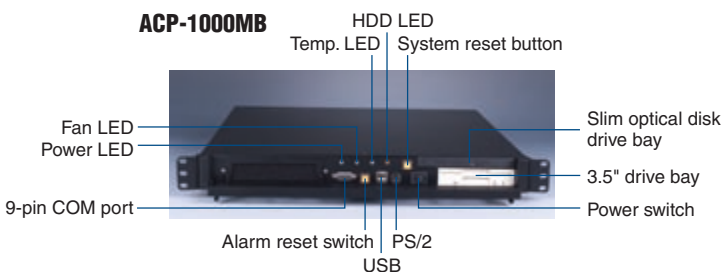

Supports one full-length 32-bit PCI or PCIe x4 card

## Dimensions

Unit: mm (inch)

### ACP-1000

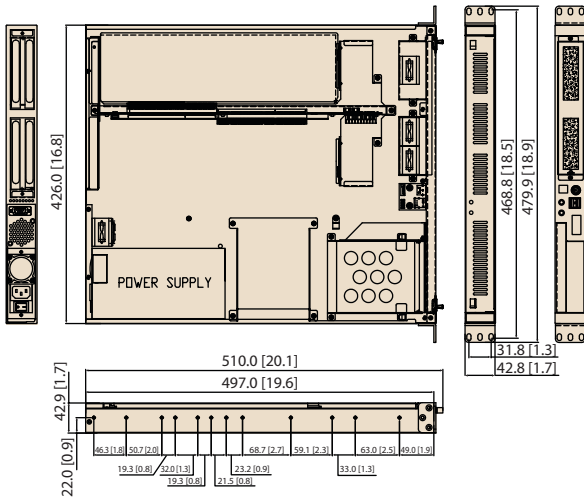

### ACP-1000MB

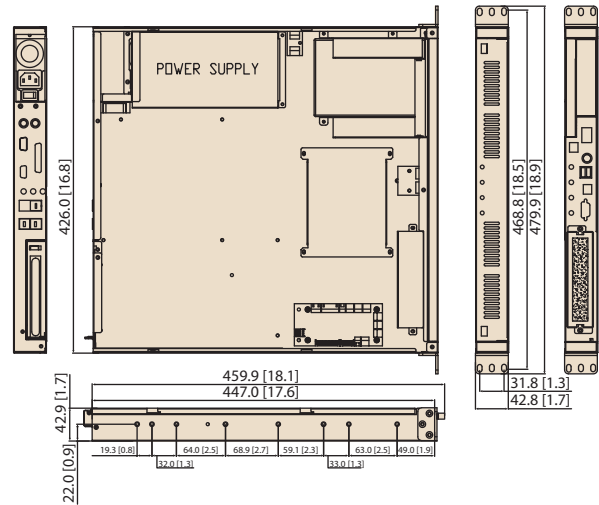

## Power Supply Options

Part Number	Specifications		Output	Mini-load	Safety	MTBF
	Watt	Input				
<b>ACP-1000</b>						
1757920000G (ATX, PFC)	200 W	AC 100 ~ 240 V (full-range)	+5 V @ 16 A, +3.3 V @ 14 A +12 V @ 9 A, -12 V @ 0.7 A -5 V @ 0.2 A, +5 Vsb @ 1.5 A	+5 V @ 2 A, +12 V @ 1 A -5 V @ 0.1 A, -12 V @ 0.1 A +5 Vsb @ 0.1 A	UL/TUV/CB/CCC	84,000 hours @ 25° C
1757918000G (ATX)	180 W	DC - 40 ~ 56 V	+5 V @ 20 A, +3.3 V @ 12 A +12 V @ 7 A, -12 V @ 1 A -5 V @ 0.5 A, +5 Vsb @ 1.5 A	+5 V @ 2 A, +12 V @ 1 A -5 V @ 0.1 A, -12 V @ 0.1 A +3.3 V @ 1 A, +5Vsb @ 0.1 A	UL/TUV/CB/CCC	100,000 hours @ 25° C
<b>ACP-1000MB</b>						
1757000005G (ATX, PFC)	200 W	AC 100 ~ 240 V (full-range)	+5 V @ 16 A, +3.3 V @ 14 A +12 V @ 9 A, -12 V @ 0.7 A -5 V @ 0.2 A, +5 Vsb @ 1.5 A	+5 V @ 2 A, +12 V @ 1 A -5 V @ 0.1 A, -12 V @ 0.1 A +5 Vsb @ 0.1 A	UL/TUV/CB/CCC	84,000 hours @ 25° C

## Accessories

Part Number	Description
1750000242	Low profile P4 Socket 478 CPU cooler up to 2.5 GHz (0.13 micron)
1750000432	Low profile P4 Socket 478 CPU cooler up to 2.8 GHz (0.13 micron 70 W)
19991K0000	Filter 166 x 32 x 5 mm
96FDD-144-TE-B1	Black 3.5" FDD
96SCD-24X-I-OD-B	Black slim 24X CD-ROM
96SCOM-24X8X-TE-B1	Black slim 24X/8X/24X DVDRW-ROM

## Riser Card Options

Part Number	Interface	Expansion Slot	Supported Motherboard
AIMB-R4104-01A1E	PCIe x4	One PCIe x4	AIMB-554/556
AIMB-RP10P-01A1E	PCI	One PCI	AIMB-740/742/744/750

## Ordering Information

Part Number	Power Supply	Backplane / Motherboard	Regulation
ACP-1000BP-00XE	-	-	-
ACP-1000BP-20ZE	1757920000G	-	CE
ACP-1000MB0-20ZE	1757000005G	-	CE

\* ACP-1000MB does not support for AIMB-763. 542, 562, 564 models due to the height of the audio connector is over 1U.



Rear 10-CFM cooling fan  
Rear View of ACP-1000



Rear View of ACP-1000MB