

**B**

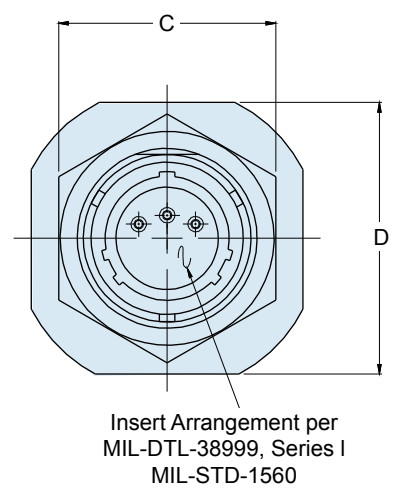

**231-103-H7**  
**Jam Nut Mount Hermetic Bulkhead Feed-Thru**  
**MIL-DTL-38999 Series I Type**

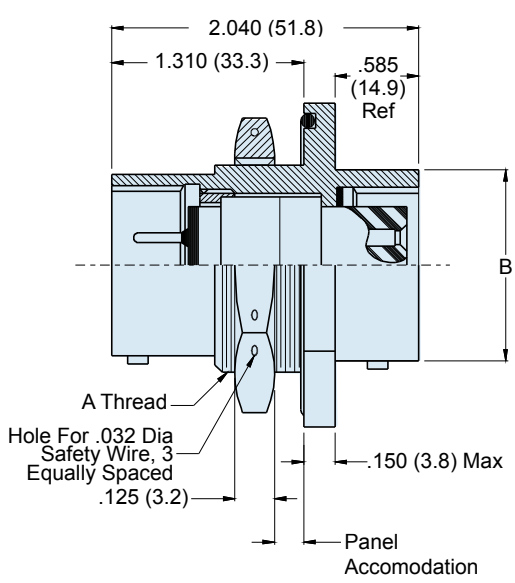
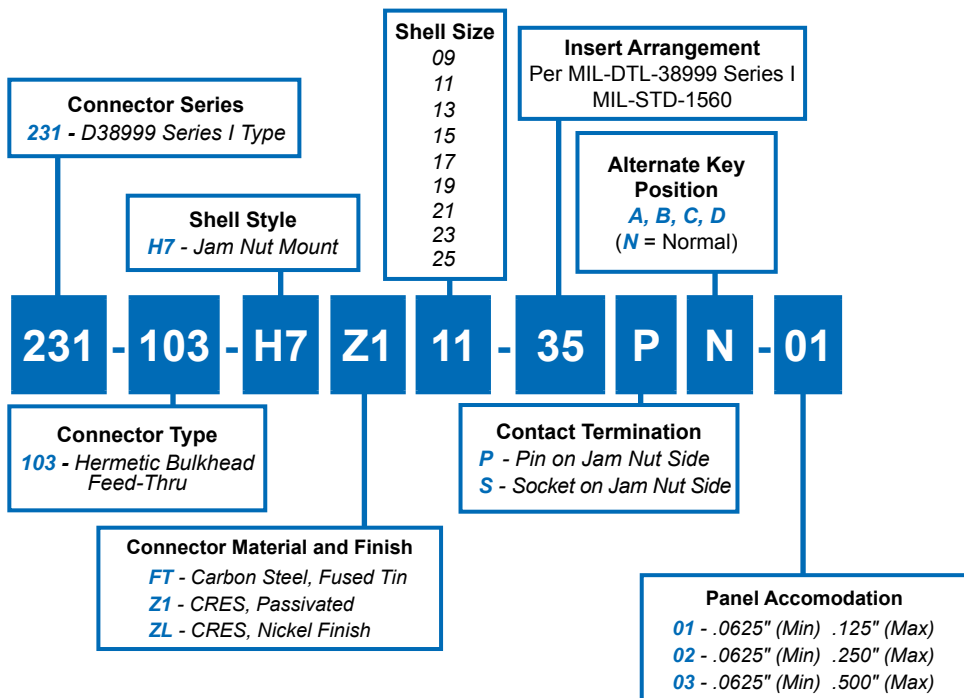

MIL-DTL  
 38999 Type

**B**

| HERMETIC LEAK RATE MOD CODES |  |
|------------------------------|--|
| Designator                   | Required Leak Rate                           |
| -585A                        | 1 x 10 <sup>-10</sup> cc's Helium per second |
| -585B                        | 1 x 10 <sup>-9</sup> cc's Helium per second  |
| -585C                        | 1 x 10 <sup>-8</sup> cc's Helium per second  |

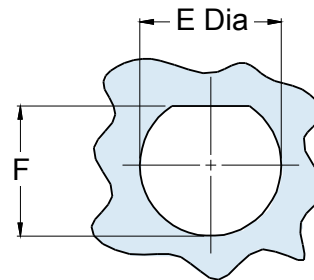

Recommended Panel Cut-Out

| TABLE I: CONNECTOR DIMENSIONS |                   |             |             |             |                  |                      |
|-------------------------------|-------------------|-------------|-------------|-------------|------------------|----------------------|
| SHELL SIZE                    | A THREAD CLASS 2A | B DIA MAX   | C HEX       | D FLATS     | E DIA ±.005(0.1) | F +.000-.005 (0-0.1) |
| 09                            | .688-24 UNEF      | .573(14.6)  | .875(22.2)  | 1.062(27.0) | .703(17.9)       | .669(17.0)           |
| 11                            | 0.812-20 UNEF     | .701(17.8)  | 1.000(25.4) | 1.250(31.8) | .827(21.0)       | .769(19.5)           |
| 13                            | 1.000-20 UNEF     | .851(21.6)  | 1.188(30.2) | 1.375(34.9) | 1.015(25.8)      | .955(24.3)           |
| 15                            | 1.125-18 UNEF     | .976(24.8)  | 1.312(33.3) | 1.500(38.1) | 1.140(29.0)      | 1.084(27.5)          |
| 17                            | 1.250-18 UNEF     | 1.101(28.0) | 1.438(36.5) | 1.625(41.3) | 1.265(32.1)      | 1.208(30.7)          |
| 19                            | 1.375-18 UNEF     | 1.208(30.7) | 1.562(39.7) | 1.812(46.0) | 1.390(35.3)      | 1.333(33.9)          |
| 21                            | 1.500-18 UNEF     | 1.333(33.9) | 1.688(42.9) | 1.938(49.2) | 1.515(38.5)      | 1.459(37.1)          |
| 23                            | 1.625-18 UNEF     | 1.458(37.0) | 1.812(46.0) | 2.062(52.4) | 1.640(41.7)      | 1.580(40.1)          |
| 25                            | 1.750-18 UNS      | 1.583(40.2) | 2.000(50.8) | 2.188(55.6) | 1.765(44.8)      | 1.709(43.4)          |

**APPLICATION NOTES**

- Power to a given contact on one end will result in power to contact directly opposite, regardless of identification letter.
- Hermeticity = less than 1 x 10<sup>-7</sup> cc/sec at one atmosphere. Not for use in liquid atmosphere.
- Material/finish:  
 Shell, nut – CRES/passivated, carbon steel/fused tin or CRES/nickel per QQ-N-290.
- Contacts – Gold Plated. Pin: alloy 52; Skt.: copper alloy  
 Insulator – fused vitreous glass/N.A.  
 Seals – fluorosilicone rubber/N.A.