

**SOLID STATE DEVICES, INC.**

14830 Valley View Blvd \* La Mirada, Ca 90638  
 Phone: (562) 404-7855 \* Fax: (562) 404-1773

**Designer's Data Sheet**

**FEATURES:**

- Average Output Current 0.5Amps
- 2500 to 25000 V Blocking Voltage
- Ultrafast Recovery: 80 nsec Maximum
- Low Reverse Leakage Current
- Corona Free Construction
- Glass Passivated Rectifiers
- Hermetically Sealed Discretes
- Superior Thermal Shock Resistance
- TX and TXV Level Screening Available

**SDA2500UF  
 thru  
 SDA25000UF**

**0.5 AMPS  
 2.5kV thru 25kV  
 ULTRAFAST RECOVERY  
 RECTIFIER ASSEMBLY**

**HV STICK**

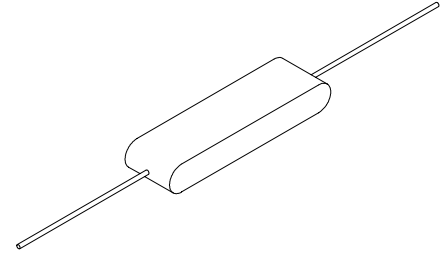

Maximum Ratings	SYMBOL	VALUE	UNITS
Peak Repetitive Reverse and DC Blocking Voltage	SDA2500UF SDA5000UF SDA7500UF SDA10000UF SDA12500UF SDA15000UF SDA20000UF SDA25000UF	2500 5000 7500 10000 12500 15000 20000 25000	Volts
Average Rectified Forward Current (Resistive load, 60Hz, Sine Wave, T <sub>A</sub> = 25°C, No Heatsink)	I <sub>o</sub>	0.5	Amps
Peak Surge Current (8.3 ms Pulse, Half Sine Wave, T <sub>A</sub> = 25°C)	I <sub>FSM</sub>	25	Amps
Operating and Storage Temperature	T <sub>OP</sub> & T <sub>stg</sub>	-55 TO +150	°C

**NOTE:** All specifications are subject to change without notification. SCD's for these devices should be reviewed by SSDI prior to release.

**DATA SHEET # : RA0006A** [DataSheet4U.com](http://DataSheet4U.com)

# SDA2500UF thru SDA25000UF

PRELIMINARY

**SOLID STATE DEVICES, INC.**

 14830 Valley View Blvd \* La Mirada, Ca 90638  
 Phone: (562) 404-7855 \* Fax: (562) 404-1773

ELECTRICAL CHARACTERISTIC <sup>1/</sup>	SYMBOL	MAXIMUM	UNITS
<b>Instantaneous Forward Voltage Drop</b> (I <sub>F</sub> = 0.5A, 300 - 500μsec pulse)	SDA2500UF	5.5	V <sub>dc</sub>
	SDA5000UF	9.5	
	SDA7500UF	15.0	
	SDA10000UF	19.0	
	SDA12500UF	24.5	
	SDA15000UF	28.5	
	SDA20000UF	38.0	
	SDA25000UF	47.5	
<b>Reverse Leakage Current</b> (Rated V <sub>R</sub> , 300μs pulse minimum)	I <sub>R1</sub>	2	μA
<b>Reverse Leakage Current</b> (Rated V <sub>R</sub> , T <sub>A</sub> = 100°C, 300μs pulse minimum)	I <sub>R2</sub>	0.40	mA
<b>Reverse Recovery Time</b> (I <sub>F</sub> = 0.5A, I <sub>R</sub> = 1.0A, I <sub>RR</sub> = 0.25A)	t <sub>RR</sub>	80	nsec

<sup>1/</sup> T<sub>A</sub> = 25°C, Unless otherwise specified

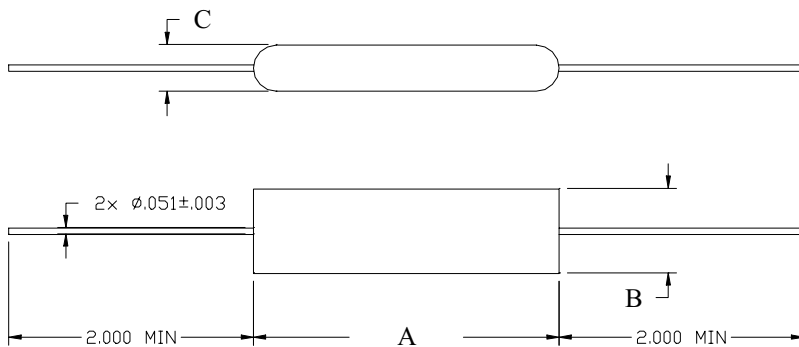
**CASE OUTLINE: HV STICK**

PART NUMBER	A ± .030	B ± .020	C ± .010
SDA2500UF	1.125	0.500	0.250
SDA5000UF	1.125	0.500	0.250
SDA7500UF	1.625	0.500	0.250
SDA10000UF	2.000	0.500	0.250
SDA12500UF	2.375	0.500	0.250
SDA15000UF	2.750	0.500	0.250
SDA20000UF	3.500	0.500	0.250
SDA25000UF	4.250	0.500	0.250