

200 V - 1,000 V Single Phase Bridge

12.0 A Forward Current

70 ns - 3000 ns Recovery Time

1402 - 1410
1402F - 1410F
1402UF - 1410UF

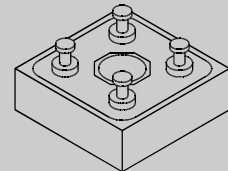

ELECTRICAL CHARACTERISTICS AND MAXIMUM RATINGS

Part Number	Working Reverse Voltage (Vrwm)	Average Rectified Current @TC (Io)		Reverse Current @ Vrwm (Ir)		Forward Voltage (Vf)		1 Cycle Surge Current tp=8.3ms (Ifsm)	Repetitive Surge Current (Ifrm)	Reverse Recovery Time (1) (Trr)	Thermal Impd. θ_{J-C}
		55°C	100°C	25°C	100°C	25°C	Amps	25°C	25°C	25°C	°C/W
		Amps	Amps	µA	µA	Volts		Amps	Amps	ns	
1402 1406 1410	200 600 1000	12.0 12.0 12.0	9.0 9.0 9.0	1.0 1.0 1.0	25 25 25	1.1 1.1 1.1	3.0 3.0 3.0	150 150 150	25 25 25	3000 3000 3000	3.2 3.2 3.2
1402F 1406F 1410F	200 600 1000	12.0 12.0 12.0	9.0 9.0 9.0	1.0 1.0 1.0	25 25 25	1.2 1.5 1.5	3.0 3.0 3.0	100 100 100	20 20 20	150 150 150	3.2 3.2 3.2
1402UF 1406UF 1410UF	200 600 1000	12.0 12.0 12.0	9.0 9.0 9.0	1.0 1.0 1.0	25 25 25	1.7 1.7 1.7	3.0 3.0 3.0	100 100 100	20 20 20	70 70 70	3.2 3.2 3.2

(1)Trr Testing: If=0.5A, Ir=1.0A, Irr=0.25A *Op. Temp. & Stg. Temp. = -55°C to +150°C Isolation Voltage: 1500V

10

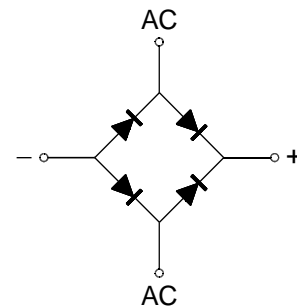
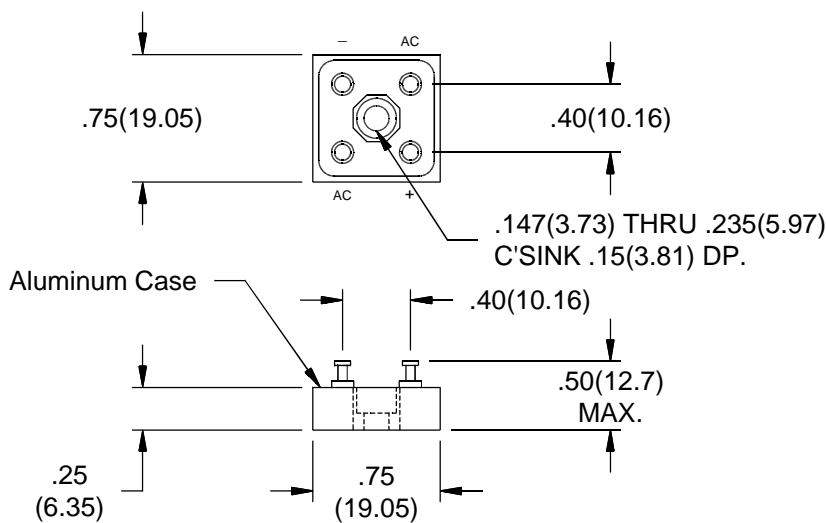

Dimensions: In. (mm) • All temperatures are ambient unless otherwise noted. • Data subject to change without notice.



VOLTAGE MULTIPLIERS INC.
 8711 W. Roosevelt Ave.
 Visalia, CA 93291

TEL 559-651-1402
 FAX 559-651-0740
 www.voltagemultipliers.com

1402 - 1410 • 1402F - 1410F • 1402UF - 1410UF

