

## LO566TYL4-70H

### Features

All Plastic Mold Type  
 High Luminous Intensity  
 Low Current Requirement  
 Tinted Diffused Lens  
 Wide Viewing Angle Up To 70° x 45°  
 This Product DOES NOT Have Stand-Offs

### Applications

Backlighting  
 Full Color/RGB Video Signs  
 Time/Temperature Boards  
 VMS

### Maximum Ratings (Ta=25°C)

| Characteristic        | Symbol           | Max.           | Unit |
|-----------------------|------------------|----------------|------|
| Forward Current       | I <sub>F</sub>   | 50             | mA   |
| Reverse Voltage       | V <sub>R</sub>   | 5              | V    |
| Power Dissipation     | P <sub>D</sub>   | 150.00         | mW   |
| Operating Temperature | T <sub>opr</sub> | -40 ~ +95      | °C   |
| Storage Temperature   | T <sub>stg</sub> | -40 ~ +100     | °C   |
| Soldering Temperature | T <sub>sol</sub> | 260            | °C   |
| Soldering Time        | -                | for 5 sec. max | -    |

### Opto-Electrical Characteristics (Ta=25°C)

| Characteristic           | Symbol            | Test Condition       | Min    | Typ       | Max  | Unit |
|--------------------------|-------------------|----------------------|--------|-----------|------|------|
| Forward Voltage          | V <sub>F</sub>    | I <sub>F</sub> =20mA | 1.70   | 2.10      | 2.60 | V    |
| Reverse Current          | I <sub>R</sub>    | V <sub>R</sub> =5V   | -      | -         | 100  | μA   |
| Luminous Intensity       | I <sub>v</sub>    | I <sub>F</sub> =20mA | 550.00 | 800.00    | -    | mcd  |
| Viewing Angle            | 2θ <sup>1/2</sup> | -                    | -      | 70° x 40° | -    | deg. |
| Peak Wavelength          | λ <sub>p</sub>    | I <sub>F</sub> =20mA | -      | 594       | -    | nm   |
| Dominant Wavelength      | λ <sub>d</sub>    | I <sub>F</sub> =20mA | -      | 591       | -    | nm   |
| Spectral Line Half Width | Δλ                | I <sub>F</sub> =20mA | -      | 20        | -    | nm   |

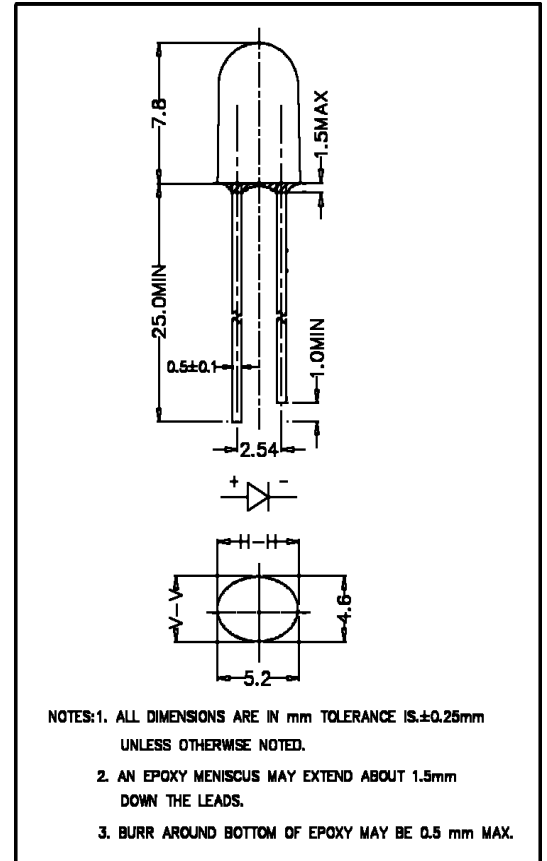

## LO566TYL4-70H Graphs

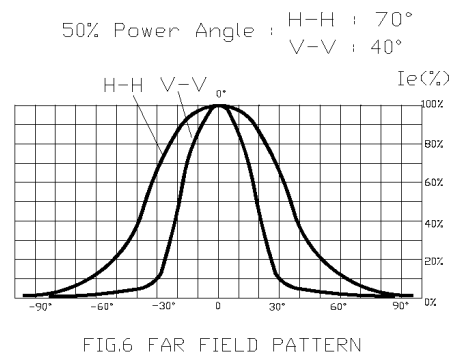
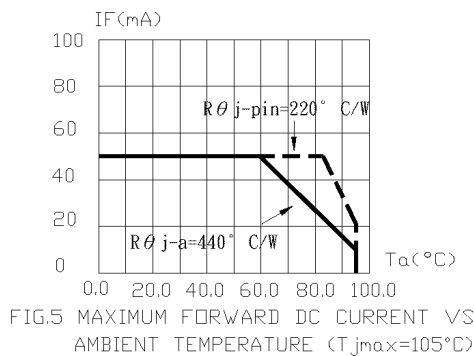
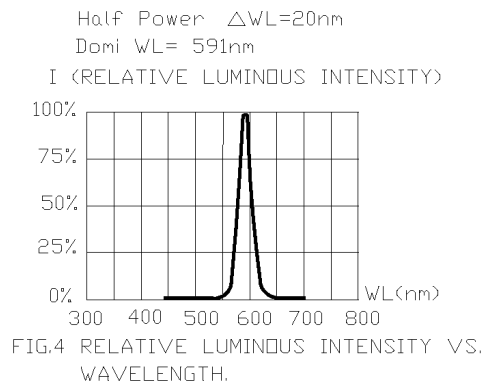
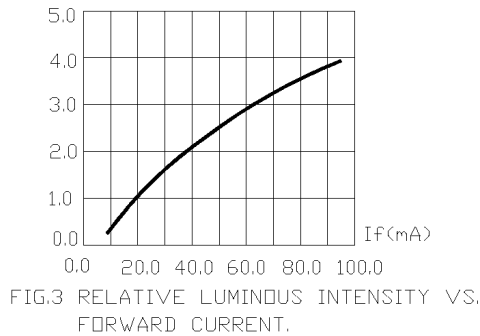
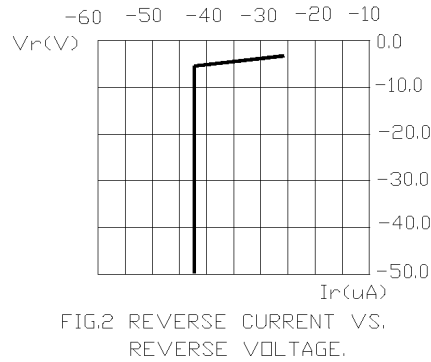
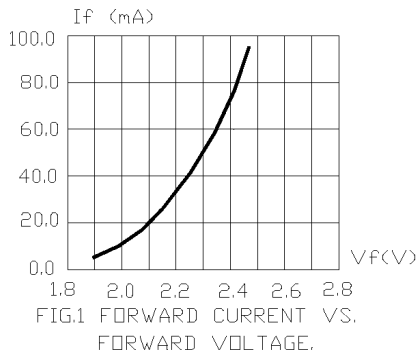

1. Cathode PAD Area ( $0.18 \times 0.18\text{inch}^2$ )
2. Height above nominal seating plane in inches(0.3inch)