

MS-228-5

Mains switching Reed Sensor • M8 thread



Electrical Characteristics

Contact form		A
Contact rating max.	W / VA	10
Switching current max.	A	0.5
Carry current max.	A	1.5
Switching voltage max.	VDC	200
	VAC	260
Breakdown voltage min.	VDC	450
Contact resistance (initial) max.	mΩ	100
Insulation resistance min.	Ω	10 ¹⁰
Capacitance typ.	pF	0.2

Magnetical Characteristics

Pull in range available ¹	AT	20-35
--------------------------------------	----	-------

¹ AT range stated for unmodified Reed Switch

Operating Characteristics

Operate time (incl. bounce) max.	ms	0.6
Release time max.	ms	0.2
Switching frequency max.	Hz	400
Resonant frequency typ.	Hz	3,900
Vibration (50-2000 Hz)	g	30
Shock (1/2 sin 11 ms)	g	100
Operating temperature	°C	-20 to +85

Dimensions

in mm

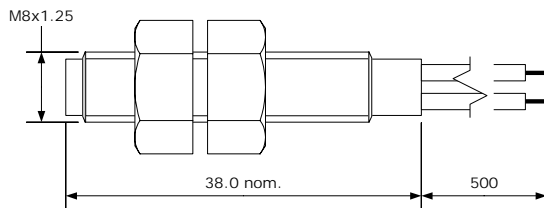

Wire: AWG 24, black, stripped and tinned

Ordering Information

Series	AT Range
MS-228-5	3 = 20-25 / 4 = 25-30 / 5 = 30-35

Ordering example: MS-228-5-3 describes MS-228-5 with 20-25 AT

Customized types available.

MS-228-5
Mains switching Reed Sensor • M8 thread



Matching Actuator MSM-228

in mm

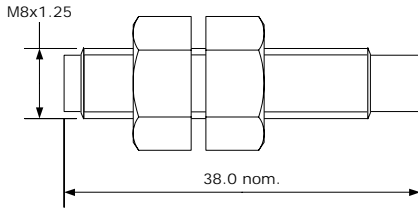

Customized types and other magnet orientations available.