

# STUART TURNER LTD

## General Information

Designed for pumping clean water. The portable Jet pump is ideal for many household and light industrial uses. Pressure washing, lawn watering, water transfer and pressure boosting are just a few of its applications.

Supplied ready to run, the Jet pump comes with power cable and plug fitted. For easy local control, an on/off switch is featured on the motor.

Initially prime the pump head with clean water and the Stuart Jet pump will self prime up to 7 metres.

The electric motor is built for continuous use with fan cooling and built in thermal overload protection.



## Operating Conditions

Max. Water Temp.	35°C
Min. Water Temp.	4°C
Max. Suction Lift	7m
Max. Ambient Temp.	40°C
Max. Inlet Pressure	0.5 bar

## Pump Connection Sizes

Inlet:	G1 Female
Outlet:	G1 Female

## Performance Curves

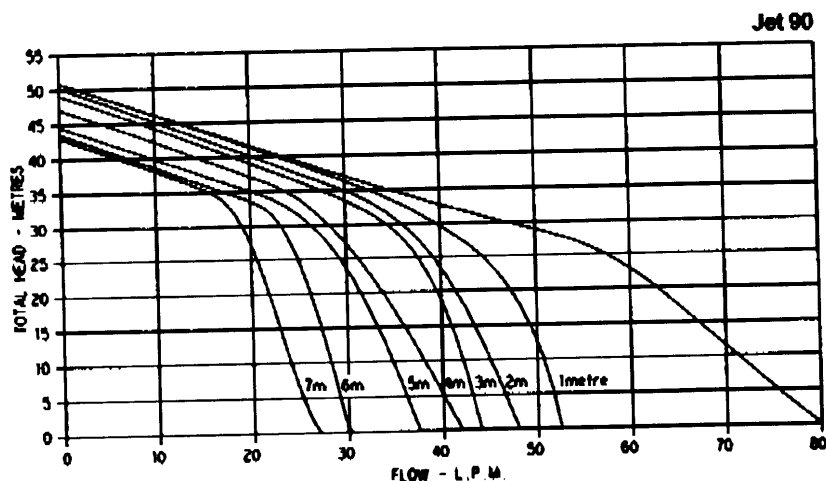
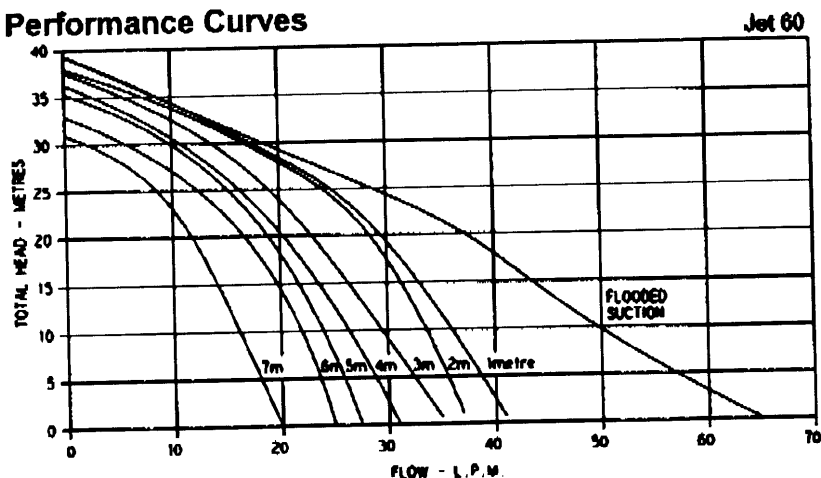

DATA SHEET J100

SELF PRIMING JET RANGE

## Electrical

Model	Nominal Watts Output	Max. Watts Consumed At Full Flow	Amps Full Load	Enclosure Designation	Voltage
Jet 60	540	780	3.5	I.P. 44	230
Jet 90	834	1192	5.1	I.P. 44	230

## Electrical Rating

Motors are induction type suitable for continuous running and are wound for 230V, 1 phase, 50Hz as standard.

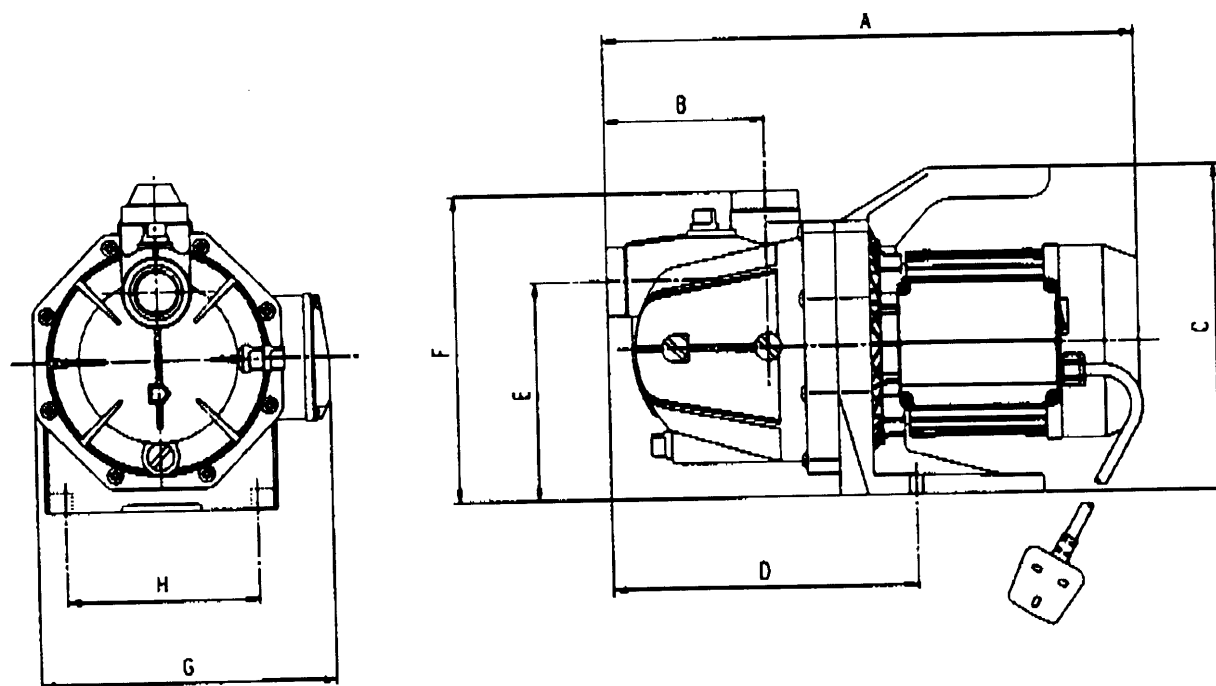

## Dimensions (mm)

Model	A	B	C	D	E	F	G	H
Jet 60	400	120	240	230	160	225	230	145
Jet 90	400	120	240	230	160	225	230	145

## Packaging Specification

Model	Carton Dimensions L x W x H (mm)	Gross Weight (Kg)
Jet 60	410 x 300 x 325	11.9
Jet 90	410 x 300 x 325	13.6

Stuart Turner Limited reserves the right to amend specifications without notice.

# STUART TURNER LTD

Stuart Turner Ltd, Henley-on-Thames, Oxfordshire RG9 2AD ENGLAND  
 Tel: Sales +44 (0) 1491 572655, Service +44 (0) 1491 579997  
 Fax: +44 (0) 1491 573704  
 email: [pumps@stuart-turner.co.uk](mailto:pumps@stuart-turner.co.uk) web: [www.stuart-turner.co.uk](http://www.stuart-turner.co.uk)