

### 1. PART NO. EXPRESSION :

SSC06033R0YZF-□□  
 (a) (b) (c) (d)(e)(f) (g)

- (a) Series code
- (b) Dimension code
- (c) Inductance code : 3R0 = 3.00uH
- (d) Tolerance code : Y = ±30%
- (e) X, Y, Z : Standard part
- (f) F : RoHS Compliant
- (g) 11 ~ 99 : RoHS Compliant

### 2. CONFIGURATION & DIMENSIONS :

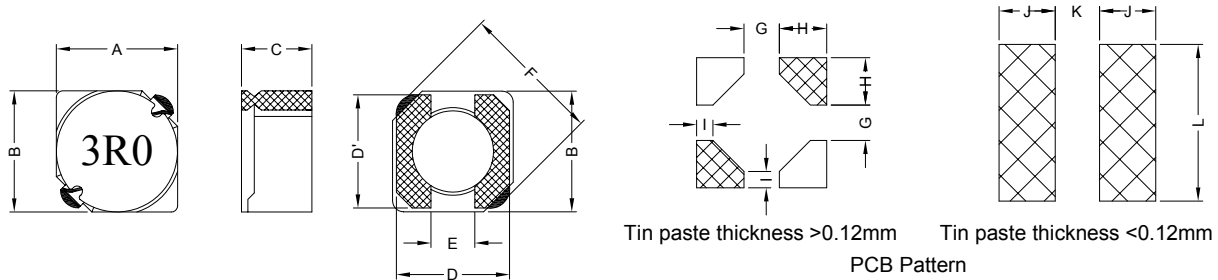

Unit:m/m

| A         | B         | C         | D         | D'        | E         | F         |
|-----------|-----------|-----------|-----------|-----------|-----------|-----------|
| 6.70±0.3  | 6.70±0.3  | 3.00 Max. | 6.50 Ref. | 6.50 Ref. | 2.00 Ref. | 9.50 Max. |
| G         | H         | I         | J         | K         | L         |           |
| 2.20 Ref. | 2.55 Max. | 0.95 Max. | 2.65 Ref. | 2.00 Ref. | 7.30 Ref. |           |

### 3. SCHEMATIC :

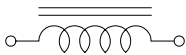

### 4. MATERIALS :

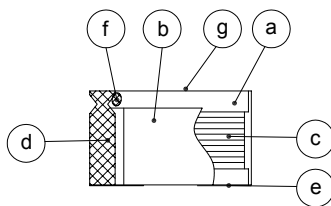

- (a) Core : DR Ferrite Core
- (b) Core : RI Ferrite Core
- (c) Wire : Enamelled Copper Wire
- (d) Terminal : Au+Ni Copper Plate
- (e) Adhesive : Epoxy
- (f) Adhesive : Epoxy
- (g) Ink : Bon Margue



**RoHS Compliant**

NOTE : Specifications subject to change without notice. Please check our website for latest information.

04.10.2010



**SUPERWORLD ELECTRONICS (S) PTE LTD**

## 5. GENERAL SPECIFICATION :

- a) Temp. rise : 30°C Typ. at rated current
- b) Rated current : Base on temp. rise &  $\Delta L/L0A = 35\%$  Typ.
- c) Storage temp. : -40°C to +125°C
- d) Operating temp. : -40°C to +95°C
- e) Resistance to solder heat : 260°C.10 secs

## 6. ELECTRICAL CHARACTERISTICS :

| Part No.         | Inductance<br>( $\mu\text{H}$ ) | Test<br>Frequency<br>( Hz ) | RDC<br>( m $\Omega$ )<br>Max. | IDC<br>( A )<br>Max. |
|------------------|---------------------------------|-----------------------------|-------------------------------|----------------------|
| SSC06033R0YZF-□□ | 3.0 $\pm 30\%$                  | 0.5V / 10K                  | 24                            | 3.00                 |
| SSC06033R9YZF-□□ | 3.9 $\pm 30\%$                  | 0.5V / 10K                  | 27                            | 2.60                 |
| SSC06035R0YZF-□□ | 5.0 $\pm 30\%$                  | 0.5V / 10K                  | 31                            | 2.40                 |
| SSC06036R0YZF-□□ | 6.0 $\pm 30\%$                  | 0.5V / 10K                  | 35                            | 2.25                 |
| SSC06037R3YZF-□□ | 7.3 $\pm 30\%$                  | 0.5V / 10K                  | 54                            | 2.10                 |
| SSC06038R6YZF-□□ | 8.6 $\pm 30\%$                  | 0.5V / 10K                  | 58                            | 1.85                 |
| SSC0603100YZF-□□ | 10.0 $\pm 30\%$                 | 0.5V / 10K                  | 65                            | 1.70                 |
| SSC0603120YZF-□□ | 12.0 $\pm 30\%$                 | 0.5V / 10K                  | 70                            | 1.55                 |
| SSC0603150YZF-□□ | 15.0 $\pm 30\%$                 | 0.5V / 10K                  | 84                            | 1.40                 |
| SSC0603180YZF-□□ | 18.0 $\pm 30\%$                 | 0.5V / 10K                  | 95                            | 1.32                 |
| SSC0603220YZF-□□ | 22.0 $\pm 30\%$                 | 0.5V / 10K                  | 128                           | 1.20                 |
| SSC0603270YZF-□□ | 27.0 $\pm 30\%$                 | 0.5V / 10K                  | 142                           | 1.05                 |
| SSC0603330YZF-□□ | 33.0 $\pm 30\%$                 | 0.5V / 10K                  | 165                           | 0.97                 |
| SSC0603390YZF-□□ | 39.0 $\pm 30\%$                 | 0.5V / 10K                  | 210                           | 0.86                 |
| SSC0603470YZF-□□ | 47.0 $\pm 30\%$                 | 0.5V / 10K                  | 238                           | 0.80                 |
| SSC0603560YZF-□□ | 56.0 $\pm 30\%$                 | 0.5V / 10K                  | 277                           | 0.73                 |
| SSC0603680YZF-□□ | 68.0 $\pm 30\%$                 | 0.5V / 10K                  | 304                           | 0.65                 |
| SSC0603820YZF-□□ | 82.0 $\pm 30\%$                 | 0.5V / 10K                  | 390                           | 0.60                 |
| SSC0603101YZF-□□ | 100.0 $\pm 30\%$                | 0.5V / 10K                  | 535                           | 0.54                 |



**RoHS Compliant**

NOTE : Specifications subject to change without notice. Please check our website for latest information.

04.10.2010



**SUPERWORLD ELECTRONICS (S) PTE LTD**

## 7. CHARACTERISTICS CURVES :

@ TEMP. RISE VS. DC SUPERPOSITION RESPONSE CURVE

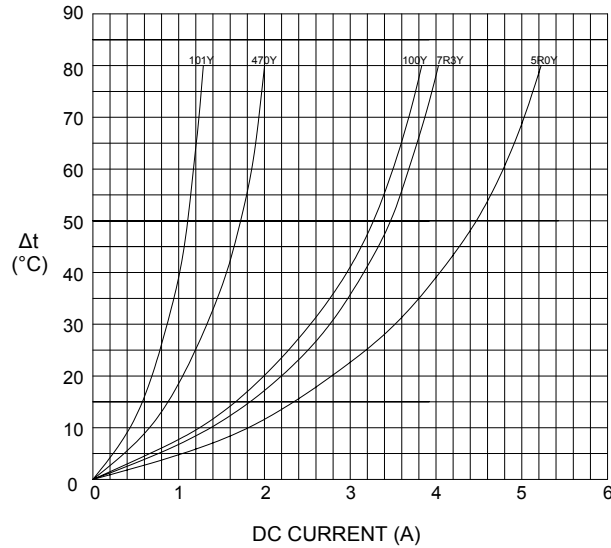

@ INDUCTANCE VS. FREQUENCY RESPONSE CURVE

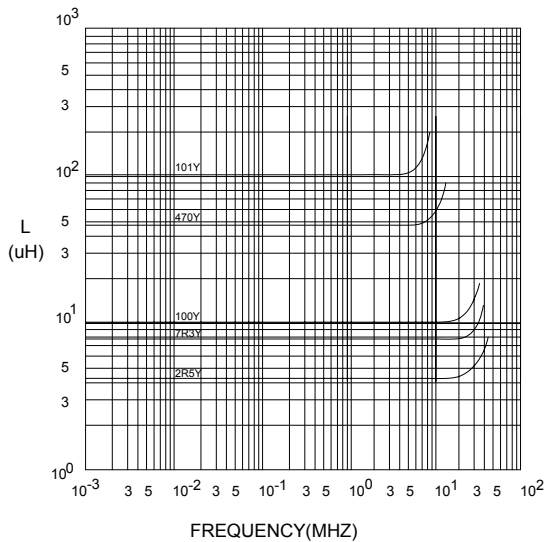

@ INDUCTANCE VS. DC SUPERPOSITION RESPONSE CURVE

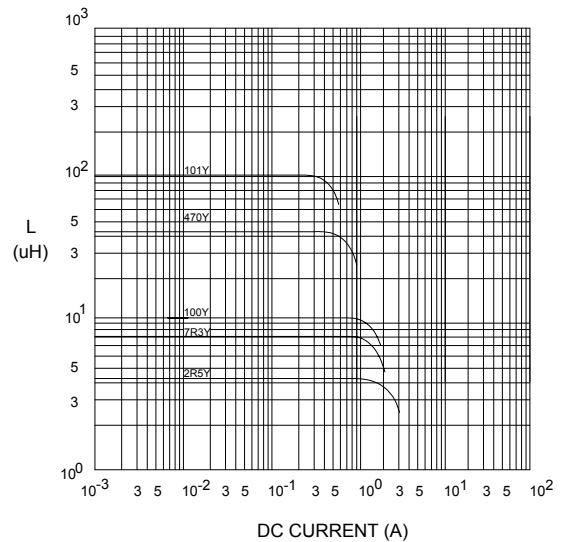

**RoHS Compliant**

NOTE : Specifications subject to change without notice. Please check our website for latest information.

04.10.2010



**SUPERWORLD ELECTRONICS (S) PTE LTD**

### RECOMMENDED SOLDERING CONDITIONS REFLOW SOLDERINGS

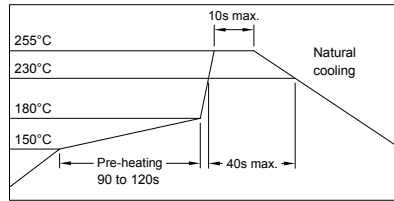

### 8. PACKAGING INFORMATION :

#### ( 1 ) CONFIGURATION

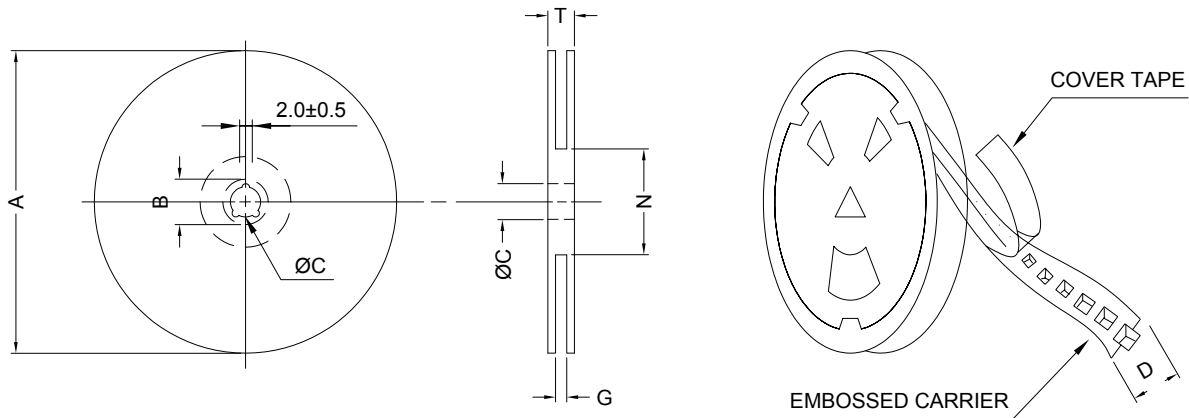

\* CARRIER TAPE WIDTH : D

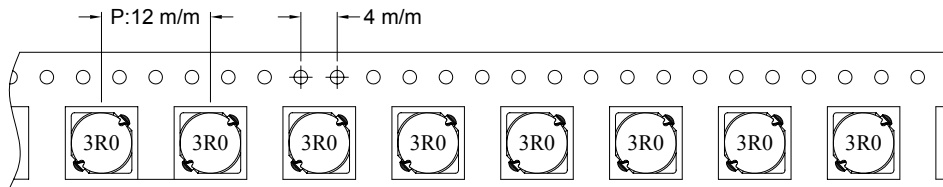

#### ( 2 ) DIMENSIONS

Unit:m/m

| STYLE | A   | B      | C  | D  | G                | N                | T    |
|-------|-----|--------|----|----|------------------|------------------|------|
| 13-16 | 330 | 21±0.8 | 13 | 16 | 18 <sup>+0</sup> | 50 <sup>-0</sup> | 22.4 |

#### ( 3 ) Q'TY & G.W. PER PACKAGE

| SERIES  | INNER : REEL |           |       | OUTER : CARTON |           |              |
|---------|--------------|-----------|-------|----------------|-----------|--------------|
|         | Q'TY (PCS)   | G.W. (gw) | STYLE | Q'TY (PCS)     | G.W. (Kg) | SIZE (cm)    |
| SSC0603 | 1000         | 600       | 13-16 | 6000           | 7.1       | 40 x 40 x 24 |



**RoHS Compliant**

NOTE : Specifications subject to change without notice. Please check our website for latest information.

04.10.2010



**SUPERWORLD ELECTRONICS (S) PTE LTD**

**9. RELIABILITY AND TEST CONDITION :**

| TEST ITEM                                 | SPECIFICATION   | TEST CONDITION  |            |   |         |            |  |            |            |   |        |            |  |            |
|---|---|---|------------|---|---------|------------|--|------------|------------|---|--------|------------|--|------------|
| SOLDERABILITY                             | MORE THAN 90% OF THE TERMINAL ELECTRODE SHALL BE COVERED WITH FRESH SOLDER. | PREHEAT : 125±25°C FOR 60 SECONDS<br>SOLDER : 99%Sn/0.3%Ag/0.7%Cu OR EQUIVALENT<br>SOLDER TEMP. : 245±5°C<br>FLUX : ROSIN<br>DIP TIME : 4±1 SECONDS   |            |   |         |            |  |            |            |   |        |            |  |            |
| THERMAL SHOCK TEST<br><br>( TEMP. CYCLE ) | INDUCTANCE SHALL NOT CHANGE MORE THAN ±20%                                  | <table border="0"> <tr> <td>ROOM TEMP.</td> <td>→</td> <td>-25±2°C</td> </tr> <tr> <td>15 MINUTES</td> <td></td> <td>30 MINUTES</td> </tr> <tr> <td>ROOM TEMP.</td> <td>→</td> <td>85±2°C</td> </tr> <tr> <td>15 MINUTES</td> <td></td> <td>30 MINUTES</td> </tr> </table> <p>TOTAL : 50 CYCLES</p> | ROOM TEMP. | → | -25±2°C | 15 MINUTES |  | 30 MINUTES | ROOM TEMP. | → | 85±2°C | 15 MINUTES |  | 30 MINUTES |
| ROOM TEMP.                                | →   | -25±2°C   |            |   |         |            |  |            |            |   |        |            |  |            |
| 15 MINUTES                                |   | 30 MINUTES  |            |   |         |            |  |            |            |   |        |            |  |            |
| ROOM TEMP.                                | →   | 85±2°C  |            |   |         |            |  |            |            |   |        |            |  |            |
| 15 MINUTES                                |   | 30 MINUTES  |            |   |         |            |  |            |            |   |        |            |  |            |
| HUMIDITY RESISTANCE TEST                  |   | TEMPERATURE : 40±2°C<br>HUMIDITY : 90 ~ 95%<br>APPLIED CURRENT : PER SPEC.<br>TIME : 500 HOURS  |            |   |         |            |  |            |            |   |        |            |  |            |
| HIGH TEMP. RESISTANCE TEST                |   | TEMPERATURE : 85±2°C<br>APPLIED CURRENT : PER SPEC.<br>TIME : 500 HOURS   |            |   |         |            |  |            |            |   |        |            |  |            |

**10. UL CARD :**

|  |    |                          |                                      |
|--|----|--------------------------|--------------------------------------|
| <b>OBMW2</b>   |    | <b>November 30, 2000</b> |                                      |
| <b>Magnet Wire - Component</b>   |    |                          |                                      |
| PACIFIC ELECTRIC WIRE & CABLE (SHENZHEN) CO LTD<br>607 BAOLONG INDUSTRIAL ESTATE LONGGANG, SHENZHEN<br>GUANGDONG CHINA |    |                          | E201757                              |
| Mtl Dsg  | BC | Coating Type             | ANSI Type                            |
| UEW/U  |    | Polyurethane             | — 130                                |
| PEW/U  |    | Polyester                | — MW5-C 155°C                        |
| PEWH/U   |    | Modified Polyester       | — MW30-C 180                         |
| PEW-NY/U   |    | Polyester                | — Polyamide MW24-C 155               |
| HAI/U  |    | Polyester(Amide)(Imide)  | — Polyamideimide MW35,73 200         |
| UEW-NY/U   |    | Polyurethane             | — Polyamide MW80-C 155<br>MW28-C 130 |

Marking: Company name and material designation or marked designation on package or reel, and Recognized Component Mark.

See General Information Preceding These Recognitions

1/3/2001                      Underwriters Laboratories Inc.                      Card 1 of 2



**RoHS Compliant**

NOTE : Specifications subject to change without notice. Please check our website for latest information.

04.10.2010