

**PPR1510E**  
**45 VOLTS, 10 AMP**  
**SCHOTTKY RECTIFIER**

**DESIGNER'S DATA SHEET**

**FEATURES:**

- **Low Reverse Leakage**
- **Low Forward Voltage Drop**
- **TX, TXV and Space Level Screening Available**
- **Hermetically Sealed Power Surface Mount Package**
- **Guard Ring for Overvoltage protection**
- **Eutectic Die Attach**
- **175 °C Operating Temperature**

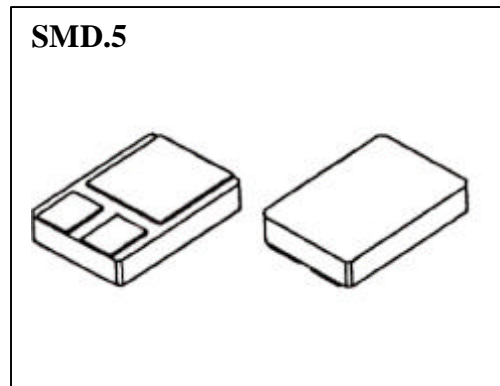

**MAXIMUM RATINGS**

<b>RATING</b>	<b>SYMBOL</b>	<b>VALUE</b>	<b>UNIT</b>
<b>Peak Repetitive Reverse and DC Blocking Voltage</b>	$V_{RRM}$ $V_{RWN}$ $V_R$	<b>100</b>	<b>Volts</b>
<b>Average Rectified Forward Current</b> (Resistive Load, 60Hz, Sine Wave, $T_A = 25^\circ\text{C}$ )	<b><math>I_o</math></b>	<b>15</b>	<b>Amps</b>
<b>Peak Surge Current</b> (8.3 ms Pulse, $T_A = 25^\circ\text{C}$ )	<b><math>I_{FSM}</math></b>	<b>250</b>	<b>Amps</b>
<b>Operating and storage temperature</b>	<b>Top &amp; Tstg</b>	<b>-55 to + 175</b>	<b>°C</b>
<b>Maximum Thermal Resistance</b> Junction to Case	<b><math>R_{\theta JC}</math></b>	<b>2.0</b>	<b>°C/W</b>

**FOR MORE INFORMATION CALL 1-800-327-6183**

## ELECTRICAL CHARACTERISTICS

CHARACTERISTICS	SYMBOL	MAX.	UNIT
<b>Instantaneous Forward Voltage Drop</b> ( $I_F = 5 \text{ Adc}$ , $T_A = 25^\circ\text{C}$ , 300 $\mu\text{s}$ Pulse) ( $I_F = 10 \text{ Adc}$ , $T_A = 25^\circ\text{C}$ , 300 $\mu\text{s}$ Pulse)	$V_{F1}$	0.780 1.10	Vdc
<b>Instantaneous Forward Voltage Drop</b> ( $I_F = 5 \text{ Adc}$ , $T_A = 100^\circ\text{C}$ , 300 $\mu\text{s}$ Pulse)	$V_{F2}$	0.870	Vdc
<b>Reverse Leakage Current</b> (Rated VR, $T_A = 25^\circ\text{C}$ , 300 $\mu\text{s}$ pulse minimum)	$I_{R1}$	100	mA
<b>Reverse Leakage Current</b> (Rated VR, $T_A = 100^\circ\text{C}$ , 300 $\mu\text{s}$ pulse minimum)	$I_{R2}$	10	mA
<b>Junction Capacitance</b> $V_R = 10 \text{ V}$ , $T_A = 25^\circ\text{C}$ , $f = 1 \text{ MHz}$ )	$C_J$	800	pF

### CASE OUTLINE: SMD.5

#### PIN OUT:

- PIN 1: CATHODE**
- PIN 2: ANODE**
- PIN 3: ANODE**

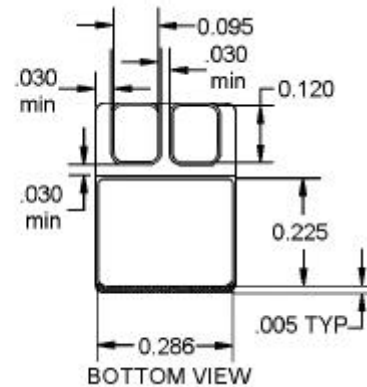
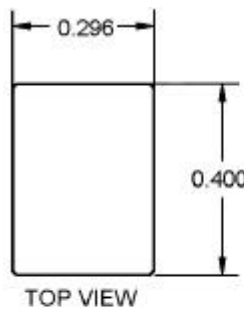

### TYPICAL OPERATING CURVES

( $T_A = 25^\circ\text{C}$  Unless otherwise specified)

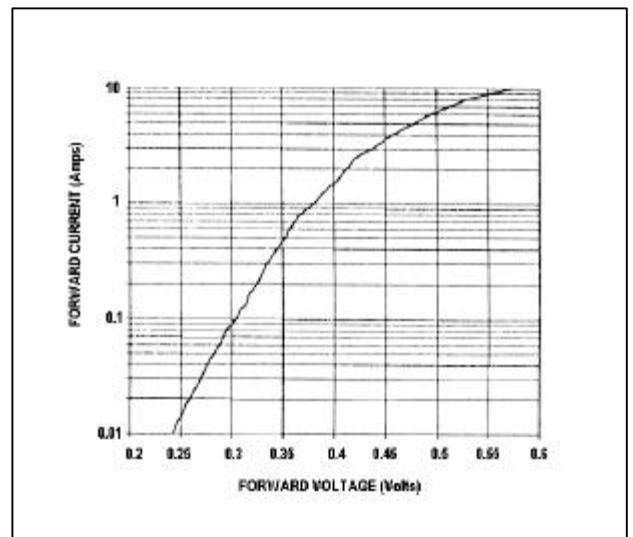
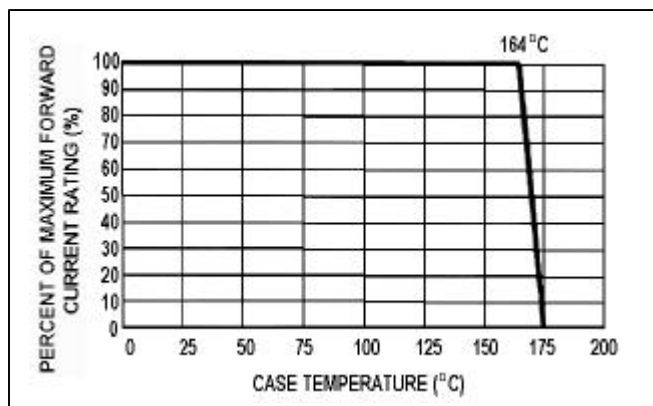

**FOR MORE INFORMATION CALL 1-800-327-6183**