

# SINGLE COLOR LED

3.6mm Side View Shape

## 4361F / 4371F Series

STANDARD COLOR



### Outline Dimensions

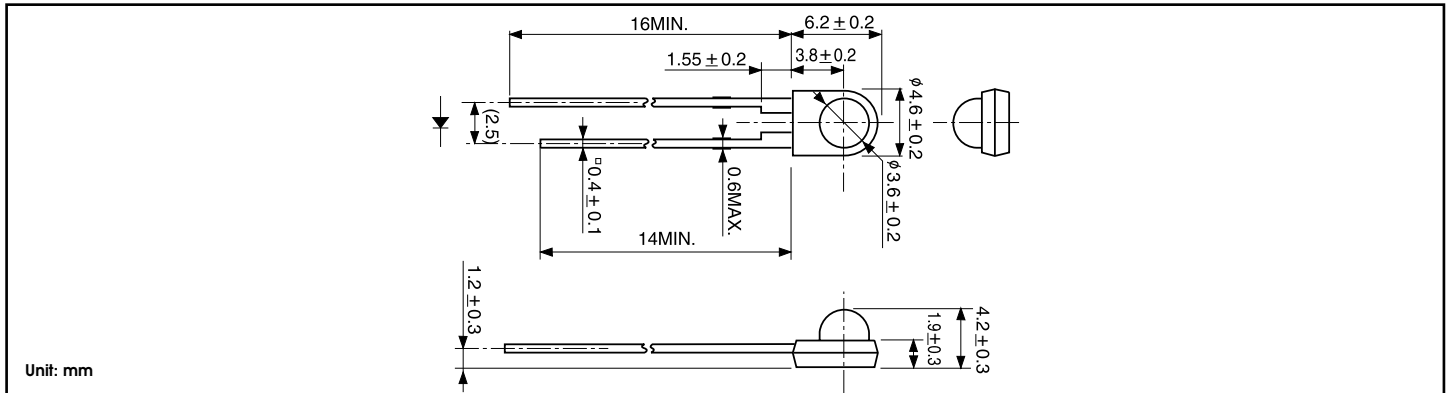

### Absolute Maximum Ratings

(Ta=25°C)

Item	Symbol	Red			Orange	Yellow	Yellow Green	Green	Pure Green	Units
		BR	MPR	MVR	MAA	MAY	MPY	MPG	MBG	
Power Dissipation	Pd	100	75	75	70	85	85	70	70	mW
Forward Current	If	50	30	30	25	30	30	25	25	mA
Peak Forward Current	IfM	300	75	75	60	75	75	60	60	mA
Reverse Voltage	Vr	4	4	4	4	4	4	4	4	V
Operating Temperature	Topr	-30 to +85								°C
Storage Temperature	Tstg	-30 to +100								°C
Derating (DC)*	If	0.67	0.40		0.33	0.40		0.33		mA/°C

\* Ta=25°C, IfM applies for the pulse width 1msec. and duty cycle 1/20  
The current derating for operation applies when the temperature is above 25°C

### Electro-Optical Characteristics

\*4361F lens is clear and 4371F lens is diffused

\*\*The viewing angle is an average and will vary by color (Ta=25°C)

Part No.	Material	Emitted Color	Lens Color*	Luminous Intensity I <sub>v</sub>			Wavelength Spectral Line Dominant Half Width				Forward Voltage V <sub>f</sub>			Reverse Current I <sub>r</sub>		Viewing Angle** (2 1/2)
				MIN.	TYP.	If	Peak P TYP.	Dominant d TYP.	TYP.	If	TYP.	MAX.	If	MAX.	Vr	
				mcd		mA	nm		mA	V	mA	µA	V	Deg.		
BR4361F/4371F	GaAlAs	Red	Pastel Red	10/5	20/10	20	660	647	30	20	1.7	2.0	20	100	4	80/110°
MPR4361F/4371F	GaP			0.6/0.5	1.2/1	10	700	635	100	10	2.1	2.8	10	20	4	
MVR4361F/4371F	GaAsP			4/3	8/6	20	630	624	30	20	2.0	2.8	20	20	4	
MAA4361F/4371F	GaAsP	Orange	Pastel Orange	5/4	10/8	20	605	606	30	20	2.2	2.8	20	20	4	
MAY4361F/4371F	GaAsP	Yellow	Pastel Yellow	5/4	10/8	20	580	590	30	20	2.2	2.8	20	20	4	
MPY4361F/4371F	GaP	Yellow Green		6/5	12/10	20	570	572	30	20	2.1	2.8	20	20	4	
MPG4361F/4371F	GaP	Green	Pastel Green	5/3	10/6	20	560	567	30	20	2.1	2.8	20	20	4	
MBG4361F/4371F	GaP	Pure Green	3/1.5	6/3	20	555	558	30	20	2.1	2.8	20	20	4		
Units				mcd		mA	nm		mA	V	mA	µA	V	Deg.		

### Spatial Distribution (x)

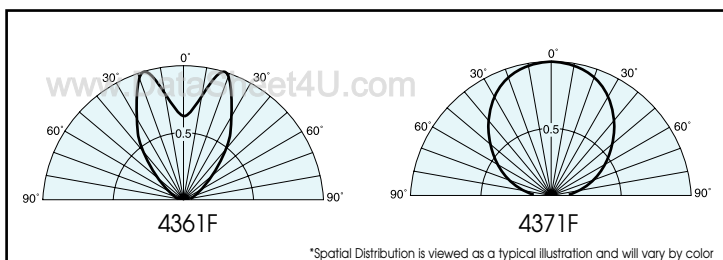

### Operation Current Derating Chart

