

**Data Display Products®**
**T-1<sup>3</sup>/<sub>4</sub> PCB MOUNT LEDs**
*Variable Array, Standard*

- Red, Amber, Amber/Yellow, Yellow, Green, Blue
- 2 to 16 LEDs per Array
- For Detailed LED Data, See Discrete Section, MODEL 200

Model		LED(Model 200)				
		Color	λpk (nm)	Iv[1] (mcd)	Description	
PCLR200N[2]	Horizontal Array	-ER	RED	660	30	Diffused
		-UR	RED	660	120	Diffused
		-ECR	RED	660	160	Non-Diffused
		-EWR	RED	660	160	Water Clear
		-UCR	RED	660	400	Non-Diffused
		-UWR	RED	660	400	Water Clear
		-R2K	RED	650	2000	Water Clear
		-R3K	RED	650	3000	Water Clear
		-R1K	RED	645	1000	Water Clear
		-MR	RED	635	15	Diffused
		-BR	RED	635	14	Diffused
		-MCR	RED	635	100	Non-Diffused
		-BCR	RED	635	120	Non-Diffused
		-EA	AMB	605	24	Diffused
		-UA	AMB	605	80	Diffused
		-ECA	AMB	605	90	Non-Diffused
		-EWA	AMB	605	90	Water Clear
		-UCA	AMB	605	200	Non-Diffused
		-UWA	AMB	605	200	Water Clear
		-A3K	AMB	594	3000	Water Clear
		-MA	AMB	585	15	Diffused
		-MCA	AMB	585	90	Non-Diffused
		-BA	AMB	583	16	Diffused
		-BCA	AMB	583	100	Non-Diffused
		-EAY	AMB/YEL	580	24	Diffused
		-UAY	AMB/YEL	580	60	Diffused
		-ECAY	AMB/YEL	580	90	Non-Diffused
		-EWAY	AMB/YEL	580	90	Water Clear
		-UCAY	AMB/YEL	580	200	Non-Diffused
		-UWAY	AMB/YEL	580	200	Water Clear
		-EY	YEL	570	45	Diffused
		-UY	YEL	570	100	Diffused
		-BCY	YEL	570	160	Non-Diffused
		-EY	YEL	570	160	Water Clear
		-UCY	YEL	570	350	Non-Diffused
		-UWY	YEL	570	350	Water Clear
		-BG	GRN	565	10	Diffused
		-BCG	GRN	565	140	Non-Diffused
		-MG	GRN	562	20	Diffused



\*\* continued \*\*



Data Display Products®

**T-1<sup>3</sup>/<sub>4</sub> PCB MOUNT LEDs**  
Variable Array, Standard

Model	LED(Model 200)			
	Color	λpk (nm)	Iv[1] (mcd)	Description
<b>-MCG</b>	GRN	562	100	Non-Diffused
<b>-BG</b>	GRN	555	12	Diffused
<b>-UG</b>	GRN	555	40	Diffused
<b>-BCG</b>	GRN	555	80	Non-Diffused
<b>-EWG</b>	GRN	555	80	Water Clear
<b>-UCG</b>	GRN	555	200	Non-Diffused
<b>-UWG</b>	GRN	555	200	Water Clear
<b>-SCB</b>	BLU	470	7	Non-Diffused
<b>-SMB</b>	BLU	468	3	Diffused
<b>-SWB</b>	BLU	468	12	Water Clear

[1] Iv = typical luminous intensity @ If = 20mA(Ta = 25°C). For "U" Series LEDs, If=40mA.

[2] Replace N with the number of LEDs in the array, 2 - 16 (e.g. PCLR2006).

**To Order:** Select one **BOLD** component from each **SHADED** column in the table except as noted.

**Examples:** **PCLR20011-BCR** (Model PCLR200, 11 LED Array, B Series, Non-Diffused, RED LEDs)  
**PCLR2003-UCY/UCG/UCY** (Model PCLR200, 3 LED Array, U Series, Non-Diffused YEL/GRN/YEL LEDs)

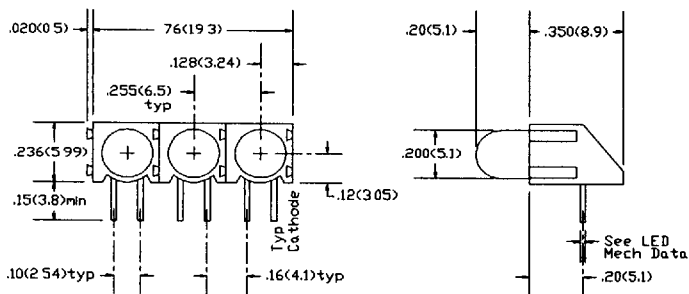

PCLR2003

All dimensions are in inches(mm)  
Tolerances: .xxx"(x) ± .025"(.63) / .xxx"(xx) ± .010"(.25)  
Specifications are subject to change without notice.



**Data Display Products®**

**T-1<sup>3</sup>/<sub>4</sub> PCB MOUNT LEDs**

*Variable Array, Specialty Operation*

- Low Power, Bi-Color, Blinking, Integrated Resistor
  - Red, Amber, Green
- For Detailed LED Data, See Discrete Section, MODEL 200

Model		LED(Model 200)				
		Color	λpk (nm)	Iv[1] (mcd)	Description	
<b>PCLR200N</b> [2]	Horizontal Array	<b>-RLP</b>	RED	635	2.0	Low Power
		<b>-ALP</b>	AMB	583	1.8	Low Power
		<b>-GLP</b>	GRN	565	1.8	Low Power
		<b>-LRG</b>	R/G	660/565	70/32	Bi-Color, Green Cathode
		<b>-BRB</b>	RED	660	22	Blinking
		<b>-RB</b>	RED	630	7	Blinking
		<b>-AB</b>	AMB	585	6	Blinking
		<b>-GB</b>	GRN	567	8	Blinking
		<b>-BR5V</b>	RED	635	8	Integrated Resistor for 5VDC
		<b>-BA5V</b>	AMB	583	8	Integrated Resistor for 5VDC
		<b>-BG5V</b>	GRN	565	8	Integrated Resistor for 5VDC
		<b>-BR12V</b>	RED	635	8	Integrated Resistor for 12VDC
		<b>-BA12V</b>	AMB	583	8	Integrated Resistor for 12VDC
		<b>-BG12V</b>	GRN	565	8	Integrated Resistor for 12VDC

[1] Iv = typical luminous intensity @ If = 20mA (Ta = 25°C). For Low Power LEDs, @ If = 2mA. For Integrated Resistor LEDs, @ Vf = 5VDC, or @ Vf = 12VDC.  
 [2] Replace N with the number of LEDs in the array, 2 - 16 (e.g. PCLR2006).

**To Order:** Select one **BOLD** component from each **SHADED** column in the table except as noted.

**Examples:** **PCLR2009-BR12V** (Model PCLR200, 9 LED Array, RED 12VDC Integrated Resistor LEDs)  
**PCLR2005-LRG** (Model PCLR200, 5 LED Array, Bi-Color LEDs)

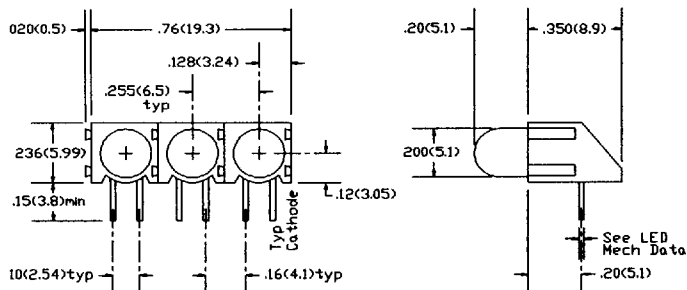

**PCLR2003**

All dimensions are in inches(mm)  
 Tolerances: .xx"(x) ± .025"(.63) / .xxx"(xx) ± .010"(.25)  
 Specifications are subject to change without notice.